

School Facilities and Enrollment Planning Study

Bowen, Burr, Mason-Rice, Memorial-Spaulding, Peirce,
Underwood, Ward & Williams, Elementary Schools

March 4, 2024



School Facilities and Enrollment Planning Study

8 Elementary Schools

- The intent of the Study is to collect information/data on space utilization & building conditions to help inform long-range enrollment and facilities planning
- Initially developed for Underwood and Ward, the Study was later expanded to include the 6 remaining elementary schools (Bowen, Burr, Mason-Rice, Memorial-Spaulling, Peirce, Williams)
- The 8 schools together represent the remaining elementary schools that have not yet received major renovation or reconstruction (either through MSBA or self-funded)
- The Study is a snapshot in time and shows current space utilization, which can change over time with fluctuations in enrollment, district-wide programming and instructional programs
- Design enrollment is based on optimal class size, not capacity. Capacity of building is based on space utilization.

School Facilities and Enrollment Planning Study

Space Utilization Take-Aways

- Peirce, Ward & Williams appear to have the most available capacity
- General Classrooms tend to be good sizes, except at Underwood & Ward
- Kindergarten tend to be good sizes, except at Bowen, Mason-Rice & Ward
- Libraries & Kitchens tend to be the more significantly undersized with Music next most
- All Schools have similar shared or missing spaces (breakout, storage, conference & support)
- Gymnasiums tend to be one-station in size
- Mason-Rice's Auditorium is also the Cafeteria, Ward's is also the Gymnasium
- All 8 schools except Burr & Underwood have Auditorium space

School Facilities and Enrollment Planning Study

Building Condition Take-Aways

Most in need of repair:

- **Ward** – lack of elevator, accessibility challenges, age of school, no sprinkler system, one steam boiler is non-functional, building systems at end of life
- **Underwood** – age of school, no sprinkler system, site constraints, accessibility challenges, gymnasium roof condition, building systems at end of life
- **Peirce** – original oil boilers, one is non-functional, no sprinkler system, accessibility challenges & lack of full-use elevator (LULA only), building systems at end of life



School Space Utilization

Bowen, Burr, Mason-Rice, Memorial-Spaulding, Peirce,
Underwood, Ward & Williams, Elementary Schools



Existing Spaces

Bowen – Lower Floor

- General Education Classroom
- General Education Support Spaces
- Special Education
- Music, Arts & Phys Ed
- Media Center/Library
- Dining & Food Service
- Admin & Guidance
- Extended Day
- Cust, Maint, & Toilets
- Circulation, Stair, Lift

- ASP – AFTER SCHOOL PROGRAM
- BCBA – BEHAVIOR ANALYST
- B.O. – BREAK-OUT / SMALL GROUP
- C / CUST – CUSTODIAL
- CAF – CAFETERIA
- CR – CLASSROOM
- ELL – ENGLISH LANGUAGE LEARNER
- K – KINDERGARTEN
- LIT – LITERACY
- MECH/MDF – MECHANICAL/ELECTRICAL
- O / OFF – OFFICE
- OT – OCCUPATIONAL THERAPY
- PSY – PSYCHOLOGIST
- S / STOR – STORAGE
- SEL – SOCIAL-EMOTIONAL LEARNING
- SET – SPECIAL EDUCATION TEACHING
- SPCH – SPEECH & LANGUAGE
- SW / SOC – SOCIAL WORKER
- T – TOILET
- TM – TEAM SPECIALIST

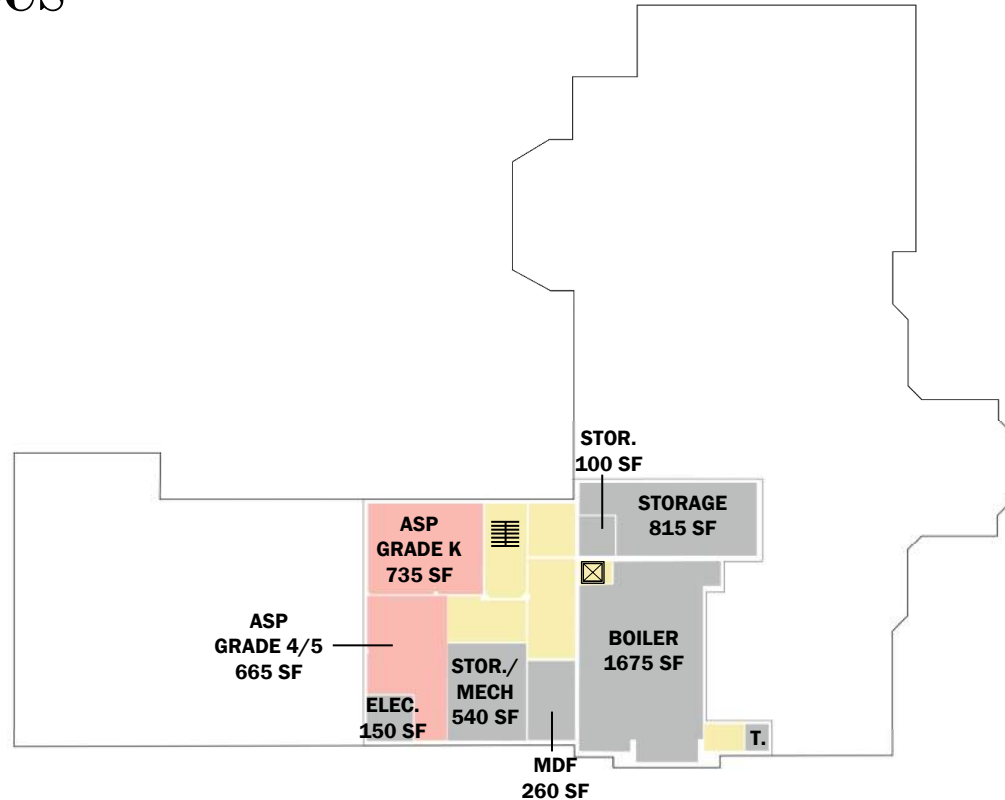

UPPER FLOOR 20,980 GSF
 MAIN FLOOR 29,610 GSF
 MODULARS 3,870 GSF
LOWER FLOOR 6,970 GSF
61,430 GSF

Existing Spaces

Bowen – Main Floor

- General Education Classroom
- General Education Support Spaces
- Special Education
- Music, Arts & Phys Ed
- Media Center/Library
- Dining & Food Service
- Admin & Guidance
- Extended Day
- Cust, Maint, & Toilets
- Circulation, Stair, Lift

- ASP – AFTER SCHOOL PROGRAM
- BCBA – BEHAVIOR ANALYST
- B.O. – BREAK-OUT / SMALL GROUP
- C / CUST – CUSTODIAL
- CAF – CAFETERIA
- CR – CLASSROOM
- ELL – ENGLISH LANGUAGE LEARNER
- K – KINDERGARTEN
- LIT – LITERACY
- MECH/MDF – MECHANICAL/ELECTRICAL
- O / OFF – OFFICE
- OT – OCCUPATIONAL THERAPY
- PSY – PSYCHOLOGIST
- SP.ED.TCH – SPECIAL EDUCATION TEACHING
- SPCH – SPEECH & LANGUAGE
- SW / SOC – SOCIAL WORKER
- T – TOILET
- TM – TEAM SPECIALIST

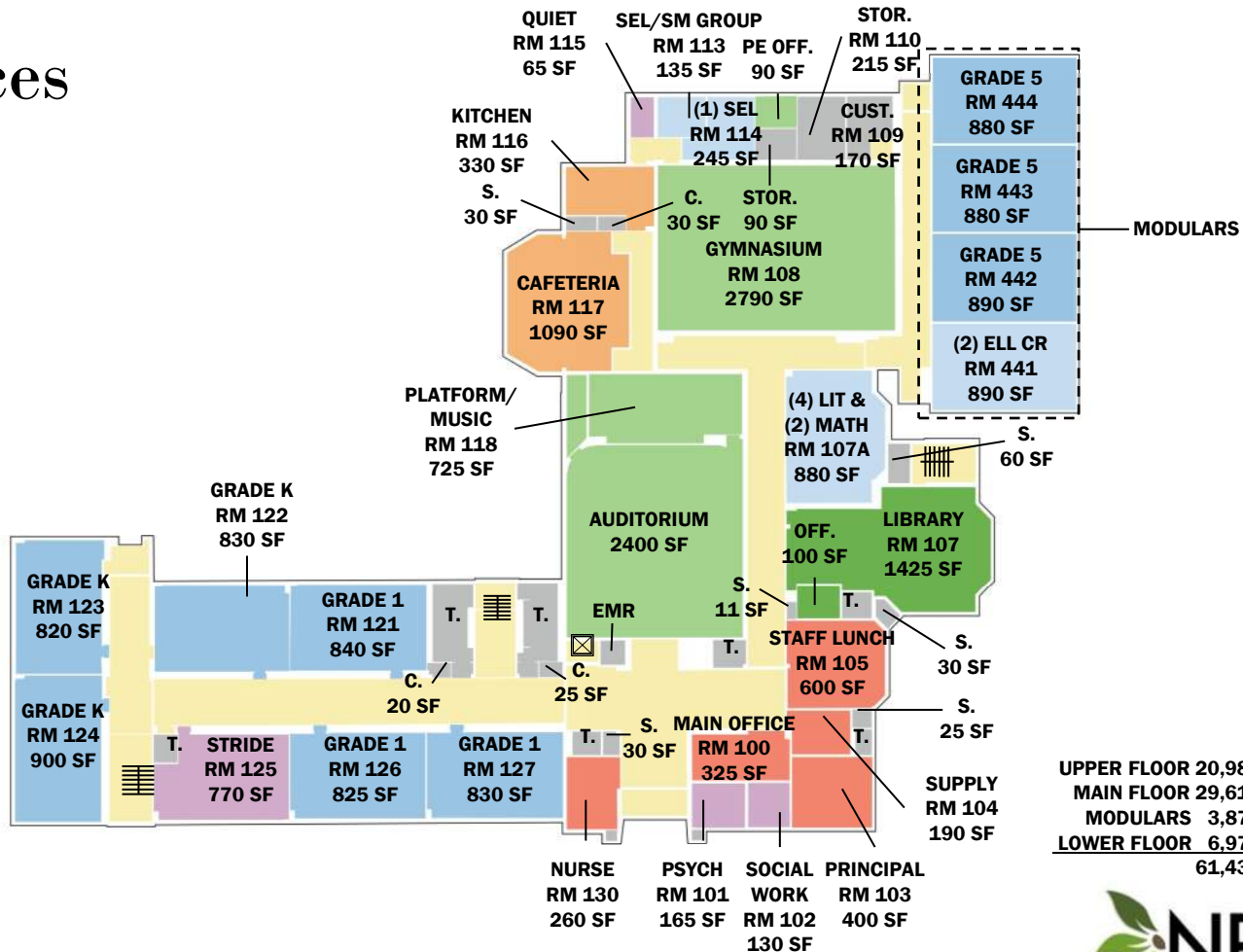

UPPER FLOOR	20,980 GSF
MAIN FLOOR	29,610 GSF
MODULARS	3,870 GSF
LOWER FLOOR	6,970 GSF
TOTAL	61,430 GSF

Existing Spaces

Bowen – Upper Floor

- General Education Classroom
- General Education Support Spaces
- Special Education
- Music, Arts & Phys Ed
- Media Center/Library
- Dining & Food Service
- Admin & Guidance
- Extended Day
- Cust, Maint, & Toilets
- Circulation, Stair, Lift

- ASP – AFTER SCHOOL PROGRAM
- BCBA – BEHAVIOR ANALYST
- B.O. – BREAK-OUT / SMALL GROUP
- C / CUST – CUSTODIAL
- CAF – CAFETERIA
- CR – CLASSROOM
- ELL – ENGLISH LANGUAGE LEARNER
- K – KINDERGARTEN
- LIT – LITERACY
- MECH/MDF – MECHANICAL/ELECTRICAL
- O / OFF – OFFICE
- OT – OCCUPATIONAL THERAPY
- PSY – PSYCHOLOGIST
- S / STOR – STORAGE
- SEL – SOCIAL-EMOTIONAL LEARNING
- SP.ED.TCH – SPECIAL EDUCATION TEACHING
- SPCH – SPEECH & LANGUAGE
- SW / SOC – SOCIAL WORKER
- T – TOILET
- TM – TEAM SPECIALIST

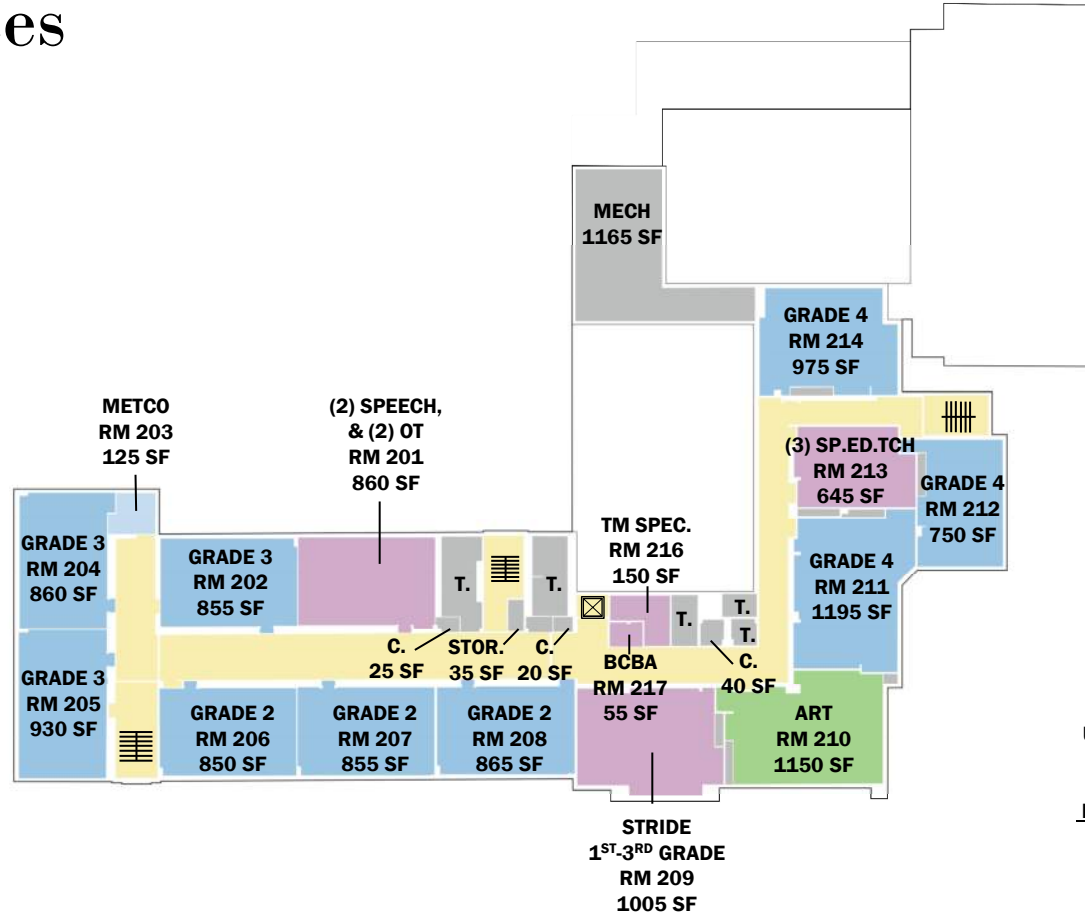

UPPER FLOOR 20,980 GSF
MAIN FLOOR 29,610 GSF
MODULARS 3,870 GSF
LOWER FLOOR 6,970 GSF
61,430 GSF

Educational Space Assessment

Bowen

Core Academic Spaces	Min. Size (sf) Guidelines*	Existing Avg. (sf)	Size (sf) vs Guidelines*	Count of Spaces	FY 2024 Enrollment	Class Size Avg. (stu/s)	Design Enrollment (Seats)**	CR Seat Utilization
Kindergarten	1100	850	77%	3	51	17	66	77.3%
1-2 Classrooms	900	886	98%	6	122	20	132	92.1%
3-5 Classrooms				6	182	20	216	84.4%
3-5 Modularity		3						
Subtotals				18	355		414	85.7%

*Minimum room sizes per NPS Educ-Program **Seats based on class size targets (22 stu/room K-2, 24 stu/room 3-5)

Related Arts Spaces	Min. Size (sf) Guidelines*	Existing Size (sf)	Size (sf) vs Guidelines*	Count of Spaces	Classes/Week	Minutes/Class	Avail. Time Slots/Wk	Functional Utilization
Art	1000	1150	115%	1	18	55	30	60.0%
Music (stage)	1200	725	60%	1	18	30	50	36.0%
Gym Stations	3000	2790	93%	1	36	30	50	72.0%
Media/Library	2533	1525	60%	1	18	35	45	40.0%

*Media/Library size guidelines = 2020sf for enrollments up to 300 students and 4.5sf for each student over 300

Dining & Food Service	Size (sf) Guidelines*	Existing Size (sf)	Adjust (sf)* per Lunches	Count of Spaces	Lunch Periods	Design Enroll.	Enrollment Supported	Functional Utilization
Cafeteria	3105	1090	2070	1	3	414	218	162.8%
			1553	1	4		291	122.1%
			1242	1	5		363	97.7%
			1035	1	6		436	81.4%
Kitchen	1460	330	n/a	1	n/a			

*Cafeteria size guidelines = 15sf per student enrollment divided by lunch periods. Guidelines default to 2 periods

Classroom Size (sf) vs Guidelines

Kindergarten

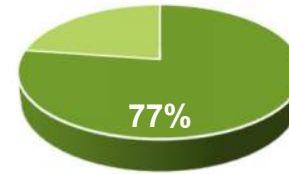

Grade 1-5 Classrooms

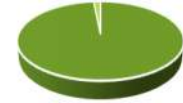

Shared Spaces & Missing Spaces*

vs NPS Educational Program (at 18 Classrooms)

- (6) Lit/Math in 1 Room
- (3) Sp. Educ. in 1 Room
- (2) OT/PT with Speech
- Music Uses the Stage
- Break-Out Space per Grade
- Separate OT/PT Office
- Art Workroom/Storage
- Music Practice

Other Spaces

- +2 District-Wide Sp.Ed CRs
- + Auditorium
- + ASP Specific Rooms

- Gym Office/Storage
- Chair/Table Storage
- Records/Storage Room
- Conference Room
- Nursing (Lactation Room)

Educational Space Assessment

Burr

Core Academic Spaces	Min. Size (sf) Guidelines*	Existing Avg. (sf)	Size (sf) vs Guidelines*	Count of Spaces	FY 2024 Enrollment	Class Size Avg. (stu's)	Design Enrollment (Seats)**	CR Seat Utilization
Kindergarten	1100	1005	91%	1	18	18	22	81.8%
K Modulars		1148	104%	2	36	18	44	81.8%
1-2 Classrooms	900	994	110%	6	120	20	132	91.2%
3-5 Classrooms				9	181	20	216	83.6%
Subtotals				18	355		414	85.7%

*Minimum room sizes per NPS Educ-Program **Seats based on class size targets (22 stu/room K-2, 24 stu/room 3-5)

Related Arts Spaces	Min. Size (sf) Guidelines*	Existing Size (sf)	Size (sf) vs Guidelines*	Count of Spaces	Classes/Week	Minutes/Class	Avail. Time Slots/Wk	Functional Utilization
Art	1000	875	88%	1	18	55	30	60.0%
Music	1200	1025	85%	1	18	30	50	36.0%
Gym Stations	3000	3865	129%	1	36	30	50	72.0%
Media/Library	2533	1240	49%	1	18	35	45	40.0%

*Media/Library size guidelines = 2020sf for enrollments up to 300 students and 4.5sf for each student over 300

Dining & Food Service	Min. Size (sf) Guidelines*	Existing Size (sf)	Adjust (sf)* per Lunches	Count of Spaces	Lunch Periods	Design Enroll.	Enrollment Supported	Functional Utilization
Cafeteria	3105	3685	2070	1	3	414	737	48.2%
			1553	1	4		983	36.1%
			1242	1	5		1228	28.9%
			1035	1	6		1474	24.1%
Kitchen	1460	310	n/a	1	n/a			

*Cafeteria size guidelines = 15sf per student enrollment divided by lunch periods. Guidelines default to 2 periods

Classroom Size (sf) vs Guidelines

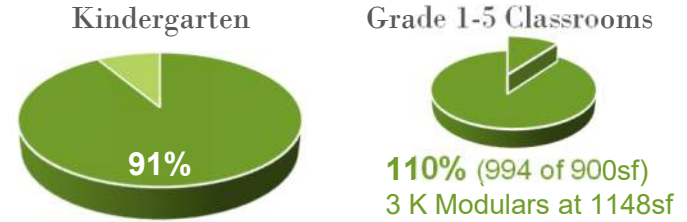

Shared Spaces & Missing Spaces*

vs NPS Educational Program (at 18 Classrooms)

- (5) Lit. in 1 Room
- (5) Special Educ. (1) OT, (2) ELL, SEL & BCBA share 2 Rooms
- Break-Out Space per Grade
- Separate OT/PT Office
- Art Workroom/Storage
- Music Practice

Other Spaces

- + District Storage
- No Auditorium

Educational Space Assessment

Mason-Rice

Core Academic Spaces	Min. Size (sf) Guidelines*	Existing Avg. (sf)	Size (sf) vs Guidelines*	Count of Spaces	FY 2024 Enrollment	Class Size Avg. (stu's)	Design Enrollment (Seats)**	CR Seat Utilization
Kindergarten	1100	882	80%	3	40	13	66	60.6%
1-2 Classrooms	900	906	101%	6	118	20	132	89.1%
3-5 Classrooms			101%	6	176	20	216	81.7%
3-5 Modulars		890	99%	3				
Subtotals				18	334		414	80.7%

*Minimum room sizes per NPS Educ-Program **Seats based on class size targets (22 stu/room K-2, 24 stu/room 3-5)

Related Arts Spaces	Min. Size (sf) Guidelines*	Existing Size (sf)	Size (sf) vs Guidelines*	Count of Spaces	Classes/Week	Minutes/Class	Avail. Time Slots/Wk	Functional Utilization
Art	1000	1195	120%	1	18	55	30	60.0%
Music	1200	980	82%	1	18	30	50	36.0%
Gym Stations	3000	2360	79%	1	36	30	50	72.0%
Media/Library	2533	1200	47%	1	18	35	45	40.0%

*Media/Library size guidelines = 2020sf for enrollments up to 300 students and 4.5sf for each student over 300

Dining & Food Service	Min. Size (sf) Guidelines*	Existing Size (sf)	Adjust (sf)* per Lunches	Count of Spaces	Lunch Periods	Design Enroll.	Enrollment Supported	Functional Utilization
Cafeteria	3105	2260	2070	1	3	414	452	73.9%
			1553	1	4		603	55.4%
			1242	1	5		753	44.3%
			1035	1	6		904	36.9%
Kitchen	1460	425	n/a	1	n/a			

*Cafeteria size guidelines = 15sf per student enrollment divided by lunch periods. Guidelines default to 2 periods

Classroom Size (sf) vs Guidelines

Kindergarten

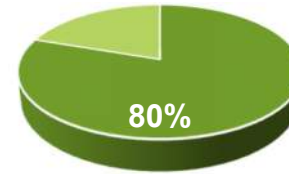

Grade 1-5 Classrooms



Shared Spaces & Missing Spaces*

vs NPS Educational Program (at 18 Classrooms)

- (5) Lit. in 1 Room
- (2) Math in Small Office
- (2) ELL in Small Office
- (5) Sp. Educ & BCBA share 2 Rooms
- OT Shares a Room with Soc Work & (2) Speech
- Break-Out Space per Grade
- Separate OT/PT Office
- Art Workroom/Storage
- Music Practice
- Gym Office/Storage
- Cafeteria (uses gym)
- Chair/Table Storage
- Copy Room (in corridor)
- Conference Room

Other Spaces

- + Auditorium
- + ASP Specific Space

Educational Space Assessment

Memorial-Spaulding

Core Academic Spaces	Min. Size (sf) Guidelines*	Existing Avg. (sf)	Size (sf) vs Guidelines*	Count of Spaces	FY 2024 Enrollment	Class Size Avg. (stu's)	Design Enrollment (Seats)**	CR Seat Utilization
Kindergarten	1100	1137	103%	3	46	15	66	69.7%
1-2 Classrooms	900	862	96%	7	129	18	154	83.9%
3-5 Classrooms			96%	9	194	22	216	89.7%
Subtotals				19	369		436	84.6%

*Minimum room sizes per NPS Educ-Program **Seats based on class size targets (22 stu/room K-2, 24 stu/room 3-5)

Related Arts Spaces	Min. Size (sf) Guidelines*	Existing Size (sf)	Size (sf) vs Guidelines*	Count of Spaces	Classes/Week	Minutes/Class	Avail. Time Slots/Wk	Functional Utilization
Art	1000	1360	136%	1	19	55	30	63.3%
Music (stage)	1200	705	59%	1	19	30	50	38.0%
Gym Stations	3000	2430	81%	1	38	30	50	76.0%
Media/Library	2632	2545	97%	1	19	35	45	42.2%

*Media/Library size guidelines = 2020sf for enrollments up to 300 students and 4.5sf for each student over 300

Dining & Food Service	Min. Size (sf) Guidelines*	Existing Size (sf)	Adjust (sf)* per Lunches	Count of Spaces	Lunch Periods	Design Enroll.	Enrollment Supported	Functional Utilization
Cafeteria	3270	1105	2180	1	3	436	221	167.0%
			1635	1	4		295	125.2%
			1308	1	5		368	100.2%
			1090	1	6		442	83.5%
Kitchen	1460	300	n/a	1	n/a			

*Cafeteria size guidelines = 15sf per student enrollment divided by lunch periods. Guidelines default to 2 periods

Classroom Size (sf) vs Guidelines

Kindergarten

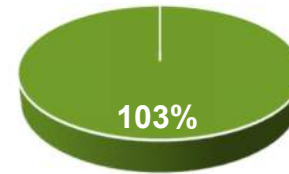

Grade 1-5 Classrooms



Shared Spaces & Missing Spaces*

vs NPS Educational Program (at 18 Classrooms)

- (9) Lit/Math & (2) ELL Share 2 Rooms
- BCBA & SEL in Sp. Ed.
- (2) OT/PT with Speech
- Music Uses the Stage
- Break-Out Space per Grade
- Separate OT/PT Office
- Chair/Table Storage
- Records/Storage Room
- Conference Room
- Nursing (Lactation Room)

Other Spaces

- + Extra Music Room
- + Auditorium
- + ASP Specific Space

Educational Space Assessment

Peirce

Core Academic Spaces	Min. Size (sf) Guidelines*	Existing Avg. (sf)	Size (sf) vs Guidelines*	Count of Spaces	FY 2024 Enrollment	Class Size Avg. (stu's)	Design Enrollment (Seats)**	CR Seat Utilization
Kindergarten	1100	1023	93%	2	36	18	44	81.8%
1-2 Classrooms	900	842	94%	4	80	20	88	90.9%
3-5 Classrooms			94%	5	120	17	168	71.4%
3-5 Modulares		830	92%	2				
Subtotals				13	236		300	78.7%

*Minimum room sizes per NPS Educ-Program **Seats based on class size targets (22 stu/room K-2, 24 stu/room 3-5)

Related Arts Spaces	Min. Size (sf) Guidelines*	Existing Size (sf)	Size (sf) vs Guidelines*	Count of Spaces	Classes/Week	Minutes/Class	Avail. Time Slots/Wk	Functional Utilization
Art	1000	865	87%	1	13	55	30	43.3%
Music (stage)	1200	620	52%	1	13	30	50	26.0%
Gym Stations	3000	2015	67%	1	26	30	50	52.0%
Media/Library	2020	990	49%	1	13	35	45	28.9%

*Media/Library size guidelines = 2020sf for enrollments up to 300 students and 4.5sf for each student over 300

Dining & Food Service	Min. Size (sf) Guidelines*	Existing Size (sf)	Adjust (sf)* per Lunches	Count of Spaces	Lunch Periods	Design Enroll.	Enrollment Supported	Functional Utilization
Cafeteria	2250	648	1500	2	3	300	259	91.1%
			1125	2	4		345	68.3%
			900	2	5		432	54.7%
			750	2	6		518	45.6%
Kitchen	1460	220	n/a	1	n/a			

*Cafeteria size guidelines = 15sf per student enrollment divided by lunch periods. Guidelines default to 2 periods

Classroom Size (sf) vs Guidelines

Kindergarten

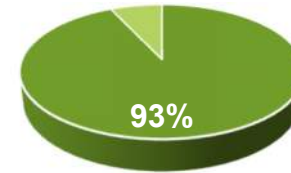

Grade 1-5 Classrooms



Shared Spaces & Missing Spaces*

vs NPS Educational Program (at 18 Classrooms)

- (5) Special Educ, SEL, (2) ELL & (1) Math Share 2 Rooms
- (2) OT with (2) Speech
- Music Uses the Stage
- Break-Out Space per Grade
- Separate OT/PT Office
- Art Workroom/Storage
- Music Practice
- Gym Office/Storage
- Chair/Table Storage
- Copy & Storage (in corridors)
- Conference Room
- Nursing (Lactation Room)

Other Spaces

- + District-Wide Sp.Ed Rms
- + Auditorium

Educational Space Assessment

Underwood

Core Academic Spaces	Min. Size (sf) Guidelines*	Existing Avg. (sf)	Size (sf) vs Guidelines*	Count of Spaces	FY 2024 Enrollment	Class Size Avg. (stu's)	Design Enrollment (Seats)**	CR Seat Utilization
Kindergarten	1100	1110	101%	2	37	19	44	84.1%
1-2 Classrooms	900	665	74%	4	82	21	88	93.2%
3-5 Classrooms			74%	6	123	21	144	85.4%
Subtotals				12	242		276	87.7%

*Minimum room sizes per NPS Educ-Program **Seats based on class size targets (22 stu/room K-2, 24 stu/room 3-5)

Related Arts Spaces	Min. Size (sf) Guidelines*	Existing Size (sf)	Size (sf) vs Guidelines*	Count of Spaces	Classes/Week	Minutes/Class	Avail. Time Slots/Wk	Functional Utilization
Art	1000	720	72%	1	12	55	30	40.0%
Music	1200	695	58%	1	12	30	50	24.0%
Gym Stations	3000	3025	101%	1	24	30	50	48.0%
Media/Library	2020	1570	78%	1	12	35	45	26.7%

*Media/Library size guidelines = 2020sf for enrollments up to 300 students and 4.5sf for each student over 300

Dining & Food Service	Min. Size (sf) Guidelines*	Existing Size (sf)	Adjust (sf)* per Lunches	Count of Spaces	Lunch Periods	Design Enroll.	Enrollment Supported	Functional Utilization
Cafeteria	2070	1555	1380	1	3	276	311	77.8%
			1035	1	4		415	58.4%
			828	1	5		518	46.7%
			690	1	6		622	38.9%
Kitchen	1460	290	n/a	1	n/a			

*Cafeteria size guidelines = 15sf per student enrollment divided by lunch periods. Guidelines default to 2 periods

*Kitchen size guidelines = 1600sf for enrollments up to 300 students +1sf for each over 300. NPS standard = 1460sf

Classroom Size (sf) vs Guidelines

Kindergarten

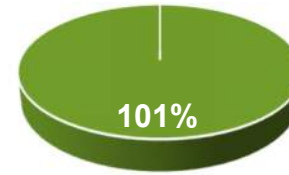

Grade 1-5 Classrooms



Shared Spaces & Missing Spaces*

vs NPS Educational Program (at 18 Classrooms)

- Special Educ, SEL, BCBA & Social Work Share 2 Rooms
- ELL/Math in 1 Room
- OT/PT/Speech in 1 Room
- Break-Out Space per Grade
- Separate OT/PT Office
- Chair/Table Storage
- Records & Storage Rooms
- Nursing (Lactation Room)

Other Spaces

+ ASP Specific Room

-- No Auditorium/Stage

Educational Space Assessment

Ward

Core Academic Spaces	Min. Size (sf) Guidelines*	Existing Avg. (sf)	Size (sf) vs Guidelines*	Count of Spaces	FY 2024 Enrollment	Class Size Avg. (stu's)	Design Enrollment (Seats)**	CR Seat Utilization
Kindergarten	1100	870	79%	2	42	21	44	95.5%
1-2 Classrooms	900	699	78%	4	68	17	88	77.3%
3-5 Classrooms			78%	6	102	17	144	70.8%
Subtotals				12	212		276	76.8%

*Minimum room sizes per NPS Educ-Program **Seats based on class size targets (22 stu/room K-2, 24 stu/room 3-5)

Related Arts Spaces	Min. Size (sf) Guidelines*	Existing Size (sf)	Size (sf) vs Guidelines*	Count of Spaces	Classes/Week	Minutes/Class	Avail. Time Slots/Wk	Functional Utilization
Art	1000	740	74%	1	12	55	30	40.0%
Music	1200	765	64%	1	12	30	50	24.0%
Gym Stations	3000	2520	84%	1	24	30	50	48.0%
Media/Library	2020	1645	81%	1	12	35	45	26.7%

*Media/Library size guidelines = 2020sf for enrollments up to 300 students and 4.5sf for each student over 300

Dining & Food Service	Min. Size (sf) Guidelines*	Existing Size (sf)	Adjust (sf)* per Lunches	Count of Spaces	Lunch Periods	Design Enroll.	Enrollment Supported	Functional Utilization
Cafeteria	2070	1285	1380	1	3	276	257	82.5%
			1035	1	4		343	61.9%
			828	1	5		428	49.5%
			690	1	6		514	41.2%
Kitchen	1460	300	n/a	1	n/a			

*Cafeteria size guidelines = 15sf per student enrollment divided by lunch periods. Guidelines default to 2 periods

*Kitchen size guidelines = 1600sf for enrollments up to 300 students +1sf for each over 300. NPS standard = 1460sf

Classroom Size (sf) vs Guidelines

Kindergarten

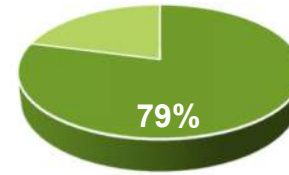

Grade 1-5 Classrooms



Shared Spaces & Missing Spaces*

vs NPS Educational Program (at 18 Classrooms)

- Lit/Math/SEL & BCBA Share 2 Rooms
- Sp. Educ. Teaching
- Speech & Language
- Break-Out Space per Grade
- Separate OT/PT Office
- Art Workroom/Storage
- Chair/Table Storage
- Records Room
- Conference Room

Other Spaces

- + ASP Specific Room
- No Auditorium

Educational Space Assessment

Williams

Core Academic Spaces	Min. Size (sf) Guidelines*	Existing Avg. (sf)	Size (sf) vs Guidelines*	Count of Spaces	FY 2024 Enrollment	Class Size Avg. (stu's)	Design Enrollment (Seats)**	CR Seat Utilization
Kindergarten	1100	1173	107%	2	26	13	44	59.1%
1-2 Classrooms	900	840	93%	4	76	19	88	85.9%
3-5 Classrooms			93%	6	113	19	144	78.8%
Subtotals				12	215		276	77.9%

*Minimum room sizes per NPS Educ-Program **Seats based on class size targets (22 stu/room K-2, 24 stu/room 3-5)

Related Arts Spaces	Min. Size (sf) Guidelines*	Existing Size (sf)	Size (sf) vs Guidelines*	Count of Spaces	Classes/Week	Minutes/Class	Avail. Time Slots/Wk	Functional Utilization
Art	1000	1020	102%	1	12	55	30	40.0%
Music (stage)	1200	610	51%	1	12	30	50	24.0%
Gym Stations	3000	2885	96%	1	24	30	50	48.0%
Media/Library	2020	1800	89%	1	12	35	45	26.7%

*Media/Library size guidelines = 2020sf for enrollments up to 300 students and 4.5sf for each student over 300

Dining & Food Service	Min. Size (sf) Guidelines*	Existing Size (sf)	Adjust (sf)* per Lunches	Count of Spaces	Lunch Periods	Design Enroll.	Enrollment Supported	Functional Utilization
Cafeteria	2070	1025	1380	1	3	276	205	104.9%
			1035	1	4		273	78.7%
			828	1	5		342	62.9%
			690	1	6		410	52.4%
Kitchen	1460	355	n/a	1	n/a			

*Cafeteria size guidelines = 15sf per student enrollment divided by lunch periods. Guidelines default to 2 periods

Classroom Size (sf) vs Guidelines

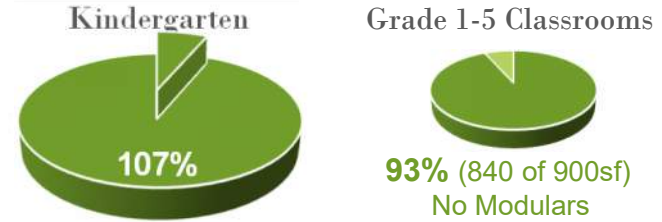

Shared Spaces & Missing Spaces*

vs NPS Educational Program (at 18 Classrooms)

- (6) Lit/Math in 1 Room
- (2) ELL in 1 Room
- Tm Specialist in Sp. Ed
- (2) OT with (3) Speech
- Metco/Soc-Work Share
- Music Uses the Stage
- Break-Out Space per Grade
- Separate OT/PT Office
- Art Workroom/Storage
- Music Practice
- Gym Office within Storage
- Chair/Table Storage
- Copy Room (in corridors)
- Conference Room
- Nursing (Lactation Room)

Other Spaces

- + District-Wide Sp.Ed. CR
- + Auditorium
- + ASP Specific Room

Existing Spaces vs Educational-Program

NEWTON PUBLIC SCHOOLS				BOWEN				BURR				MASON-RICE				MEMORIAL-SPAULDING				PEIRCE				UNDERWOOD				WARD				WILLIAMS				NPS EDUCATIONAL PROGRAM (14 CRs = 306-322 Students)				NPS EDUCATIONAL PROGRAM (18 CRs = 396-414 Students)			
ROOM TYPE	ROOM NFA ¹	# OF ROOMS	AREA TOTALS	ROOM NFA ¹	# OF ROOMS	AREA TOTALS	ROOM NFA ¹	# OF ROOMS	AREA TOTALS	ROOM NFA ¹	# OF ROOMS	AREA TOTALS	ROOM NFA ¹	# OF ROOMS	AREA TOTALS	ROOM NFA ¹	# OF ROOMS	AREA TOTALS	ROOM NFA ¹	# OF ROOMS	AREA TOTALS	ROOM NFA ¹	# OF ROOMS	AREA TOTALS	ROOM NFA ¹	# OF ROOMS	AREA TOTALS	ROOM NFA ¹	# OF ROOMS	AREA TOTALS	ROOM NFA ¹	# OF ROOMS	AREA TOTALS										
CORE ACADEMIC		18	17,690		18	18,730		18	17,478		19	18,955		13	11,558		12	10,630		12	9,970		12	11,420		14	14,725		18	18,925													
Kindergarten Classroom	850	3	2,550	1,005	1	1,005	882	3	2,645	1,137	3	3,410	1,023	2	2,045	1,110	2	2,220	870	2	1,740	1,173	2	2,345	1,100	3	3,300	1,100	4	4,400													
<i>Modular Kindergarten Classrooms</i>				1,148	2	2,295			0			0			0			0																									
General Classroom (Grades 1-6)	886	12	10,630	994	15	14,915	906	12	10,870	862	16	13,795	842	9	7,580	865	10	6,650	899	10	6,985	840	10	8,395	900	11	9,900	900	14	12,600													
<i>Modular General Classrooms</i>				883	3	2,650			2,810			0			3,680			0																									
Science/Teche/Engineering (STE) Room (Gr 3-6)			0			0			0			0			0			0																									
STE Storage Room (if applicable)			0			0			0			0			0			0																									
ELL (in modular at Bowen)	890	1	890				90	1	90	920	1	920				665	1	665				295	1	295	300	1	300	300	1	300													
Literacy Center / Books	880	1	880	335	1	335	875	1	875	830	1	830	270	1	270	410	1	410	775	1	775	375	1	375	900	1	900	900	1	900													
Literacy Specialist			0				235	1	235							665			270	1	270				175	1	175	175	1	175													
Math Coach			0			0	85	1	85																150	1	150	150	1	150													
SPECIAL EDUCATION			3,845			3,185			2,795			4,940			3,920			1,420			1,735			2,390			3,650			3,850													
Special Education Teaching	645	1	645	940	1	940	925	2	1,850	1,023	2	2,045	840	1	840	635	1	635				590	1	590	225	4	900	225	4	900													
			0	315	1	315			0	340	1	340	320	1	320	200	1	200				190	1	190			0		0														
Break-Out/Small Group			0	300	1	300	65	1	65	305	2	610										100	1	100	125	6	750	125	6	750													
OT/PT			0				435	1	435				110	1	110	200	1	200	890	1	890				425	1	425	425	1	425													
OT/PT Office			0			0	120	1	120				50	2	100	65	2	130				80	1	60	175	1	175	175	1	175													
Quiet	65	1	65	50	1	50	185	1	185	75	1	75										235	1	235	250	1	250	250	1	250													
Speech and Language	860	1	860	50	2	100																			400	1	400	400	1	400													
Teams Specialist + HP Conference	150	1	150	90	1	90	60	1	60	225	1	225	100	1	100	215	1	215							155	1	155	150	1	150													
Psychologic (not testing/storage)	165	1	165	170	1	170	135	1	135	870	1	870	175	1	175	105	1	105	85	1	85																						
Psych - Play to Learn			0			0	120	1	120			0			0			0																									
Social Worker	130	1	130	170	1	170				360	1	360													160	1	160	160	1	160													
Behavioral / BCBA	55	1	55			0																																					
Bridge Program Classroom (K-2 & 3-5)			0			0							640	2	1,280																												
Bridge Program Storage			0			0			0			95	1	95																													
Reflections Program (K-2)			0			0			0			0			0																												
STRIDE Program (K & 1-3)	888	2	1,775			0			0			0			0																												
ART & MUSIC			1,150			1,900			2,175			2,235			865			2,150			1,640			1,030			2,500			2,500													
Art Classroom (25 seats)	1,150	1	1,150	875	1	875	1,195	1	1,195	1,360	1	1,360	865	1	865	720	1	720	740	1	740	1,020	1	1,020	1,000	1	1,000	1,000	1	1,000													
Art Workroom with Storage and Kin			0			0			0	93	2	187				710	1	710	36	1	36				150	1	150	150	1	150													
Music Classroom (modular at Mason-Rice)			0			0			0			0			0			695	1	695	765	1	765																				
Music Practice / Ensemble			0			0			0	690	1	690				125	1	125								75	2	150	75	2	150												
HEALTH & PHYSICAL EDUCATION			2,970			4,419			2,370			2,815			2,015			3,615			2,890			3,230			6,300			6,300													
Gymnasium	2,790	1	2,790	3,865	1	3,865	2,360	1	2,360	2,430	1	2,430	2,015	1	2,015	3,025	1	3,025	2,520	1	2,520	2,885	1	2,885	6,000	1	6,000	6,000	1	6,000													
Gym Storage	90	1	90	375	1	375	10	1	10	325	1	325				415	1	415	105	2	210	345	1	345	200	1	200	200	1	200													
Health Instructor's Office with Shower and Toilet	90	1	90	170	1	170			0	60	1	60			0	175	1	175	160	1	160				100	1	100	100	1	100													
MEDIA CENTER / LIBRARY			1,525			1,240			1,200			2,345			990			1,570			1,645			1,800			2,047			2,451													
Media Center / Reading Room	1,525	1	1,525	1,240	1	1,240	1,200	1	1,200	2,345	1	2,345	990	1	990	1,570	1	1,570	1,645	1	1,645	1,800	1	1,800	2,047	1	2,047	2,451	1	2,451													

*Red text indicates spaces that are in modulators and dashed lines indicate some of the space utilization take-aways



Existing Spaces vs Educational-Program

NEWTON PUBLIC SCHOOLS	BOWEN	BURR	MASON-RICE	MEMORIAL-SPAULDING	PEIRCE	UNDERWOOD	WARD	WILLIAMS	NPS EDUCATIONAL PROGRAM (14 CRs = 306-322 Students)	NPS EDUCATIONAL PROGRAM (18 CRs = 396-414 Students)									
ROOM TYPE	ROOM NFA ¹	# OF ROOMS	AREA TOTALS	ROOM NFA ¹	# OF ROOMS	AREA TOTALS	ROOM NFA ¹	# OF ROOMS	AREA TOTALS	ROOM NFA ¹	# OF ROOMS	AREA TOTALS	ROOM NFA ¹	# OF ROOMS	AREA TOTALS				
DINING & FOOD SERVICE			2,029			4,945			1,625			5,287			5,943				
Cafeteria / Dining	1,090	1	1,090	3,685	1	3,685			1,025	1	1,025	2,295	1	2,295	2,970	1	2,970		
Stage			within Auditorium			uses auditorium	1,105	1	1,105	648	2	1,295	1,555	1	1,555	1,285	1	1,285	
Chair / Table / Equipment Storage			within Auditorium			within Auditorium			within Auditorium			within Auditorium			within Auditorium			within Auditorium	
Kitchen	330	1	330	310	1	310	425	1	425	300	1	300	220	1	220	290	1	290	
Staff Lunch Room	600	1	600	300	1	300	630	1	630	300	1	300	250	1	250	250	1	250	
MEDICAL			300			165			200			350			100			430	
Medical Suite / Toilet	40	1	40	0	0	0	0	0	0	25	1	25	0	0	0	0	0	0	
Nurses' Office / Waiting Room	260	1	260	165	1	165	200	1	200	130	1	130	310	1	310	350	1	350	
Examination Room / Resting	0	0	0	0	0	0	0	0	0	145	1	145	100	1	100	60	1	60	
ADMINISTRATION & GUIDANCE			1,420			1,370			540			610			1,725			2,080	
General Office / Waiting Room with Toilet	325	1	325	510	1	510	285	1	285	260	1	260	220	1	220	485	1	485	
Teachers' Mail and Time Room	0	0	0	0	0	0	0	0	190	1	190	125	1	125	120	1	120	380	
Copy Room	190	1	190	0	0	0	in Corridors	50	1	50	0	0	in Corridors	0	0	0	0	120	
Records Room	0	0	0	0	0	0	in Corridors	300	1	300	200	1	200	in Corridors	0	0	0	310	
Principal's Office with Conference Area	400	1	400	350	1	350	150	2	300	0	0	0	in Corridors	0	0	0	0	310	
Principal's Secretary / Waiting	0	0	0	0	0	0	0	0	0	200	1	200	215	1	215	280	1	280	
Assistant Principal's Office	0	0	0	0	0	0	0	0	0	0	0	0	0	0	0	0	0	370	
Supervisory / Spare Office (ASP)	0	0	0	0	0	0	0	0	0	0	0	0	0	0	0	0	0	0	
Conference Room	235	2	510	0	0	0	0	0	0	160	1	160	0	0	0	0	0	0	
Guidance Office	0	0	0	0	0	0	0	0	0	0	0	0	0	0	0	0	0	0	
Guidance Storeroom	0	0	0	0	0	0	0	0	0	0	0	0	0	0	0	0	0	0	
Teachers' Work Room	0	0	0	0	0	0	0	0	0	0	0	0	0	0	0	0	0	0	
METCO	125	1	125				(1) within SEL			100	1	100	35	1	35	35	1	35	
SEL Coach / Intervention (can share space)	190	2	380	(3) within Learning Center			690	1	690	within Social Worker			within staff lunch					200	
Wellness / Nursing Room	0	0	0	175	1	175	0	0	0	within Learning Center			635	1	635	935	1	935	
CUSTODIAL & MAINTENANCE			2,443			2,849			1,750			1,830			2,625			1,750	
Custodian's Office	170	1	170	165	1	165	145	1	145	205	1	205	135	1	135	0	0	100	
Custodian's Workshop	0	0	0	0	0	0	0	0	0	0	0	0	0	0	0	0	0	100	
Custodian's Storage	27	6	360	30	2	60	65	2	130	57	5	285	90	1	90	174	7	1,220	
Recycling Room / Trash	0	0	0	0	0	0	0	0	0	0	0	0	0	0	0	0	0	147	
Receiving and General Supply Storeroom	0	0	0	0	0	0	0	0	0	0	0	0	0	0	0	0	0	7	
Network / Telecom Room	260	1	260	400	1	400	80	1	80	80	1	80	within Mail Room	0	0	0	0	0	
Misc. Storage Rooms	206	9	1,850	403	6	2,420	64	4	255	598	5	2,950	0	0	0	0	0	174	
OTHER			4,325			2,155			4,095			3,720			2,820			801	
Auditorium	2,400	1	2,400	no auditorium			2,240	1	2,240	2,015	1	2,015	1,955	1	1,955	no auditorium			650
Stage	725	1	725	0	0	0	355	1	355	705	1	705	620	1	620	uses gymnasium			650
After School Program (ASP)/Office	700	2	1,400	705	1	1,410	1,480	1	1,480	670	1	670	110	1	110	625	1	625	625
ASP Storage	0	0	0	0	0	0	0	0	0	130	1	130	135	1	135	0	0	0	
Assoc. Dir. of Elem. Educ.	0	0	0	0	0	0	0	0	0	200	1	200	0	0	0	0	0	0	
Sp. Educ. Asst. Director	0	0	0	0	0	0	0	0	0	0	0	0	105	1	105	0	0	0	
District Storage	0	0	0	1,025	2	2,050	0	0	0	0	0	0	0	0	0	0	0	0	
TOTALS			37,795			39,085			33,610			41,395			24,045			25,360	
Enrollment	355		355	369		369	314		236		242	212		212	215		215		
Total Building Gross Floor Area (GFA) ²	61,430		61,430	53,040		53,040	64,475		38,110		41,000	44,200		44,200	44,980		44,980		
Grossing Factor (GFA / NFA)	1.63		1.63	1.38		1.38	1.56		1.58		1.62	1.83		1.83	1.53		1.53		

*Red text indicates spaces that are in modulars and dashed lines indicate some of the space utilization take-aways

Building Conditions

Bowen, Burr, Mason-Rice, Memorial-Spaulding, Peirce,
Underwood, Ward & Williams, Elementary Schools



Building Age & Additions



Bowen

1950

1998
Addition

2013
Modulars



Burr

1966

2011
Modulars

2013
Modulars



Mason Rice

1957

2013
Modulars



Memorial
Spaulding

1952

1959
Addition

2002
Add/Renovation



Peirce

1954

1955
Addition

2007
Modulars



Underwood

1924

1978
Add/Renovation



Ward

1928

1949
Addition

1956
Addition



Williams

1949

2000
Addition

Site Size



Bowen

11.5 acres



Burr

8.6 acres



Mason Rice

4 acres



**Memorial
Spaulding**

5.6 acres



Peirce

**4.9 acres
(incl parking)**



Underwood

1 acre



Ward

3 acres



Williams

**3.1 acres
(incl baseball)**

Site Topography (At Building)

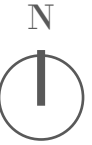

Bowen

11.5 acres

2-4ft

Grade change
(20ft hill behind school)



Burr

8.6 acres

10-15ft

Grade change



Mason Rice

4 acres

15ft

Grade change



Memorial Spaulding

5.6 acres

8-10ft

Grade change



Peirce

4.9 acres
(incl parking)

7-10ft

Grade change



Underwood

1 acre

2ft

Grade change



Ward

3 acres

15-20ft

Grade change



Williams

3.1 acres
(incl baseball)

2ft

Grade change

Some sites feature larger grade changes outside of the building footprint across the entirety of the property but may have more favorable flatter topographic contours in select areas of the parcel.

Site Regulations

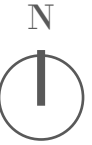

Bowen

11.5 acres

2-4ft

Grade change
(20ft hill behind
school)



Burr

8.6 acres

10-15ft

Grade change



Mason Rice

4 acres

15ft

Grade change

RPA*, Wetland
Buffer, ROW**,
Easements



**Memorial
Spaulding**

5.6 acres

8-10ft

Grade change

Easements



Peirce

4.9 acres
(incl parking)

7-10ft

Grade change



Underwood

1 acre

2ft

Grade change

Farlow &
Kenrick Parks
Historic District



Ward

3 acres

15-20ft

Grade change

Easements,
ROW**



Williams

3.1 acres
(incl baseball)

2ft

Grade change

Auburndale Local
Historic District,
Scenic Roads

Peirce Elementary

Site Context & Access

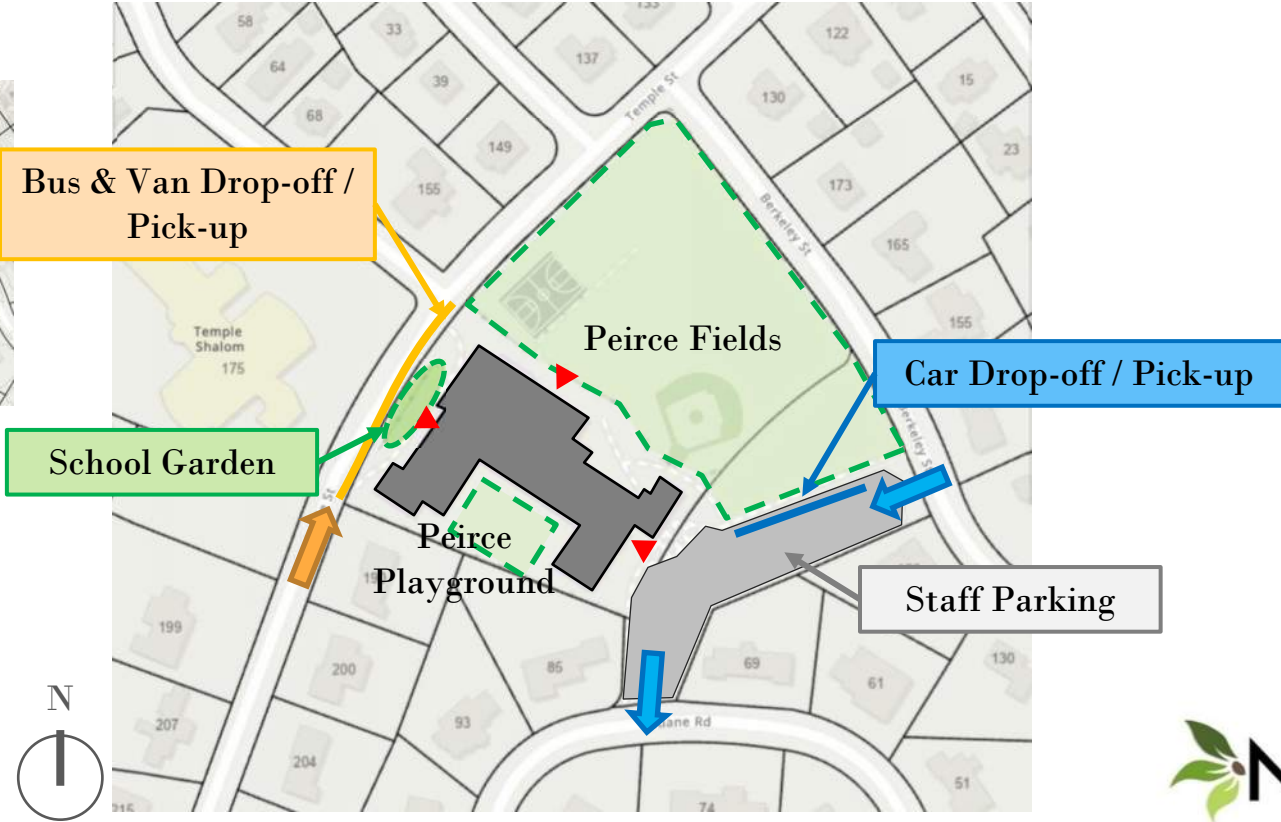
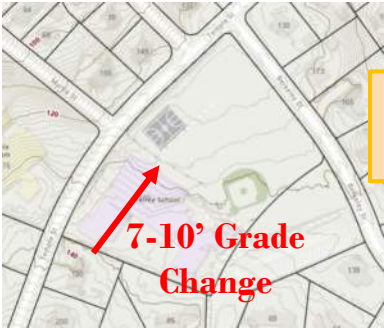

Peirce Elementary

Site Conditions

- Most entrances/access points are not accessible. (only rear entrance ramp, custodial entrance with limited-use, limited application (LULA) stair lift).
- Playgrounds are not accessible with raised edging, no sidewalk to access playgrounds, other sidewalks need replacement.
- Ponding observed at baseball field.
- Service driveway needs repaving.
- Site slopes make accessible routes a challenge at certain paths and sidewalks.
- Car drop-off / pick-up is off street at the parking lot, bus & vans are on street.



Peirce Elementary Building Conditions

- 2 boilers are original to the school, one is non-functional, no electrification of system. The functional boiler is the last remaining oil boiler in the district. Neither meets City of Newton's electrification / decarbonization goals.
- No sprinkler system, HVAC system is at end of life.
- No elevator, only LULA lift from main to lower level, stair lift for lower level access from exterior.
- Floor has been patched over the years.
- Ceilings updated in most, but not all classrooms with new lighting fixtures and lighting control.
- Cold-applied roof with ballast has cultivated moss growth near tree line.
- 2006 windows are in good condition, but nearing end of life and would not meet current energy codes.

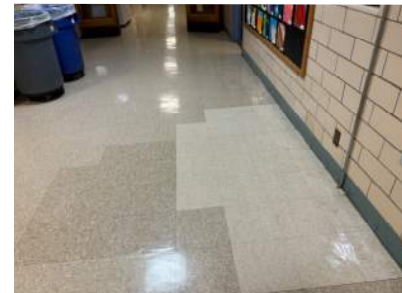
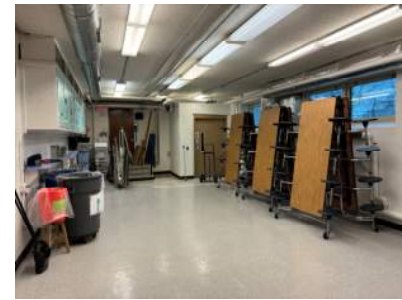

Base Repair Costs

Context

- Total repair costs are a product of the unique conditions of each facility and the size of each facility.
- A smaller building like Peirce may have a lower capital repair total than Memorial-Spaulling, but Memorial-Spaulling is almost twice as large as Peirce and, therefore, requires significantly more investment for the same impact of updating building systems.
- Costs for Underwood and Ward are based on 2023 cost estimate provided by Perkins Eastman's cost estimator consultant. These estimates include more detailed breakdowns of direct cost associated with structural changes required to update both buildings. (ie. costs to alter structure, fill in floors, are included under accessibility)
- Costs for the remaining 6 schools are estimates provided by Newton Public Buildings (NPB) 2023 internal facility assessments for long-term capital improvement initiatives.
- Scope of work does not include costs to change program or alter space sizes to meet the educational program.

Peirce Elementary

Est. Repair Cost by System/Category

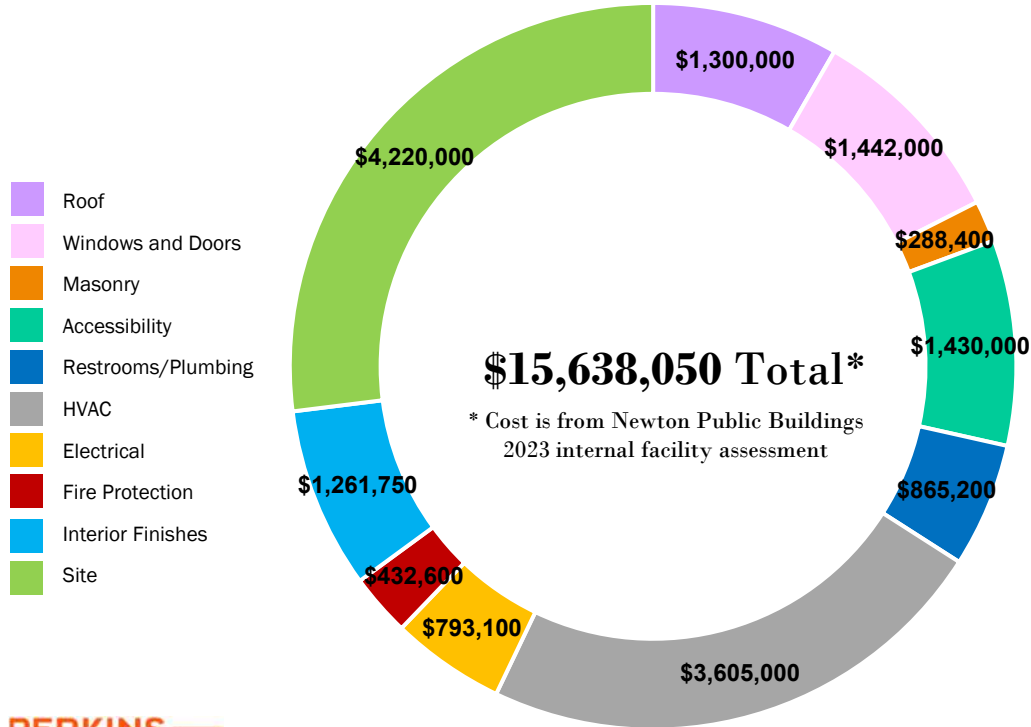

This scope of work and corresponding cost address only building systems and site improvements.

It does not address the lack of program space, appropriately sized spaces, and adjacencies that exist today and that are commonly provided in 21st schools.

Building Condition Assessment

Est. Total Repair Cost & Cost/Sq Ft

Total Repair Cost for Each School

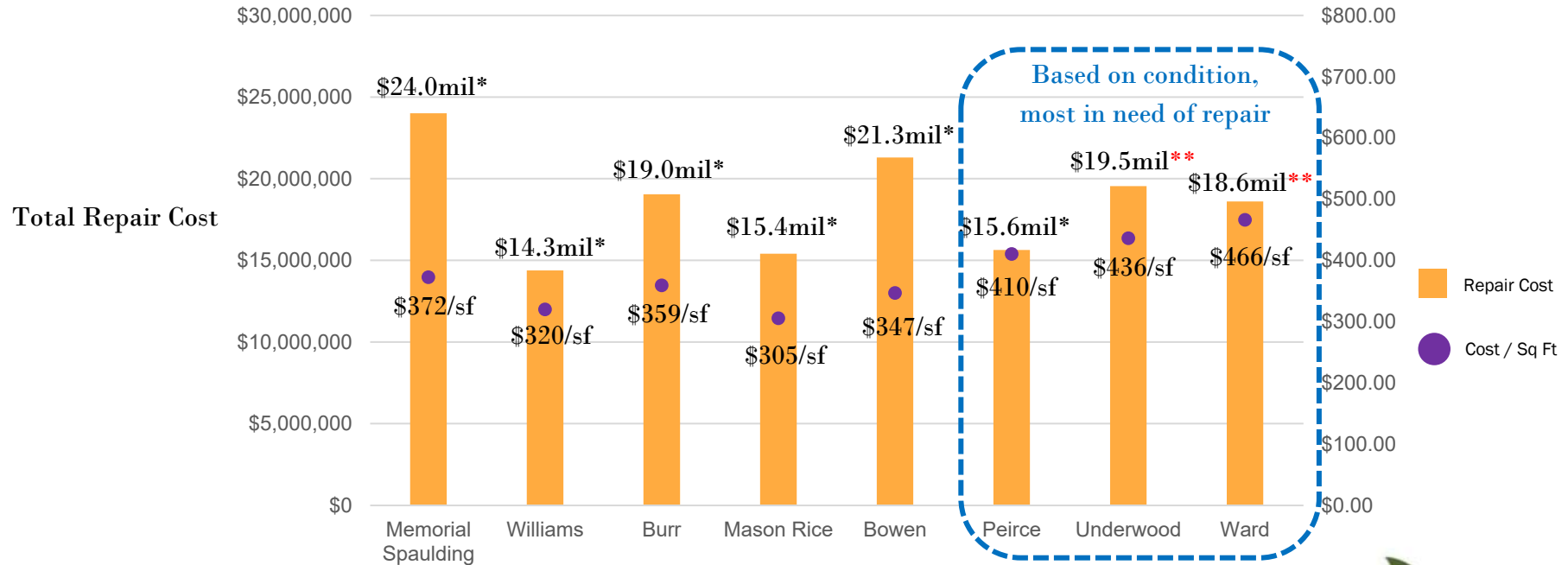

* Cost estimate is from Newton Public Buildings 2023 internal facility assessment

** Cost estimate is from Perkins Eastman's cost estimator

Building Condition Assessment

Est. Repair Cost By Building System/Category

Repair Cost By System/Category for Each School

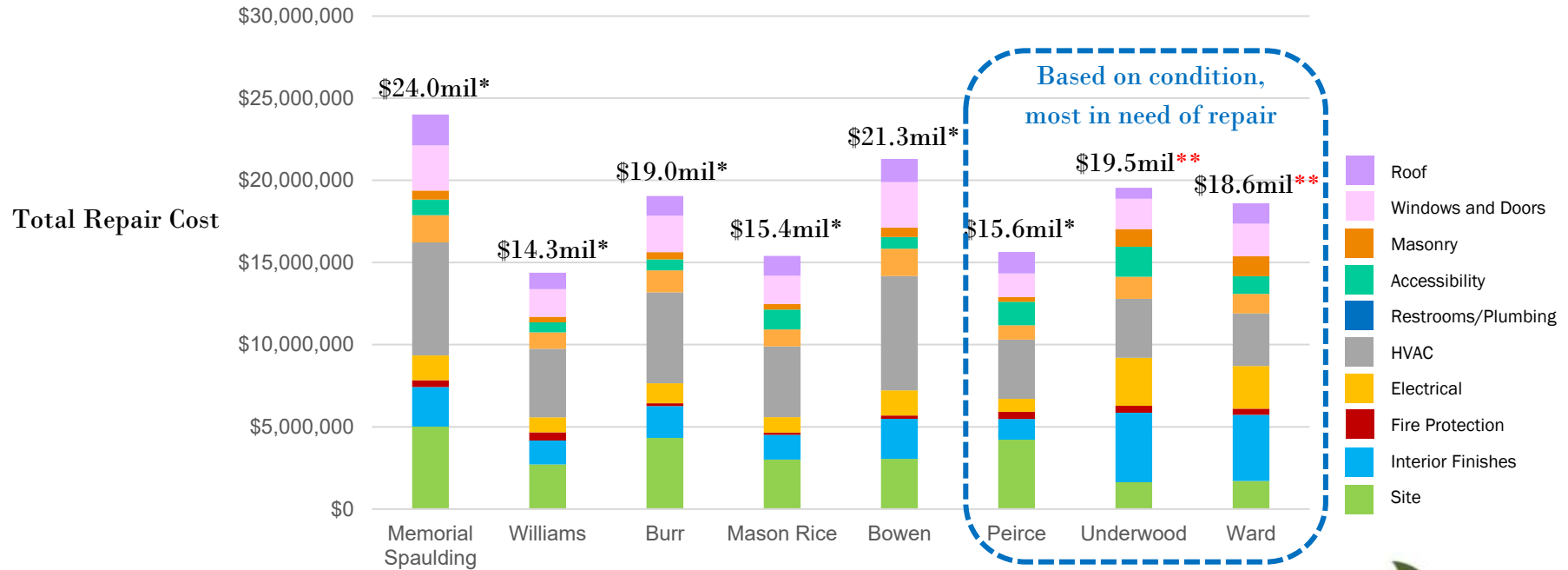

* Cost estimate is from Newton Public Buildings 2023 internal facility assessment

** Cost estimate is from Perkins Eastman's cost estimator

Appendix – Existing Floor Plans & Space Summaries



Existing Spaces

Burr – Main Floor

- General Education Classroom
- General Education Support Spaces
- Special Education
- Music, Arts & Phys Ed
- Media Center/Library
- Dining & Food Service
- Admin & Guidance
- Extended Day
- Cust, Maint, & Toilets
- Circulation, Stair, Lift

- ASP – AFTER SCHOOL PROGRAM
- BCBA – BEHAVIOR ANALYST
- B.O. – BREAK-OUT / SMALL GROUP
- C / CUST – CUSTODIAL
- CAF – CAFETERIA
- CR – CLASSROOM
- ELL – ENGLISH LANGUAGE LEARNER
- K – KINDERGARTEN
- LIT – LITERACY
- MECH/MDF – MECHANICAL/ELECTRICAL
- O / OFF – OFFICE
- OT – OCCUPATIONAL THERAPY
- PSY – PSYCHOLOGIST
- SEL – SOCIAL-EMOTIONAL LEARNING
- SP.ED.TCH – SPECIAL EDUCATION TEACHING
- SPCH – SPEECH & LANGUAGE
- SW / SOC – SOCIAL WORKER
- T – TOILET
- TM – TEAM SPECIALIST

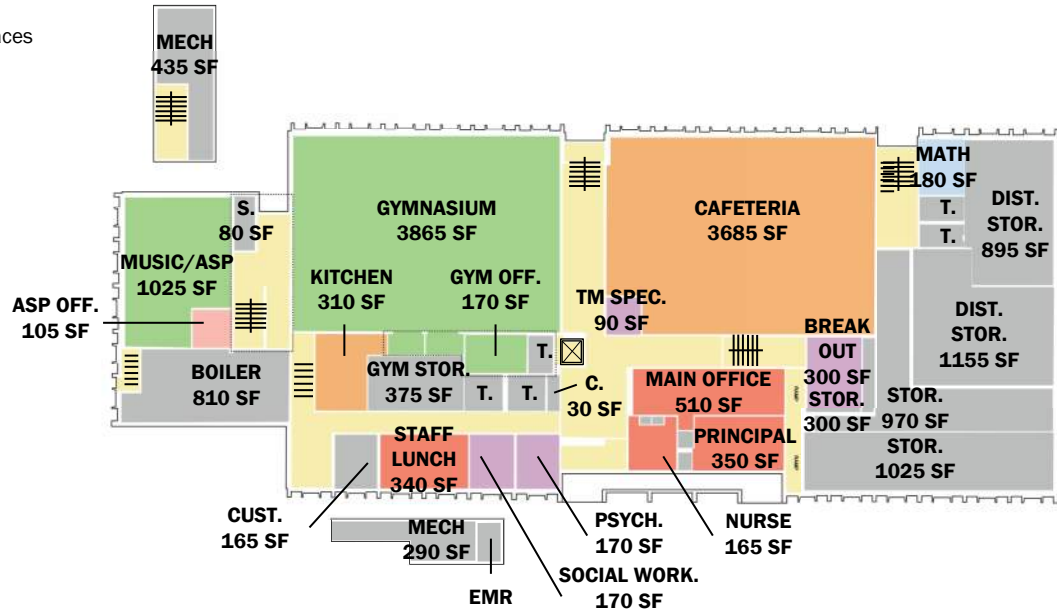

MAIN FLOOR 27,265 GSF
MODULARS 2,475 GSF
UPPER FLOOR 23,320 GSF
53,060 GSF

Existing Spaces

Burr – Upper Floor

- General Education Classroom
- General Education Support Spaces
- Special Education
- Music, Arts & Phys Ed
- Media Center/Library
- Dining & Food Service
- Admin & Guidance
- Extended Day
- Cust, Maint, & Toilets
- Circulation, Stair, Lift

- ASP – AFTER SCHOOL PROGRAM
- BCBA – BEHAVIOR ANALYST
- B.O. – BREAK-OUT / SMALL GROUP
- C / CUST – CUSTODIAL
- CAF – CAFETERIA
- CR – CLASSROOM
- ELL – ENGLISH LANGUAGE LEARNER
- K – KINDERGARTEN
- LIT – LITERACY
- MECH/MDF – MECHANICAL/ELECTRICAL
- O / OFF – OFFICE
- OT – OCCUPATIONAL THERAPY
- PSY – PSYCHOLOGIST
- S / STOR – STORAGE
- SEL – SOCIAL-EMOTIONAL LEARNING
- SP.ED.TCH – SPECIAL EDUCATION TEACHING
- SPCH – SPEECH & LANGUAGE
- SW / SOC – SOCIAL WORKER
- T – TOILET
- TM – TEAM SPECIALIST

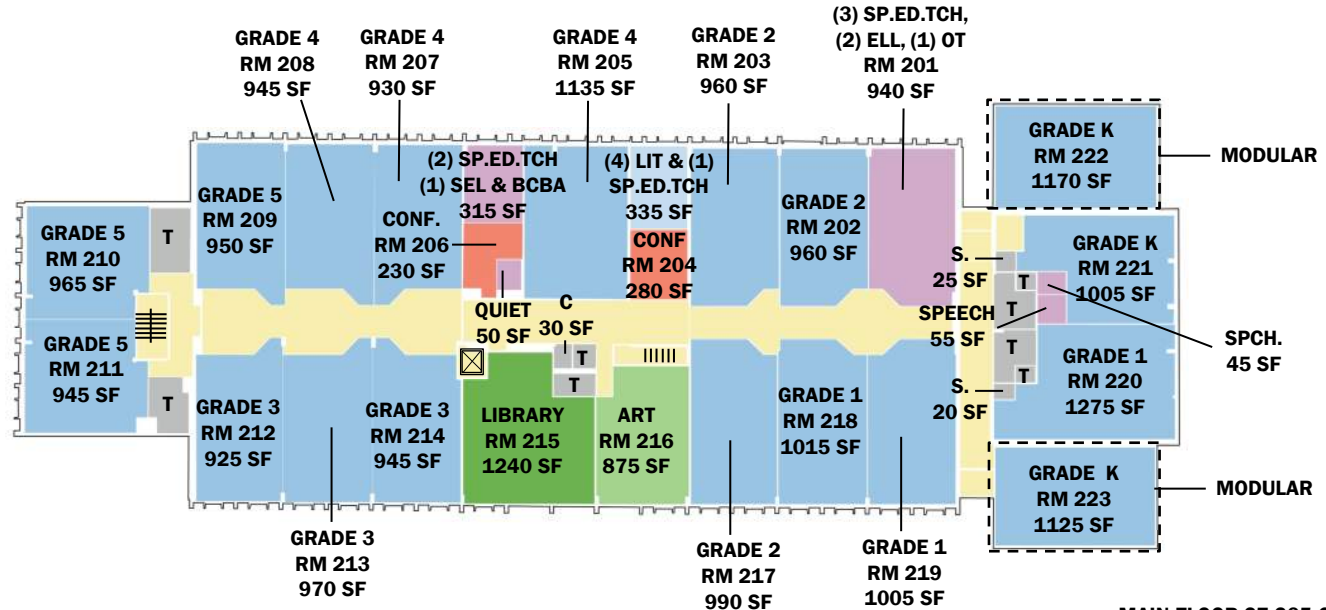

Existing Spaces

Burr – Space Summary

NEWTON PUBLIC SCHOOLS	BURR		
ROOM TYPE	ROOM NFA ¹	# OF ROOMS	AREA TOTALS
CORE ACADEMIC	18		18,730
Kindergarten Classroom	1,005	1	1,005
Modular Kindergarten Classrooms	1,148	2	2,295
General Classroom (Grades 1-4)	994	15	14,915
Modular General Classrooms			0
Science/Tech/Engineering (STE) Room (Gr.3-6)			0
STE Storage Room (if applicable)			0
ELL (in modular at Bowen)	(2) within Sp. Ed. Teaching		
Literacy Center / Books	335	1	335
Literacy Specialist	(1) within Literacy Center		
Math Coach	180	1	180
SPECIAL EDUCATION			2,135
Special Education Teaching	940	1	940
	315	1	315
Break-Out/Small Group	300	1	300
OT/PT	(1) within Sp. Ed. Teaching		
OT/PT Office			
Quiet	50		50
Speech and Language	50	2	100
Team Specialist - IEP Conference	90		90
Psychologist (incl testing/storage)	170	1	170
Psych - Play to Learn			0
Social Worker	170	1	170
Behavioral / BCBA	(2) within Sp. Ed. Teaching		
Bridge Program Classroom (K-2 & 3-5)			0
Bridge Program Storage			0
Reflections Program (K-2)			0
STRIDE Program (K & 1-3)			0
ART & MUSIC			1,900
Art Classroom (25 seats)	875	1	875
Art Workroom with Storage and Kiln			0
Music Classroom (modular at Mason-Rice)	1,025	1	1,025
Music Practice / Ensemble			0
HEALTH & PHYSICAL EDUCATION			4,418
Gymnasium	3,865	1	3,865
Gym Storeroom	375	1	375
Health Instructor's Office with Shower and Toilet	170	1	170
MEDIA CENTER / LIBRARY			1,240
Media Center / Reading Room	1,240	1	1,240

NPS EDUCATIONAL PROGRAM (14 CRs = 306-322 Students)			NPS EDUCATIONAL PROGRAM (18 CRs = 396-414 Students)		
ROOM NFA ¹	# OF ROOMS	AREA TOTALS	ROOM NFA ¹	# OF ROOMS	AREA TOTALS
14		14,725	18		18,525
1,100	3	3,300	1,100	4	4,400
0		0			0
900	11	9,900	900	14	12,600
0		0			0
0		0			0
300	1	300	300	1	300
900	1	900	900	1	900
175	1	175	175	1	175
150	1	150	150	1	150
3,650	4	900	225	4	900
0		0			0
125	6	750	125	6	750
425	1	425	425	1	425
175	1	175	175	1	175
100	3	300	100	3	300
250	1	250	250	1	250
400	1	400	400	1	400
150	1	150	150	1	150
0		0			0
150	1	150	150	1	150
150	1	150	150	1	150
0		0			0
0		0			0
0		0			0
0		0			0
0		0			0
2,500		2,500			2,500
1,000	1	1,000	1,000	1	1,000
150	1	150	150	1	150
1,200	1	1,200	1,200	1	1,200
75	2	150	75	2	150
6,300		6,300	6,300		6,300
6,000	1	6,000	6,000	1	6,000
200	1	200	200	1	200
100	1	100	100	1	100
2,047		2,047	2,452		2,452
2,047	1	2,047	2,452	1	2,452

NEWTON PUBLIC SCHOOLS	BURR		
ROOM TYPE	ROOM NFA ¹	# OF ROOMS	AREA TOTALS
DINING & FOOD SERVICE			4,335
Cafeteria / Dining	3,685	1	3,685
Stage			0
Chair / Table / Equipment Storage			0
Kitchen	310	1	310
Staff Lunch Room	340	1	340
MEDICAL			165
Medical Suite Toilet			0
Nurses' Office / Waiting Room	165	1	165
Examination Room / Resting			0
ADMINISTRATION & GUIDANCE			1,370
General Office / Waiting Room with Toilet	510	1	510
Teachers' Mail and Time Room			0
Copy Room			0
Records Room			0
Principal's Office with Conference Area	350	1	350
Principal's Secretary / Waiting			0
Assistant Principal's Office			0
Supervisory / Spare Office (ASP)	255	2	510
Conference Room			0
Guidance Office			0
Guidance Storeroom			0
Teachers' Work room			0
METCD			0
SEL Coach / Intervention (can share space)	(1) within Learning Center		
Wellness / Nursing Room			0
CUSTODIAL & MAINTENANCE			2,645
Custodian's Office	165	1	165
Custodian's Workshop			0
Custodian's Storage	30	2	60
Recycling Room / Trash			0
Receiving and General Supply Storeroom			0
Network / Telecom Room			0
Misc. Storage Rooms	403	6	2,470
OTHER			2,155
Auditorium			no auditorium
Stage			0
After School Program (ASP)/Office	105	1	105
ASP Storage			0
Assoc Dir of Elem Educ			0
Sp. Educ Asst Director			0
District Storage	1,025	2	2,050
Total Building Net Floor Area (NFA)			39,085
Enrollment			395
Total Building Gross Floor Area (GFA)¹			53,060
Grossing Factor (GFA / NFA)			1.36

NPS EDUCATIONAL PROGRAM (14 CRs = 306-322 Students)			NPS EDUCATIONAL PROGRAM (18 CRs = 396-414 Students)		
ROOM NFA ¹	# OF ROOMS	AREA TOTALS	ROOM NFA ¹	# OF ROOMS	AREA TOTALS
5,375		5,375	5,962		5,962
2,295	1	2,295	2,970	1	2,970
1,000	1	1,000	1,000	1	1,000
302	1	302	312	1	312
1,460	1	1,460	1,460	1	1,460
200	1	200	200	1	200
410		410	410		410
60	1	60	60	1	60
250	1	250	250	1	250
100	1	100	100	1	100
2,080		2,080	2,080		2,080
650	1	650	650	1	650
included in gen. office			included in gen. office		
included in gen. office			included in gen. office		
80	1	80	80	1	80
300	1	300	300	1	300
included in gen. office			included in gen. office		
150	1	150	150	1	150
250	1	250	250	1	250
0		0			0
0		0			0
200	2	400	200	2	400
150	1	150	150	1	150
100	1	100	100	1	100
1,790		1,790	1,790		1,790
100	1	100	100	1	100
0		0			0
500	1	500	500	1	500
700	1	700	700	1	700
included in above			included in above		
200	1	200	200	1	200
250	1	250	250	1	250
0		0			0
1,250		1,250	1,250		1,250
0		0			0
1,000	1	1,000	1,000	1	1,000
250	1	250	250	1	250
0		0			0
0		0			0
0		0			0
39,085		39,085	44,879		44,879
396		396	396		396
53,060		53,060	67,318		67,318
1.50		1.50	1.50		1.50



Existing Spaces

Mason Rice – Lower Floor

- General Education Classroom
- General Education Support Spaces
- Special Education
- Music, Arts & Phys Ed
- Media Center/Library
- Dining & Food Service
- Admin & Guidance
- Extended Day
- Cust, Maint, & Toilets
- Circulation, Stair, Lift

- ASP – AFTER SCHOOL PROGRAM
- BCBA – BEHAVIOR ANALYST
- B.O. – BREAK-OUT / SMALL GROUP
- C / CUST – CUSTODIAL
- CAF – CAFETERIA
- CR – CLASSROOM
- ELL – ENGLISH LANGUAGE LEARNER
- K – KINDERGARTEN
- LIT – LITERACY
- MECH/MDF – MECHANICAL/ELECTRICAL
- O / OFF – OFFICE
- OT – OCCUPATIONAL THERAPY
- PSY – PSYCHOLOGIST
- S / STOR – STORAGE
- SEL – SOCIAL-EMOTIONAL LEARNING
- SP.ED.TCH – SPECIAL EDUCATION TEACHING
- SPCH – SPEECH & LANGUAGE
- SW / SOC – SOCIAL WORKER
- T – TOILET
- TM – TEAM SPECIALIST

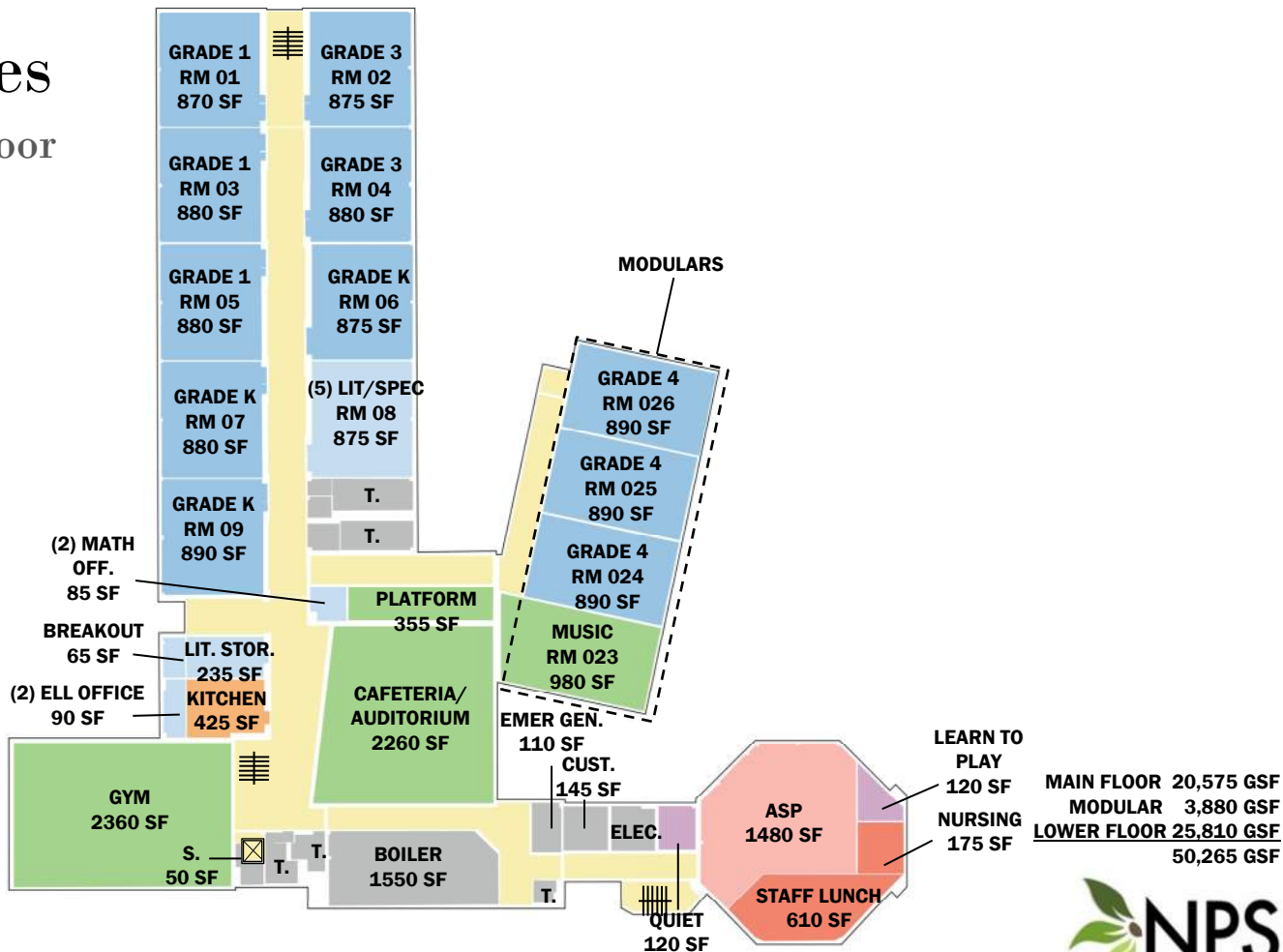

Existing Spaces

Mason Rice – Main Floor

- General Education Classroom
- General Education Support Spaces
- Special Education
- Music, Arts & Phys Ed
- Media Center/Library
- Dining & Food Service
- Admin & Guidance
- Extended Day
- Cust, Maint, & Toilets
- Circulation, Stair, Lift

- ASP – AFTER SCHOOL PROGRAM
- BCBA – BEHAVIOR ANALYST
- B.O. – BREAK-OUT / SMALL GROUP
- C / CUST – CUSTODIAL
- CAF – CAFETERIA
- CR – CLASSROOM
- ELL – ENGLISH LANGUAGE LEARNER
- K – KINDERGARTEN
- LIT – LITERACY
- MECH/MDF – MECHANICAL/ELECTRICAL
- O / OFF – OFFICE
- OT – OCCUPATIONAL THERAPY
- PSY – PSYCHOLOGIST
- S / STOR – STORAGE
- SEL – SOCIAL-EMOTIONAL LEARNING
- SP.ED.TCH – SPECIAL EDUCATION TEACHING
- SPCH – SPEECH & LANGUAGE
- SW / SOC – SOCIAL WORKER
- T – TOILET
- TM – TEAM SPECIALIST

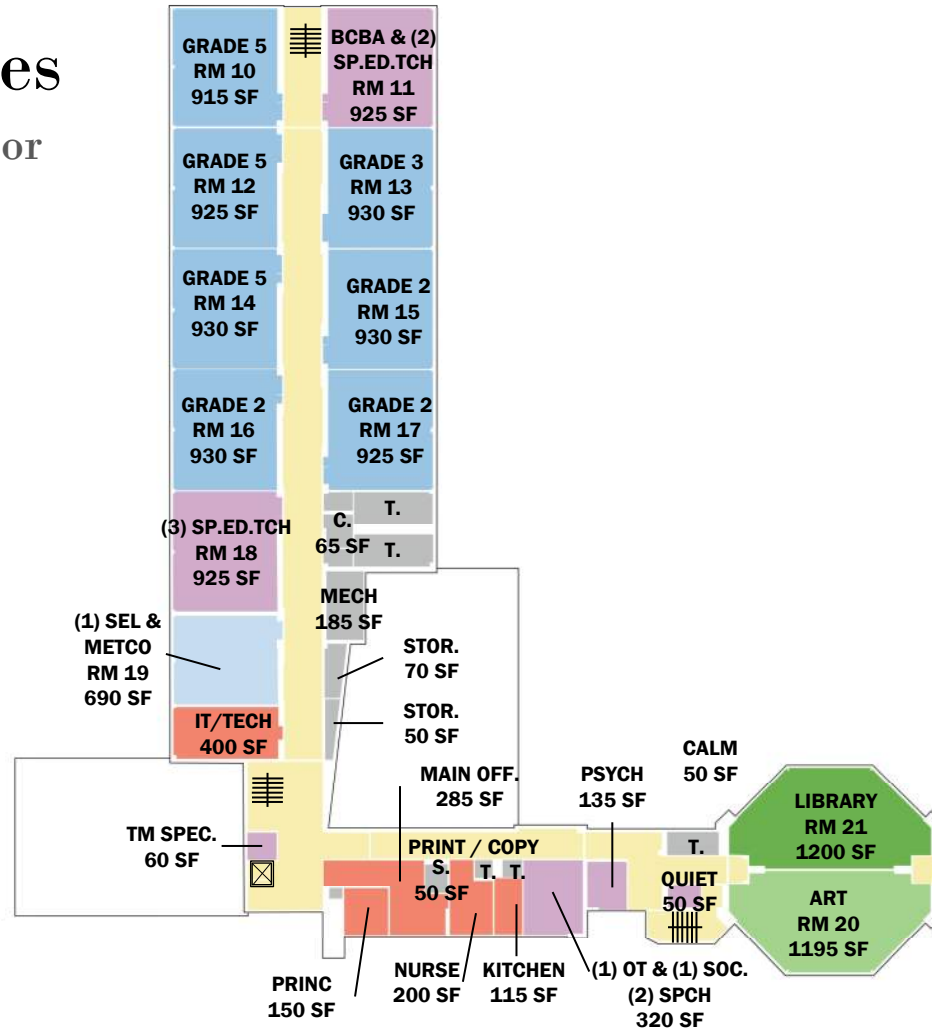

MAIN FLOOR 20,750 GSF
MODULAR 3,880 GSF
LOWER FLOOR 25,810 GSF
50,440 GSF

Existing Spaces

Mason-Rice – Space Summary

NEWTON PUBLIC SCHOOLS	MASON-RICE		
ROOM TYPE	ROOM NFA ¹	# OF ROOMS	AREA TOTALS
CORE ACADEMIC	18		17,470
Kindergarten Classroom	882	3	2,643
Modular Kindergarten Classrooms			0
General Classroom (Grades 1-4)	906	12	10,872
Modular General Classrooms	890	3	2,670
Science/Tech/Engineering (STE) Room (Gr 3-6)			0
STE Storage Room (if applicable)			0
ELL (in modular at Bowen)	90	1	90
Literacy Center / Books	875	1	875
Literacy Specialist	235	1	235
Math Coach	85	1	85
SPECIAL EDUCATION			2,785
Special Education Teaching	925	2	1,850
Break-Out/Small Group	65	1	65
OT/PT	435	1	435
OT/PT Office			
Quiet	120	1	120
Speech and Language	(2) within OT/PT		
Team Specialist + EP Conference	60	1	60
Psychologist (incl testing/storage)	135	1	135
Psych - Play to Learn	120	1	120
Social Worker	(1) within OT/PT		
Behavioral / BCBA	(1) within Sp. Ed. Teaching		
Bridge Program Classroom (K-2 & 3-5)			0
Bridge Program Storage			0
Reflections Program (K-2)			0
STRIDE Program (K & 1-3)			0
ART & MUSIC			2,175
Art Classroom (25 seats)	1,195	1	1,195
Art Workroom with Storage and Kiln			0
Music Classroom (modular at Mason-Rice)	980	1	980
Music Practice / Ensemble			0
HEALTH & PHYSICAL EDUCATION			2,370
Gymnasium	2,360	1	2,360
Gym Storeroom	10	1	10
Health Instructor's Office with Shower and Toilet			0
MEDIA CENTER / LIBRARY			1,200
Media Center / Reading Room	1,200	1	1,200

NPS EDUCATIONAL PROGRAM (14 CRs = 306-322 Students)			NPS EDUCATIONAL PROGRAM (18 CRs = 396-414 Students)		
ROOM NFA ¹	# OF ROOMS	AREA TOTALS	ROOM NFA ¹	# OF ROOMS	AREA TOTALS
14		14,725	18		18,325
1,100	3	3,300	1,100	4	4,400
0		0			0
900	11	9,900	900	14	12,600
0		0			0
0		0			0
300	1	300	300	1	300
900	1	900	900	1	900
175	1	175	175	1	175
150	1	150	150	1	150
3,650		3,650	3,650		3,650
225	4	900	225	4	900
0		0			0
125	6	750	125	6	750
425	1	425	425	1	425
175	1	175	175	1	175
100	3	300	100	3	300
250	1	250	250	1	250
400	1	400	400	1	400
150	1	150	150	1	150
0		0			0
150	1	150	150	1	150
150	1	150	150	1	150
0		0			0
0		0			0
0		0			0
0		0			0
2,500		2,500	2,500		2,500
1,000	1	1,000	1,000	1	1,000
150	1	150	150	1	150
1,200	1	1,200	1,200	1	1,200
75	2	150	75	2	150
6,300		6,300	6,300		6,300
6,000	1	6,000	6,000	1	6,000
200	1	200	200	1	200
100	1	100	100	1	100
2,047		2,047	2,452		2,452
2,047	1	2,047	2,452	1	2,452

NEWTON PUBLIC SCHOOLS	MASON-RICE		
ROOM TYPE	ROOM NFA ¹	# OF ROOMS	AREA TOTALS
DINING & FOOD SERVICE			1,035
Cafeteria / Dining			uses Auditorium
Stage			within Auditorium
Chair / Table / Equipment Storage			0
Kitchen	425	1	425
Staff Lunch Room	610	1	610
MEDICAL			200
Medical Suite Toilet			0
Nurses' Office / Waiting Room	200	1	200
Examination Room / Resting			0
ADMINISTRATION & GUIDANCE			1,350
General Office / Waiting Room with Toilet	285	1	285
Teachers' Mail and Time Room			0
Copy Room			in Corridors
Records Room	50	1	50
Principal's Office with Conference Area	150	1	150
Principal's Secretary / Waiting			0
Assistant Principal's Office			0
Supervisory / Spare Office (ASP)			0
Conference Room			0
Guidance Office			0
Guidance Storeroom			0
Teachers' Work Room			0
METCD			(1) within SEL
SEL Coach / Intervention (can share space)	690	1	690
Wellness / Nursing Room	175	1	175
CUSTODIAL & MAINTENANCE			930
Custodian's Office	145	1	145
Custodian's Workshop			0
Custodian's Storage	65	2	130
Recycling Room / Trash			0
Receiving and General Supply Storeroom			0
Network / Telecom Room	400	1	400
Misc. Storage Rooms	64	4	256
OTHER			4,055
Auditorium	2,260	1	2,260
Stage	355	1	355
After School Program (ASP)/Office	1,480	1	1,480
ASP Director			0
Assoc Dir of Elem Educ			0
Sp. Educ Asst Director			0
District Storage			0
Total Building Net Floor Area (NFA)			33,630
Enrollment			334
Total Building Gross Floor Area (GFA) ²			50,440
Grossing Factor (GFA / NFA)			1.50

NPS EDUCATIONAL PROGRAM (14 CRs = 306-322 Students)			NPS EDUCATIONAL PROGRAM (18 CRs = 396-414 Students)		
ROOM NFA ¹	# OF ROOMS	AREA TOTALS	ROOM NFA ¹	# OF ROOMS	AREA TOTALS
5,257		5,257	5,962		5,962
2,295	1	2,295	2,970	1	2,970
1,000	1	1,000	1,000	1	1,000
302	1	302	312	1	312
1,460	1	1,460	1,460	1	1,460
200	1	200	200	1	200
410		410	410		410
60	1	60	60	1	60
250	1	250	250	1	250
100	1	100	100	1	100
2,080		2,080	2,080		2,080
650	1	650	650	1	650
		included in gen. office			included in gen. office
		included in gen. office			included in gen. office
80	1	80	80	1	80
300	1	300	300	1	300
		included in gen. office			included in gen. office
150	1	150	150	1	150
250	1	250	250	1	250
0		0			0
0		0			0
200	2	400	200	2	400
150	1	150	150	1	150
100	1	100	100	1	100
1,750		1,750	1,750		1,750
100	1	100	100	1	100
0		0			0
500	1	500	500	1	500
700	1	700	700	1	700
		included in above			included in above
200	1	200	200	1	200
250	1	250	250	1	250
0		0			0
1,250		1,250	1,250		1,250
0		0			0
1,000	1	1,000	1,000	1	1,000
250	1	250	250	1	250
0		0			0
0		0			0
0		0			0
0		0			0
0		0			0
39,969		39,969	44,879		44,879
396		396	396		396
59,953		59,953	67,318		67,318
1.50		1.50	1.50		1.50



Existing Spaces

Memorial-Spaulding – Lower Floor

- General Education Classroom
- General Education Support Spaces
- Special Education
- Music, Arts & Phys Ed
- Media Center/Library
- Dining & Food Service
- Admin & Guidance
- Extended Day
- Cust, Maint, & Toilets
- Circulation, Stair, Lift

- ASP – AFTER SCHOOL PROGRAM
- BCBA – BEHAVIOR ANALYST
- B.O. – BREAK-OUT / SMALL GROUP
- C / CUST – CUSTODIAL
- CAF – CAFETERIA
- CR – CLASSROOM
- ELL – ENGLISH LANGUAGE LEARNER
- K – KINDERGARTEN
- LIT – LITERACY
- MECH/MDF – MECHANICAL/ELECTRICAL
- O / OFF – OFFICE
- OT – OCCUPATIONAL THERAPY
- PSY – PSYCHOLOGIST
- S / STOR – STORAGE
- SEL – SOCIAL-EMOTIONAL LEARNING
- SP.ED.TCH – SPECIAL EDUCATION TEACHING
- SPCH – SPEECH & LANGUAGE
- SW / SOC – SOCIAL WORKER
- T – TOILET
- TM – TEAM SPECIALIST

MAIN FLOOR 45,525 GSF
LOWER FLOOR 18,950 GSF
64,475 GSF

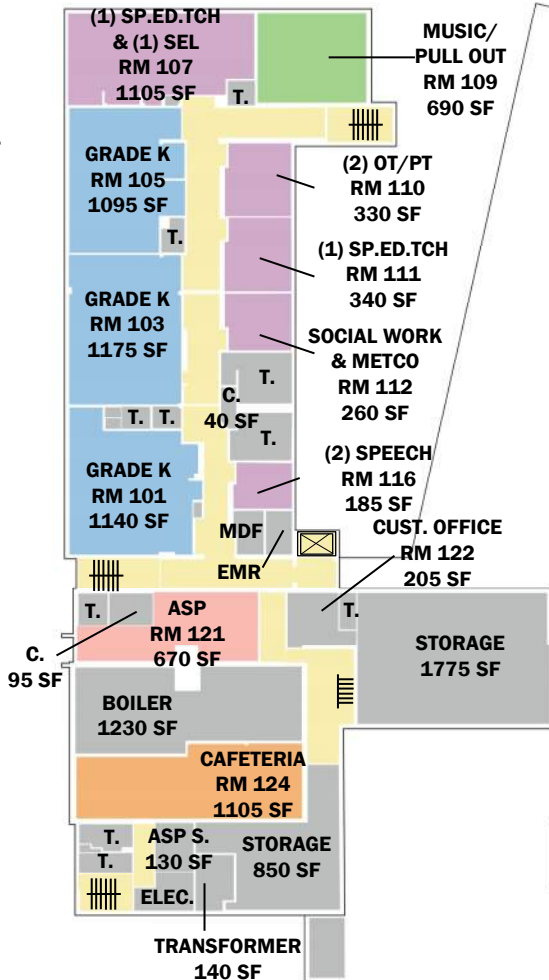

Existing Spaces

Memorial-Spaulding – Main Floor

- General Education Classroom
- General Education Support Spaces
- Special Education
- Music, Arts & Phys Ed
- Media Center/Library
- Dining & Food Service
- Admin & Guidance
- Extended Day
- Cust, Maint, & Toilets
- Circulation, Stair, Lift

- ASP – AFTER SCHOOL PROGRAM
- BCBA – BEHAVIOR ANALYST
- B.O. – BREAK-OUT / SMALL GROUP
- C / CUST – CUSTODIAL
- CAF – CAFETERIA
- CR – CLASSROOM
- ELL – ENGLISH LANGUAGE LEARNER
- K – KINDERGARTEN
- LIT – LITERACY
- MECH/MDF – MECHANICAL/ELECTRICAL
- O / OFF – OFFICE
- OT – OCCUPATIONAL THERAPY
- PSY – PSYCHOLOGIST
- S / STOR – STORAGE
- SEL – SOCIAL-EMOTIONAL LEARNING
- SP.ED.TCH – SPECIAL EDUCATION TEACHING
- SPCH – SPEECH & LANGUAGE
- SW / SOC – SOCIAL WORKER
- T – TOILET
- TM – TEAM SPECIALIST

MAIN FLOOR 45,525 GSF
LOWER FLOOR 18,950 GSF
64,475 GSF

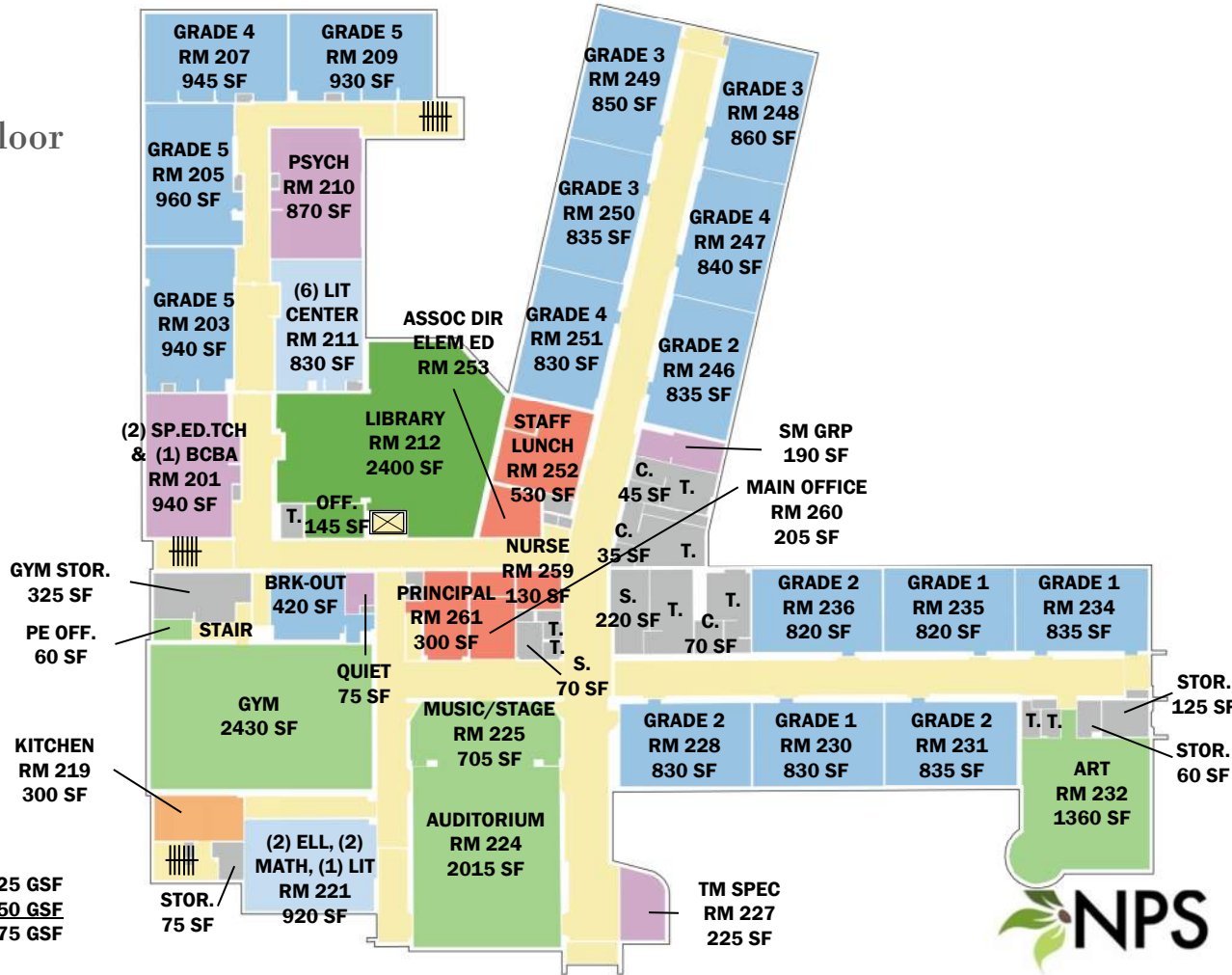

Existing Spaces

Peirce – Lower Floor

- General Education Classroom
- General Education Support Spaces
- Special Education
- Music, Arts & Phys Ed
- Media Center/Library
- Dining & Food Service
- Admin & Guidance
- Extended Day
- Cust, Maint, & Toilets
- Circulation, Stair, Lift

- ASP – AFTER SCHOOL PROGRAM
- BCBA – BEHAVIOR ANALYST
- B.O. – BREAK-OUT / SMALL GROUP
- C / CUST – CUSTODIAL
- CAF – CAFETERIA
- CR – CLASSROOM
- ELL – ENGLISH LANGUAGE LEARNER
- K – KINDERGARTEN
- LIT – LITERACY
- MECH/MDF – MECHANICAL/ELECTRICAL
- O / OFF – OFFICE
- OT – OCCUPATIONAL THERAPY
- PSY – PSYCHOLOGIST
- S / STOR – STORAGE
- SEL – SOCIAL-EMOTIONAL LEARNING
- SP.ED.TCH – SPECIAL EDUCATION TEACHING
- SPCH – SPEECH & LANGUAGE
- SW / SOC – SOCIAL WORKER
- T – TOILET
- TM – TEAM SPECIALIST

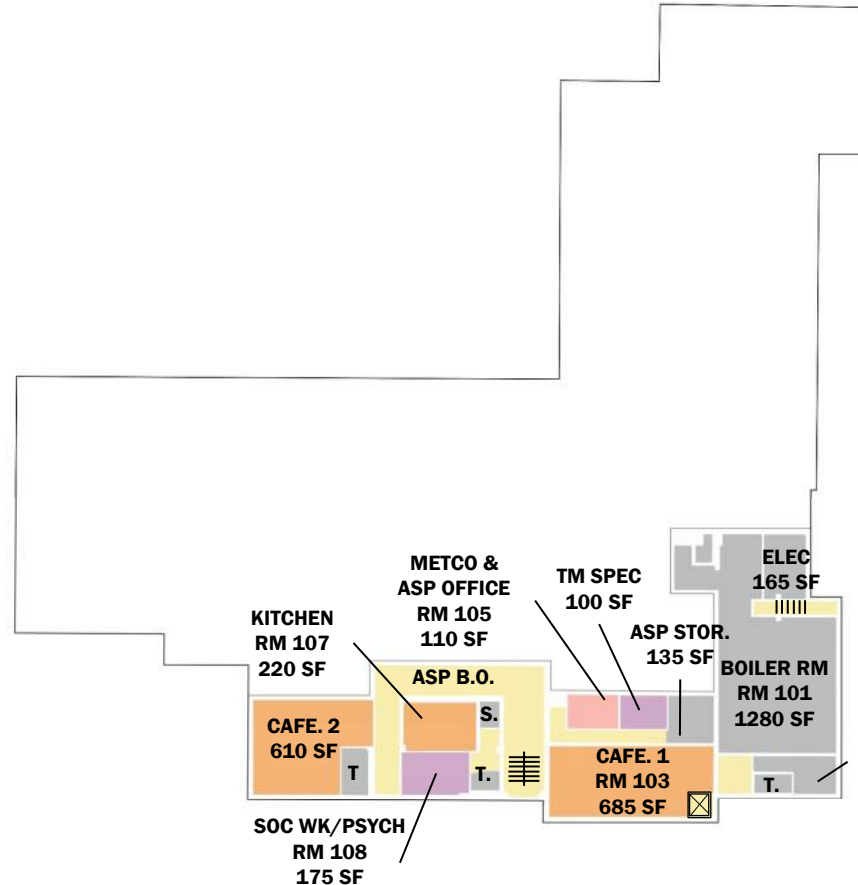

MAIN FLOOR 30,290 GSF
MODULARS 1,860 GSF
LOWER FLOOR 5,960 GSF
38,110 GSF

Existing Spaces

Peirce – Main Floor

- General Education Classroom
- General Education Support Spaces
- Special Education
- Music, Arts & Phys Ed
- Media Center/Library
- Dining & Food Service
- Admin & Guidance
- Extended Day
- Cust, Maint, & Toilets
- Circulation, Stair, Lift

- ASP – AFTER SCHOOL PROGRAM
- BCBA – BEHAVIOR ANALYST
- B.O. – BREAK-OUT / SMALL GROUP
- C / CUST – CUSTODIAL
- CAF – CAFETERIA
- CR – CLASSROOM
- ELL – ENGLISH LANGUAGE LEARNER
- K – KINDERGARTEN
- LIT – LITERACY
- MECH/MDF – MECHANICAL/ELECTRICAL
- O / OFF – OFFICE
- OT – OCCUPATIONAL THERAPY
- PSY – PSYCHOLOGIST
- S / STOR – STORAGE
- SEL – SOCIAL-EMOTIONAL LEARNING
- SP.ED.TCH – SPECIAL EDUCATION TEACHING
- SPCH – SPEECH & LANGUAGE
- SW / SOC – SOCIAL WORKER
- T – TOILET
- TM – TEAM SPECIALIST

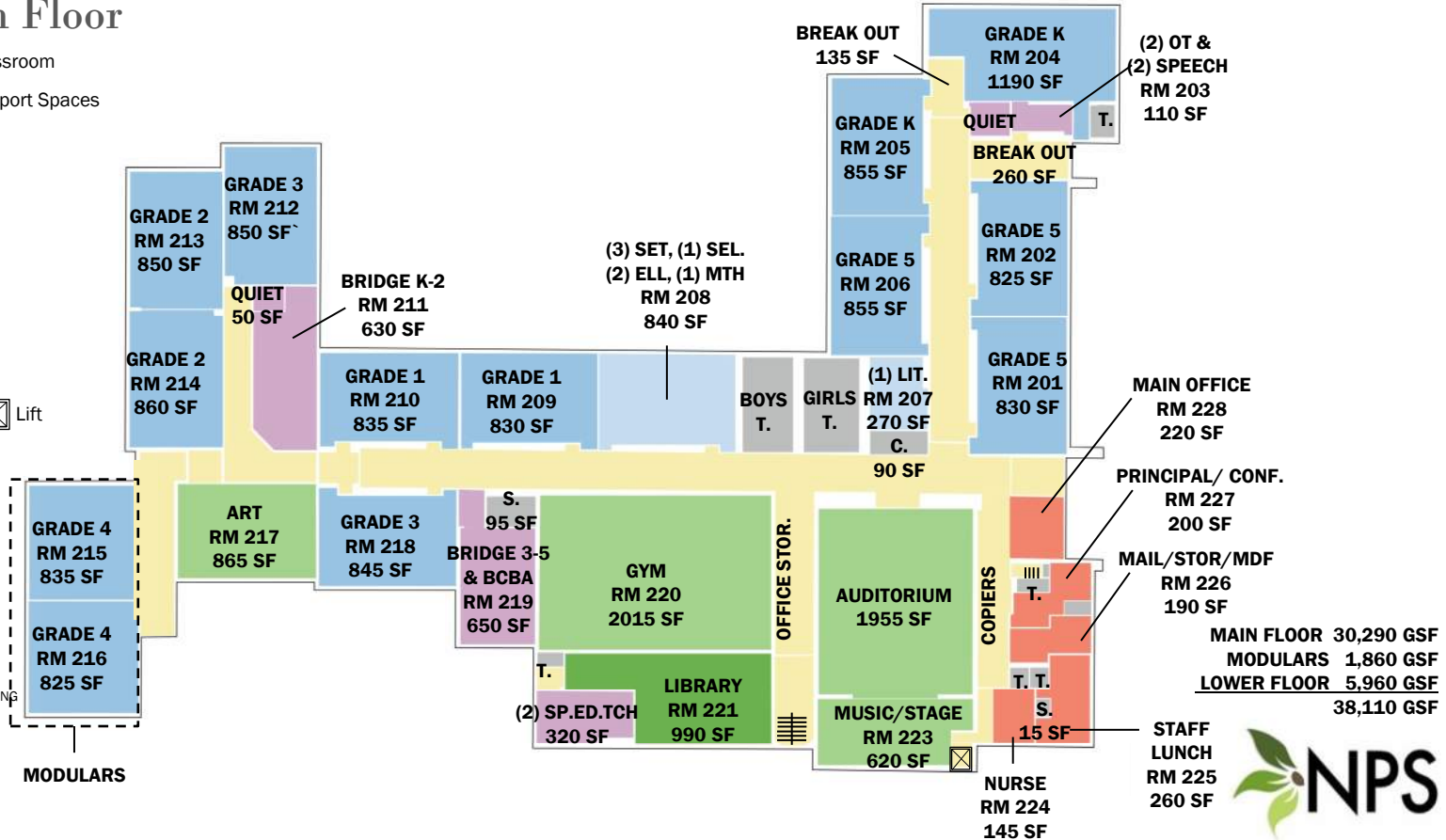

Existing Spaces

Underwood – Lower Floor

- General Education Classroom
- General Education Support Spaces
- Special Education
- Music, Arts & Phys Ed
- Media Center/Library
- Dining & Food Service
- Admin & Guidance
- Extended Day
- Cust, Maint, & Toilets
- Circulation, Stair, Lift

- ASP** – AFTER SCHOOL PROGRAM
- BCBA** – BEHAVIOR ANALYST
- B.O.** – BREAK-OUT / SMALL GROUP
- C / CUST.** – CUSTODIAL
- CAF** – CAFETERIA
- CR** – CLASSROOM
- ELL** – ENGLISH LANGUAGE LEARNER
- K** – KINDERGARTEN
- LIT** – LITERACY
- MECH/MDF** – MECHANICAL/ELECTRICAL
- O / OFF** – OFFICE
- OT** – OCCUPATIONAL THERAPY
- PSY** – PSYCHOLOGIST
- S / STOR** – STORAGE
- SEL** – SOCIAL-EMOTIONAL LEARNING
- SP.ED.TCH** – SPECIAL EDUCATION TEACHING
- SPCH** – SPEECH & LANGUAGE
- SW / SOC** – SOCIAL WORKER
- T** – TOILET
- TM** – TEAM SPECIALIST

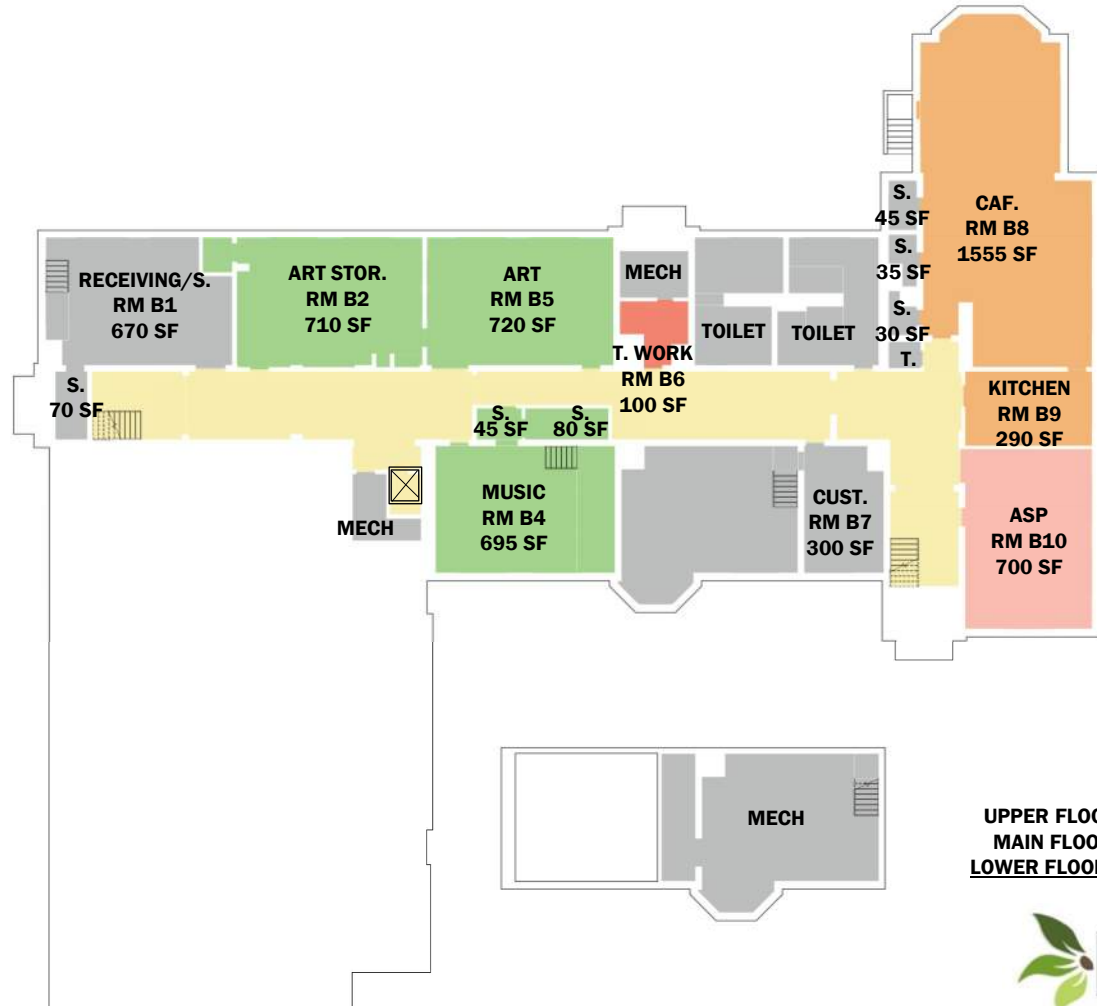

UPPER FLOOR 13,000 GSF
 MAIN FLOOR 17,000 GSF
LOWER FLOOR 11,000 GSF
 41,000 GSF

Existing Spaces

Underwood – Main Floor

- General Education Classroom
- General Education Support Spaces
- Special Education
- Music, Arts & Phys Ed
- Media Center/Library
- Dining & Food Service
- Admin & Guidance
- Extended Day
- Cust, Maint, & Toilets
- Circulation, Stair, Lift

- ASP – AFTER SCHOOL PROGRAM
- BCBA – BEHAVIOR ANALYST
- B.O. – BREAK-OUT / SMALL GROUP
- C / CUST – CUSTODIAL
- CAF – CAFETERIA
- CR – CLASSROOM
- ELL – ENGLISH LANGUAGE LEARNER
- K – KINDERGARTEN
- LIT – LITERACY
- MECH/MDF – MECHANICAL/ELECTRICAL
- O / OFF – OFFICE
- OT – OCCUPATIONAL THERAPY
- PSY – PSYCHOLOGIST
- S / STOR – STORAGE
- SEL – SOCIAL-EMOTIONAL LEARNING
- SP.ED.TCH – SPECIAL EDUCATION TEACHING
- SPCH – SPEECH & LANGUAGE
- SW / SOC – SOCIAL WORKER
- T – TOILET
- TM – TEAM SPECIALIST



UPPER FLOOR 13,000 GSF
 MAIN FLOOR 17,000 GSF
 LOWER FLOOR 11,000 GSF
41,000 GSF

Existing Spaces

Underwood – Upper Floor

- General Education Classroom
- General Education Support Spaces
- Special Education
- Music, Arts & Phys Ed
- Media Center/Library
- Dining & Food Service
- Admin & Guidance
- Extended Day
- Cust, Maint, & Toilets
- Circulation, Stair, Lift

- ASP – AFTER SCHOOL PROGRAM
- BCBA – BEHAVIOR ANALYST
- B.O. – BREAK-OUT / SMALL GROUP
- C / CUST – CUSTODIAL
- CAF – CAFETERIA
- CR – CLASSROOM
- ELL – ENGLISH LANGUAGE LEARNER
- K – KINDERGARTEN
- LIT – LITERACY
- MECH/MDF – MECHANICAL/ELECTRICAL
- O / OFF – OFFICE
- OT – OCCUPATIONAL THERAPY
- PSY – PSYCHOLOGIST
- S / STOR – STORAGE
- SEL – SOCIAL-EMOTIONAL LEARNING
- SP.ED.TCH – SPECIAL EDUCATION TEACHING
- SPCH – SPEECH & LANGUAGE
- SW / SOC – SOCIAL WORKER
- T – TOILET
- TM – TEAM SPECIALIST



UPPER FLOOR 13,000 GSF
 MAIN FLOOR 17,000 GSF
 LOWER FLOOR 11,000 GSF
41,000 GSF

Existing Spaces

Ward – Lower Floor

- General Education Classroom
- General Education Support Spaces
- Special Education
- Music, Arts & Phys Ed
- Media Center/Library
- Dining & Food Service
- Admin & Guidance
- Extended Day
- Cust, Maint, & Toilets
- Circulation, Stair, Lift

ASP – AFTER SCHOOL PROGRAM
BCBA – BEHAVIOR ANALYST
B.O. – BREAK-OUT / SMALL GROUP
C / CUST – CUSTODIAL
CAF – CAFETERIA
CR – CLASSROOM
ELL – ENGLISH LANGUAGE LEARNER
K – KINDERGARTEN
LIT – LITERACY
MECH/MDF – MECHANICAL/ELECTRICAL
O / OFF – OFFICE
OT – OCCUPATIONAL THERAPY
PSY – PSYCHOLOGIST
S / STOR – STORAGE
SEL – SOCIAL-EMOTIONAL LEARNING
SP.ED.TCH – SPECIAL EDUCATION TEACHING
SPCH – SPEECH & LANGUAGE
SW / SOC – SOCIAL WORKER
T – TOILET
TM – TEAM SPECIALIST

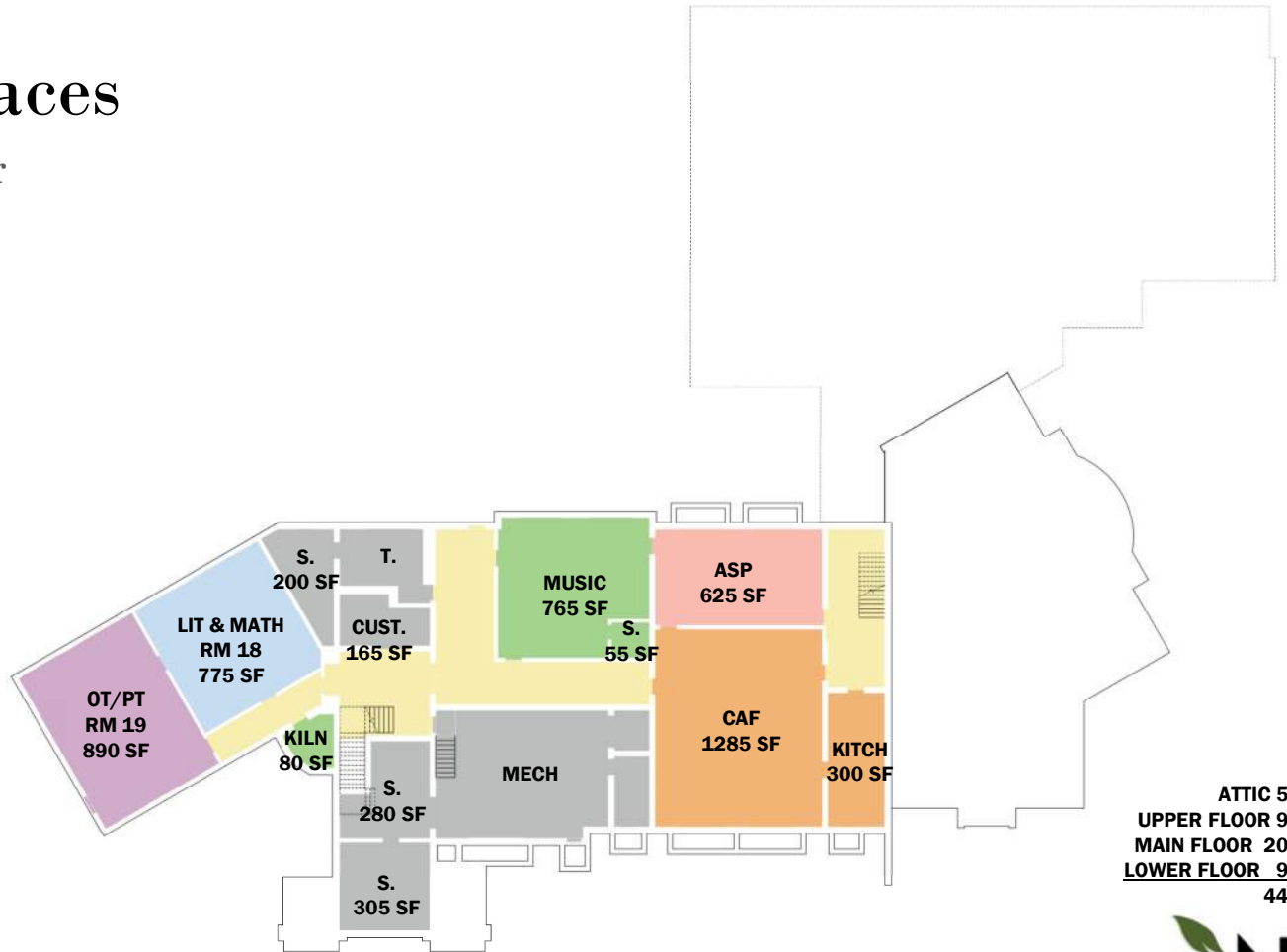

ATTIC 5,800 GSF
UPPER FLOOR 9,000 GSF
MAIN FLOOR 20,400 GSF
LOWER FLOOR 9,000 GSF
44,200 GSF

Existing Spaces

Ward – Main Floor

- General Education Classroom
- General Education Support Spaces
- Special Education
- Music, Arts & Phys Ed
- Media Center/Library
- Dining & Food Service
- Admin & Guidance
- Extended Day
- Cust, Maint, & Toilets
- Circulation, Stair, Lift

- ASP – AFTER SCHOOL PROGRAM
- BCBA – BEHAVIOR ANALYST
- B.O. – BREAK-OUT / SMALL GROUP
- C / CUST – CUSTODIAL
- CAF – CAFETERIA
- CR – CLASSROOM
- ELL – ENGLISH LANGUAGE LEARNER
- K – KINDERGARTEN
- LIT – LITERACY
- MECH/MDF – MECHANICAL/ELECTRICAL
- O / OFF – OFFICE
- OT – OCCUPATIONAL THERAPY
- PSY – PSYCHOLOGIST
- S / STOR – STORAGE
- SEL – SOCIAL-EMOTIONAL LEARNING
- SP.ED.TCH – SPECIAL EDUCATION TEACHING
- SPCH – SPEECH & LANGUAGE
- SW / SOC – SOCIAL WORKER
- T – TOILET
- TM – TEAM SPECIALIST



ATTIC 5,800 GSF
 UPPER FLOOR 9,000 GSF
 MAIN FLOOR 20,400 GSF
 LOWER FLOOR 9,000 GSF
44,200 GSF

Existing Spaces

Ward – Upper Floor

- General Education Classroom
- General Education Support Spaces
- Special Education
- Music, Arts & Phys Ed
- Media Center/Library
- Dining & Food Service
- Admin & Guidance
- Extended Day
- Cust, Maint, & Toilets
- Circulation, Stair, Lift

- ASP – AFTER SCHOOL PROGRAM
- BCBA – BEHAVIOR ANALYST
- B.O. – BREAK-OUT / SMALL GROUP
- C / CUST – CUSTODIAL
- CAF – CAFETERIA
- CR – CLASSROOM
- ELL – ENGLISH LANGUAGE LEARNER
- K – KINDERGARTEN
- LIT – LITERACY
- MECH/MDF – MECHANICAL/ELECTRICAL
- O / OFF – OFFICE
- OT – OCCUPATIONAL THERAPY
- PSY – PSYCHOLOGIST
- S / STOR – STORAGE
- SEL – SOCIAL-EMOTIONAL LEARNING
- SP.ED.TCH – SPECIAL EDUCATION TEACHING
- SPCH – SPEECH & LANGUAGE
- SW / SOC – SOCIAL WORKER
- T – TOILET
- TM – TEAM SPECIALIST



ATTIC 5,800 GSF
 UPPER FLOOR 9,000 GSF
 MAIN FLOOR 20,400 GSF
 LOWER FLOOR 9,000 GSF
44,200 GSF

Existing Spaces

Williams – Lower Floor

- General Education Classroom
- General Education Support Spaces
- Special Education
- Music, Arts & Phys Ed
- Media Center/Library
- Dining & Food Service
- Admin & Guidance
- Extended Day
- Cust, Maint, & Toilets
- Circulation, Stair, Lift

- ASP – AFTER SCHOOL PROGRAM
- BCBA – BEHAVIOR ANALYST
- B.O. – BREAK-OUT / SMALL GROUP
- C / CUST – CUSTODIAL
- CAF – CAFETERIA
- CR – CLASSROOM
- ELL – ENGLISH LANGUAGE LEARNER
- K – KINDERGARTEN
- LIT – LITERACY
- MECH/MDF – MECHANICAL/ELECTRICAL
- O / OFF – OFFICE
- OT – OCCUPATIONAL THERAPY
- PSY – PSYCHOLOGIST
- S / STOR – STORAGE
- SEL – SOCIAL-EMOTIONAL LEARNING
- SP.ED.TCH – SPECIAL EDUCATION TEACHING
- SPCH – SPEECH & LANGUAGE
- SW / SOC – SOCIAL WORKER
- T – TOILET
- TM – TEAM SPECIALIST

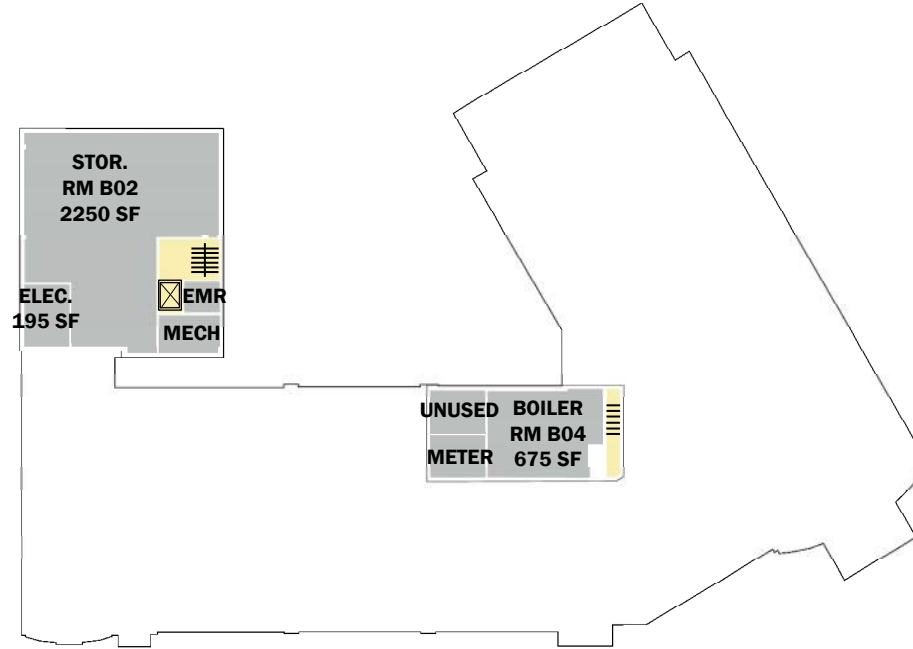

UPPER FLOOR 16,250 GSF
MAIN FLOOR 24,120 GSF
LOWER FLOOR 4,610 GSF
44,980 GSF

Existing Spaces

Williams – Main Floor

- General Education Classroom
- General Education Support Spaces
- Special Education
- Music, Arts & Phys Ed
- Media Center/Library
- Dining & Food Service
- Admin & Guidance
- Extended Day
- Cust, Maint, & Toilets
- Circulation, Stair, Lift

- ASP – AFTER SCHOOL PROGRAM
- BCBA – BEHAVIOR ANALYST
- B.O. – BREAK-OUT / SMALL GROUP
- C / CUST – CUSTODIAL
- CAF – CAFETERIA
- CR – CLASSROOM
- ELL – ENGLISH LANGUAGE LEARNER
- K – KINDERGARTEN
- LIT – LITERACY
- MECH/MDF – MECHANICAL/ELECTRICAL
- O / OFF – OFFICE
- OT – OCCUPATIONAL THERAPY
- PSY – PSYCHOLOGIST
- S / STOR – STORAGE
- SEL – SOCIAL-EMOTIONAL LEARNING
- SP.ED.TCH – SPECIAL EDUCATION TEACHING
- SPCH – SPEECH & LANGUAGE
- SW / SOC – SOCIAL WORKER
- T – TOILET
- TM – TEAM SPECIALIST

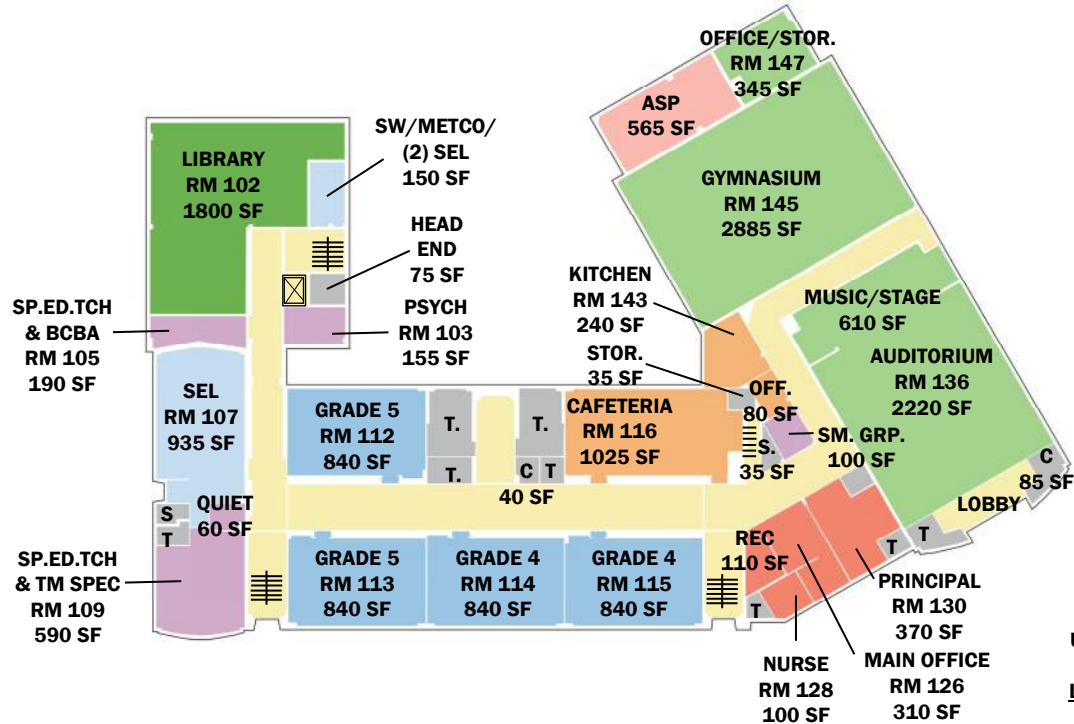

UPPER FLOOR 16,250 GSF
 MAIN FLOOR 24,120 GSF
 LOWER FLOOR 4,610 GSF
44,980 GSF

Existing Spaces

Williams – Upper Floor

- General Education Classroom
- General Education Support Spaces
- Special Education
- Music, Arts & Phys Ed
- Media Center/Library
- Dining & Food Service
- Admin & Guidance
- Extended Day
- Cust, Maint, & Toilets
- Circulation, Stair, Lift

- ASP – AFTER SCHOOL PROGRAM
- BCBA – BEHAVIOR ANALYST
- B.O. – BREAK-OUT / SMALL GROUP
- C / CUST – CUSTODIAL
- CAF – CAFETERIA
- CR – CLASSROOM
- ELL – ENGLISH LANGUAGE LEARNER
- K – KINDERGARTEN
- LIT – LITERACY
- MECH/MDF – MECHANICAL/ELECTRICAL
- O / OFF – OFFICE
- OT – OCCUPATIONAL THERAPY
- PSY – PSYCHOLOGIST
- S / STOR – STORAGE
- SEL – SOCIAL-EMOTIONAL LEARNING
- SP.ED.TCH – SPECIAL EDUCATION TEACHING
- SPCH – SPEECH & LANGUAGE
- SW / SOC – SOCIAL WORKER
- T – TOILET
- TM – TEAM SPECIALIST

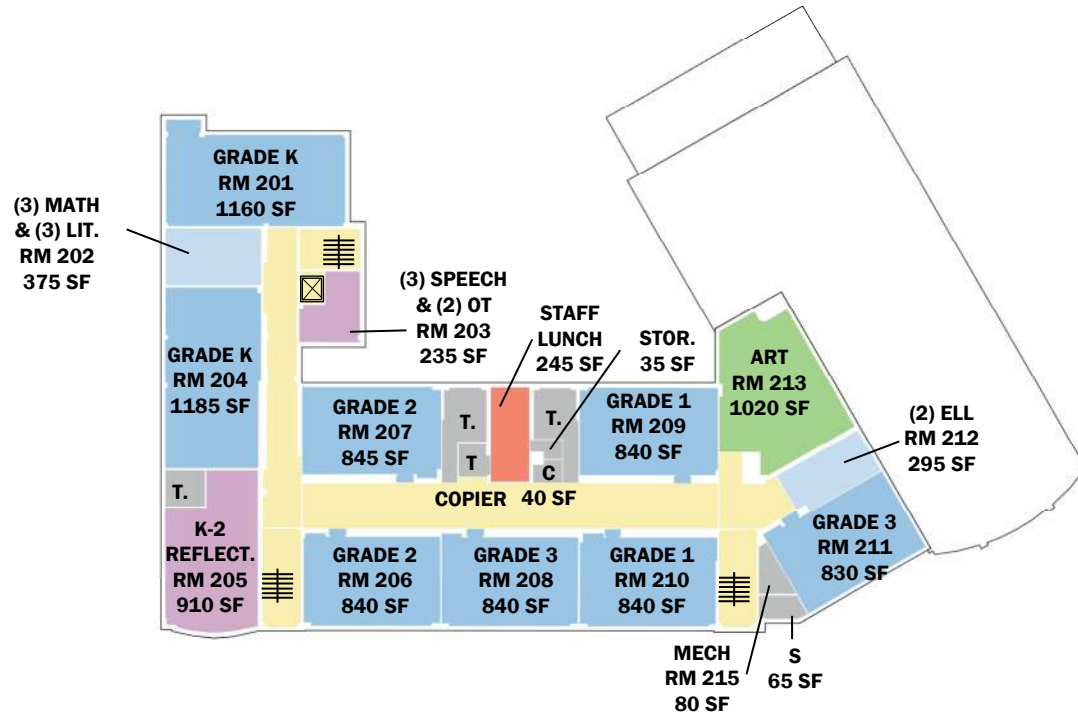

UPPER FLOOR 16,250 GSF
 MAIN FLOOR 24,120 GSF
 LOWER FLOOR 4,610 GSF
44,980 GSF

Appendix – Individual School Conditions & Cost



Bowen Elementary

Site Context & Access

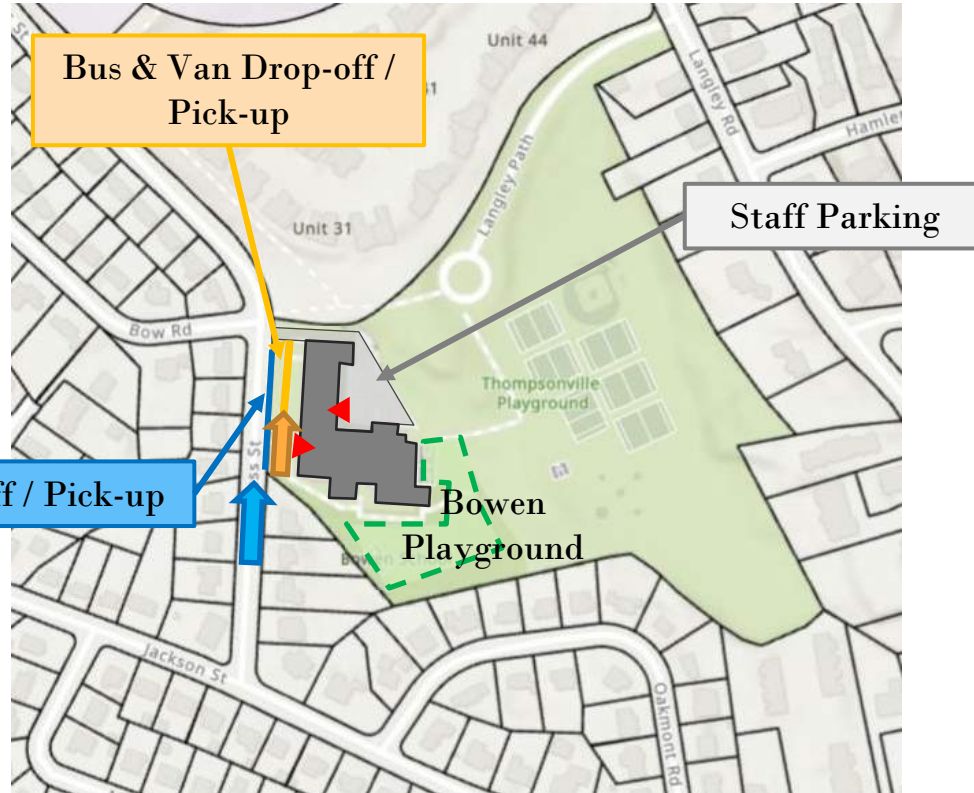
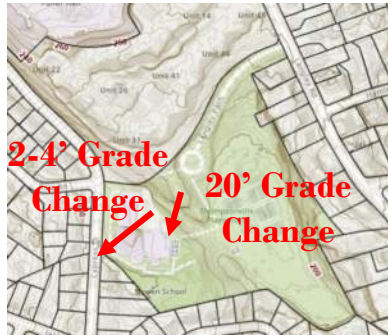

32

Parking Spaces
(includes visitor parking at front)

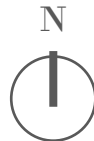

Bowen Elementary

Site Conditions

- Car drop-off / pick-up is on street, bus & van at bus loop.
- Mostly flat site adjacent to school, but significant hill behind constrains school area to part of property, Thompsonville Playground & public fields are located on upper plateau, managed independently of school.
- Some cracking observed in concrete at main entrance ramp.
- Most main access points are accessible, other exits have exterior stairs.

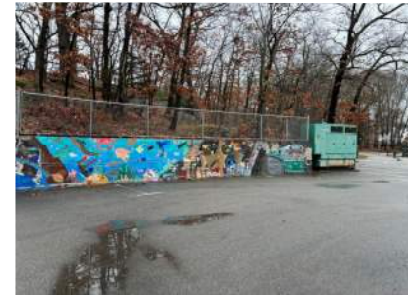

Bowen Elementary Building Conditions

- Boilers have been replaced in last 10-20 years (2005 & 2012), but do not meet City of Newton's electrification goals.
- Lighting fixtures and ceilings have been updated with lighting controls.
- Exterior of modular classrooms shows signs of wear.
- Corridor floors appear updated within last 10-15 years.
- Relieving angles at window heads in exterior masonry show signs of rust.
- Gym floor show signs of wear, HVAC ductwork is at end of life.
- Guardrails at stairs have openings larger than 4" sphere rule.
- LULA lift at auditorium stage.
- Some evidence of roof leaks in ceilings observed.



Bowen Elementary

Est. Repair Cost by System/Category

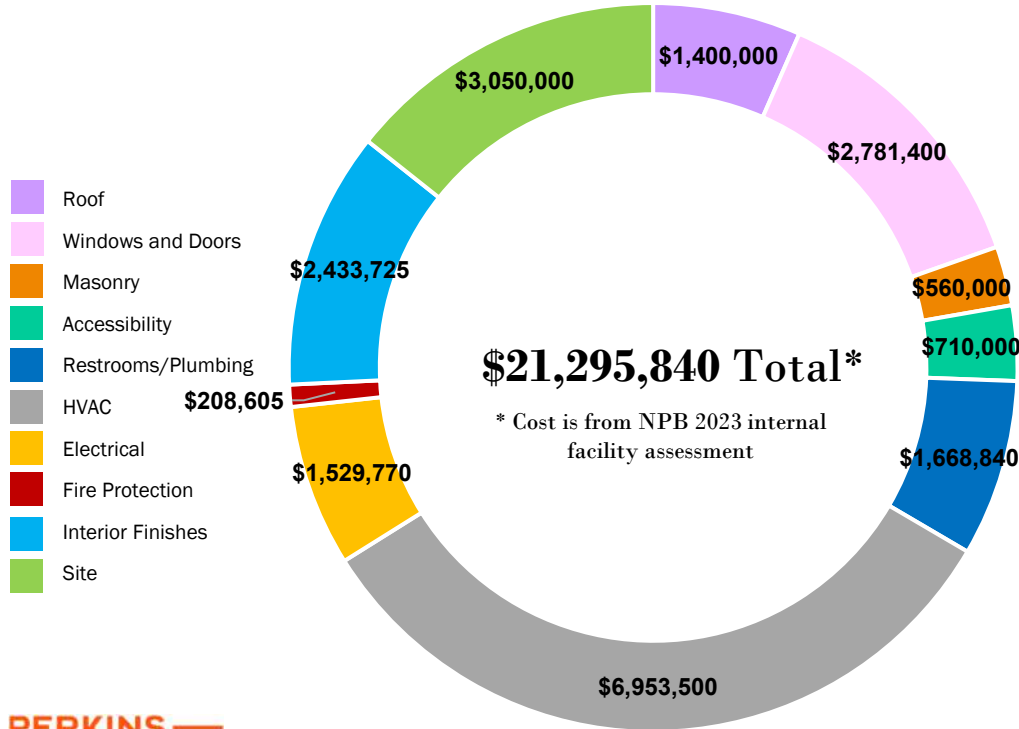

This scope of work and corresponding cost address only building systems and site improvements.

It does not address the lack of program space, appropriately sized spaces, and adjacencies that exist today and that are commonly provided in 21st schools.

Burr Elementary

Site Context & Access



60
Parking Spaces
(includes 2 at receiving)

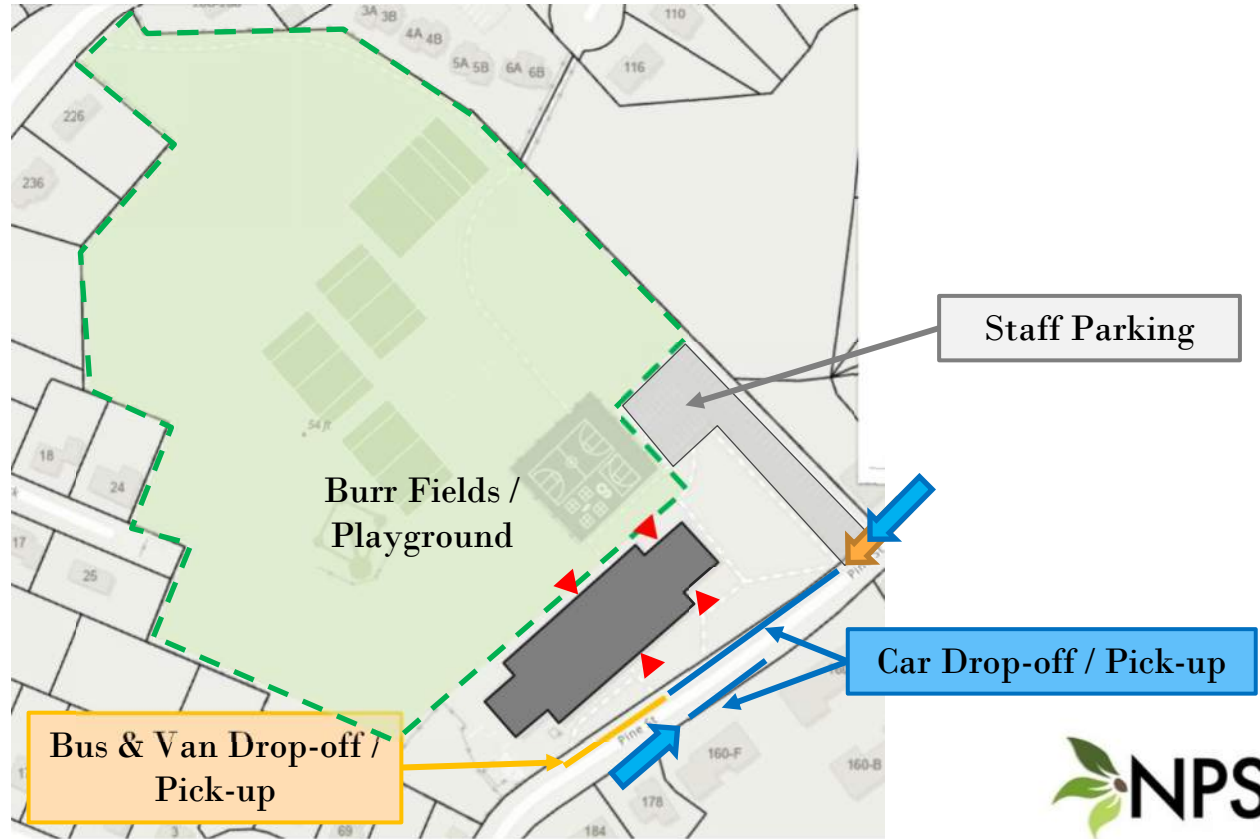

Burr Elementary Site Conditions

- Car, bus & van drop-off / pick-up are on street.
- Sidewalks need replacement.
- Driveways, parking, basketball courts need repaving.
- Accessibility limited at playground due to raised edging.
- Site lighting mounted to building needs replacement.
- Accessibility challenges between parking and building access points.
- Softball field needs infield replacement.
- Lawns need to be re-established.



Burr Elementary Building Conditions

- Roof features newer membrane roof and older tar/gravel ballast, reaching end of useful life.
- 2011 windows are in good condition, but would not meet current energy codes.
- Accessibility challenges with door hardware, classroom sinks, toilet rooms, music loft
- Boilers upgraded in 1999 and 2006, but do not meet the City of Newton's electrification goals.
- HVAC system, generator, electrical, plumbing systems at end of life.
- Some ceiling light fixtures have been updated, other ceilings need replacement.



Burr Elementary

Est. Repair Cost by System/Category

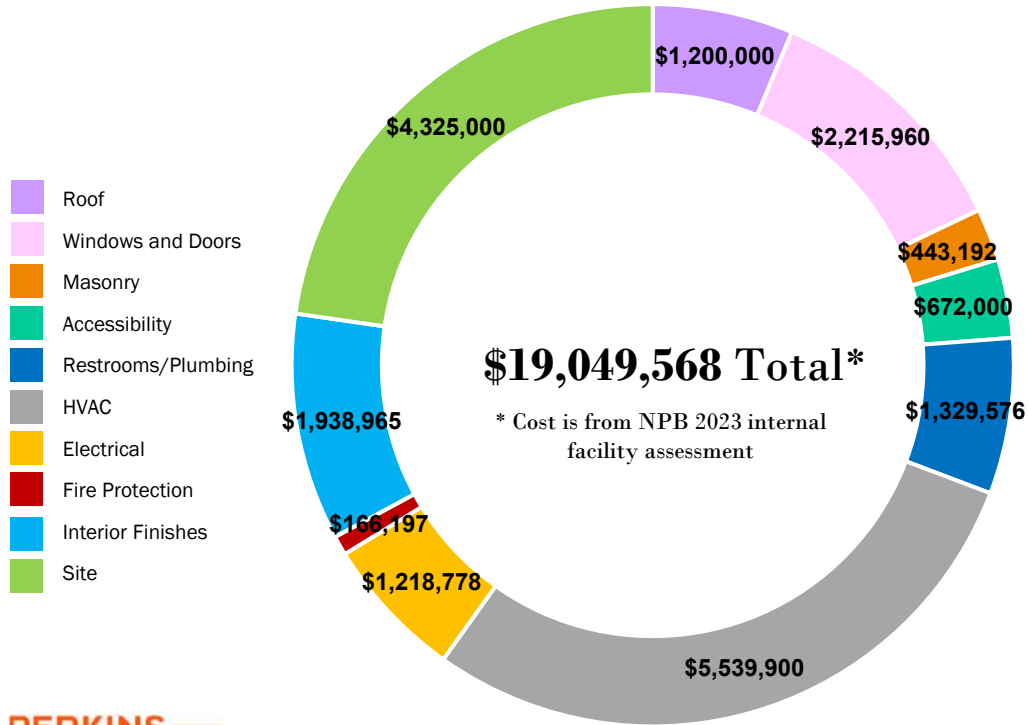

This scope of work and corresponding cost address only building systems and site improvements.

It does not address the lack of program space, appropriately sized spaces, and adjacencies that exist today and that are commonly provided in 21st schools.

Mason-Rice Elementary

Site Context & Access

Cochituate Aqueduct
Right of Way (ROW)

Hammond Brook
Floodplain &
Wetland Buffer, River
Protection Area

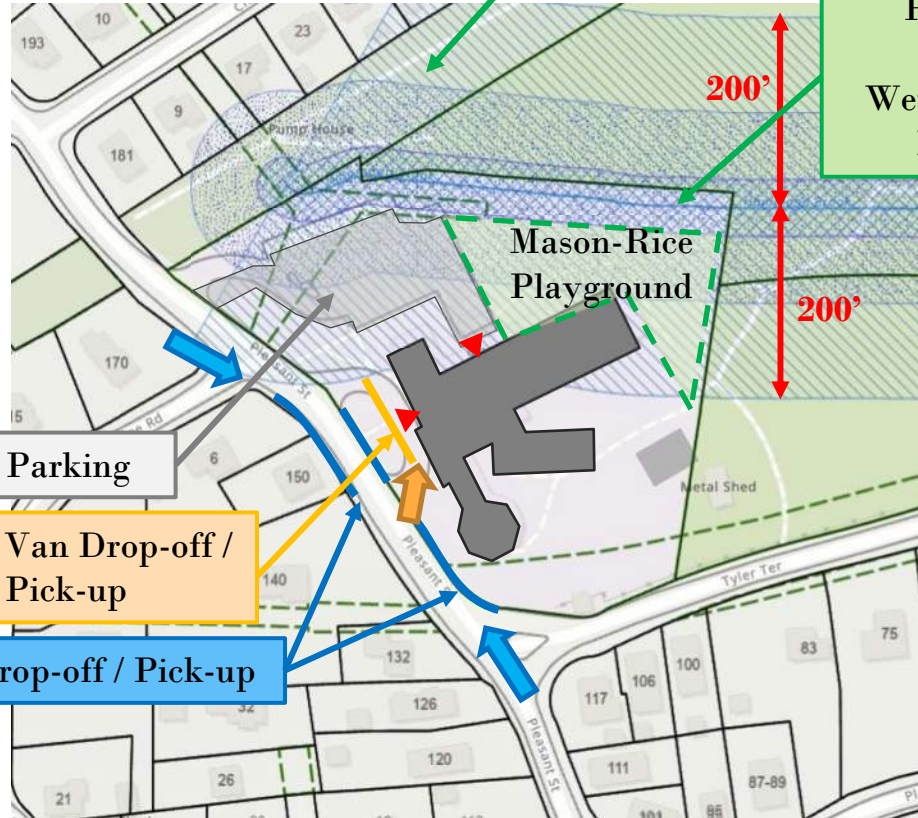
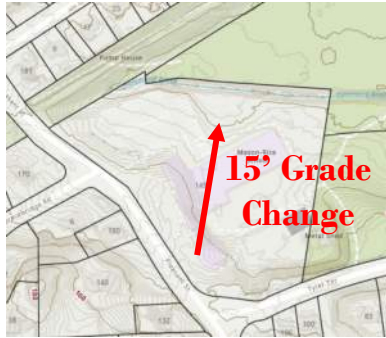

Staff Parking

Bus & Van Drop-off /
Pick-up

Car Drop-off / Pick-up

73
Parking Spaces

Mason-Rice Elementary Site Conditions

- Property borders ROWs, easements, and Hammond Brook.
- Several wetland and RPA setbacks overlay on a portion of the site and building.
- Site slopes make accessible routes a challenge at certain paths and sidewalks.
- Playgrounds are accessible.
- Ponding/standing water seen near the art rooms at the base of the exterior wall.
- Car drop-off / pick-up is on street, bus & van at bus loop.



Mason-Rice Elementary Building Conditions

- Boilers, expansion tanks have been upgraded (2013), but do not meet City of Newton's electrification goals.
- Accessibility within cafeteria/auditorium has been improved with floor leveling.
- No elevator, accessibility to lower floor from upper floor is provided by LULA lift only.
- Accessibility challenges at toilet rooms.
- Ceilings and lighting upgraded in certain spaces, other classrooms have original ceilings and older lighting.
- Roof leaks at gymnasium and some classrooms.
- Some cracking in masonry at exterior, area grates show signs of rust.
- 2007 windows are in good condition, but nearing end of life and would not meet current energy codes.



Mason-Rice Elementary

Est. Repair Cost by System/Category

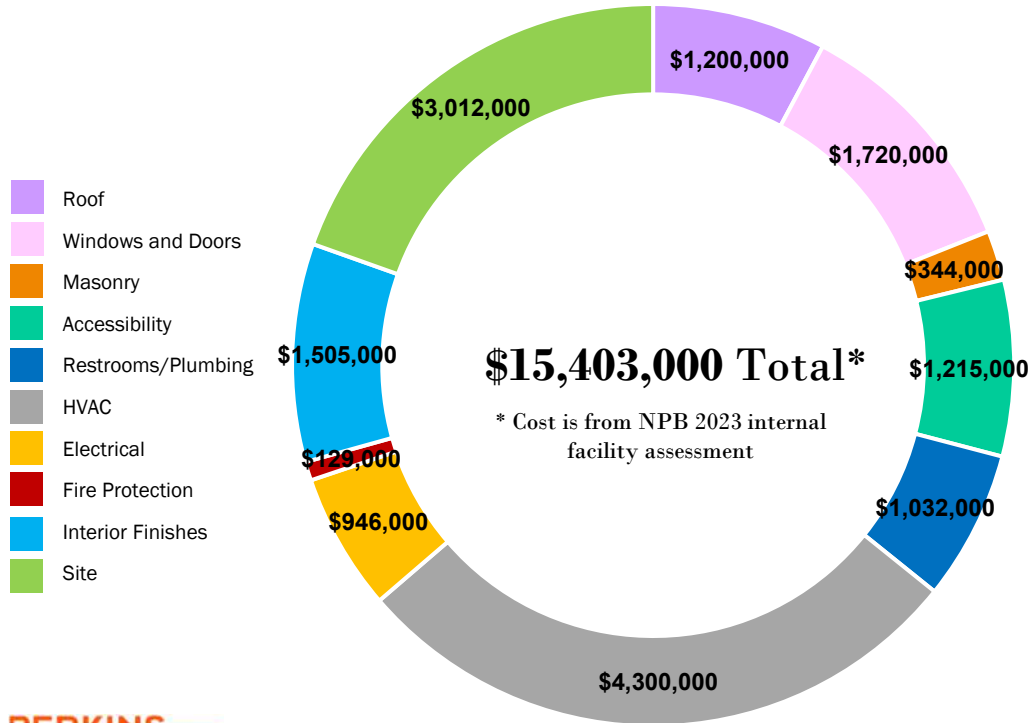

This scope of work and corresponding cost address only building systems and site improvements.

It does not address the lack of program space, appropriately sized spaces, and adjacencies that exist today and that are commonly provided in 21st schools.

Memorial-Spaulding Elementary

Site Context & Access

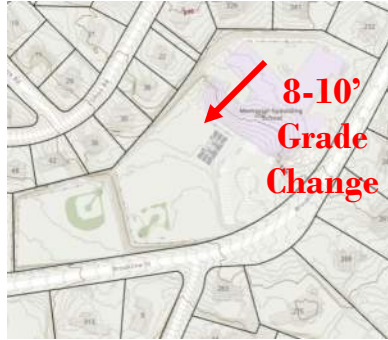

56
Parking Spaces

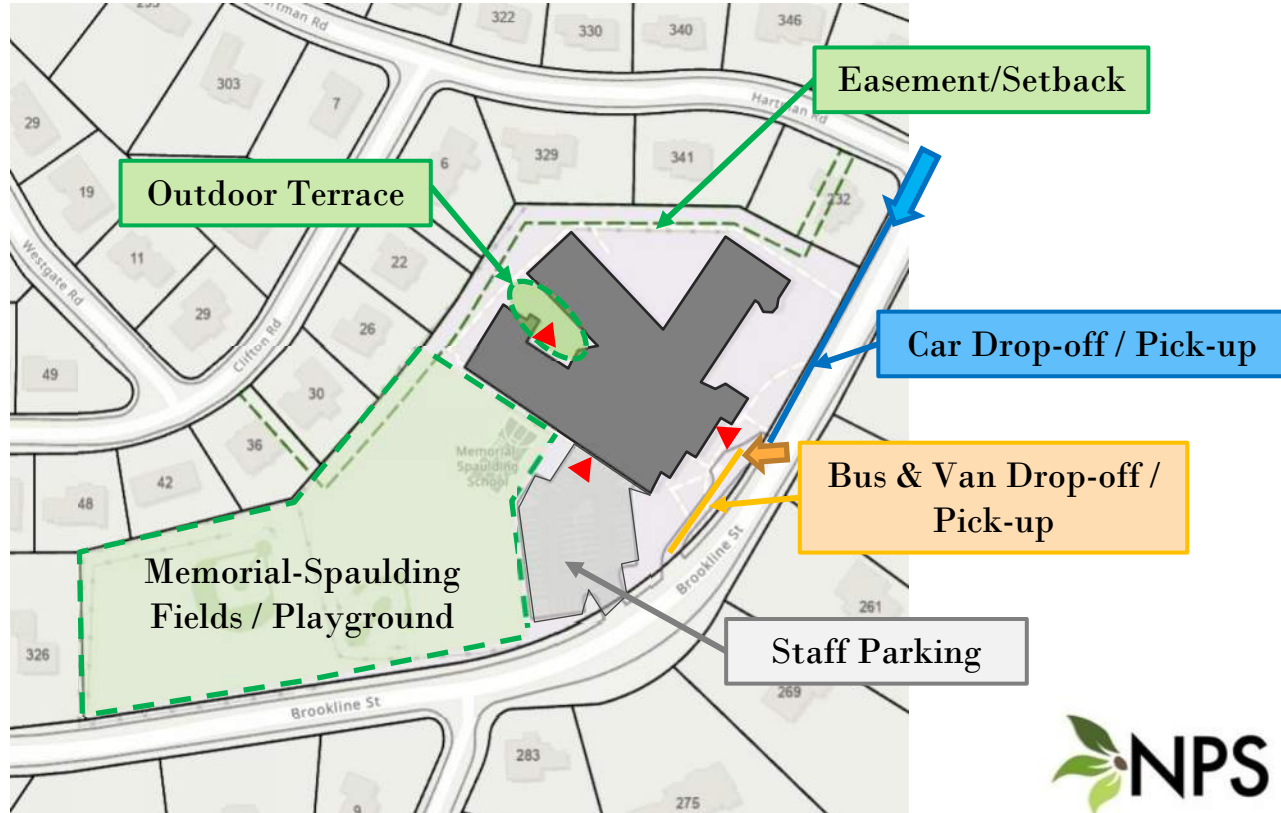

Memorial-Spaulding Elem. Site Conditions

- Car drop-off / pick-up is on street, bus & van at bus loop.
- Limited accessibility to outdoor terrace (accessible route is from front of building, direct access has stairs).
- Sidewalks/terrace need replacement, large cracks.
- Exterior stairs at kitchen need replacement.



Memorial-Spaulding Elem. Building Conditions

- One boiler is original, the other was replaced in 2006, but neither meets City of Newton electrification goals.
- 2001 windows are in fair condition, but nearing end of life and would not meet current energy codes.
- Curtain wall between original and first addition shows signs of rust.
- LULA lift at auditorium stage.
- Ceilings are updated with new lighting fixtures at most classrooms, other classrooms have exposed structure in lower level.
- Photovoltaics are installed on the roof.



Memorial-Spaulding Elem.

Est. Repair Cost by System/Category

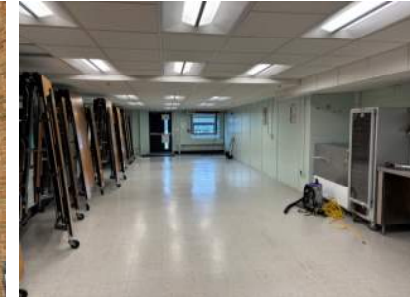
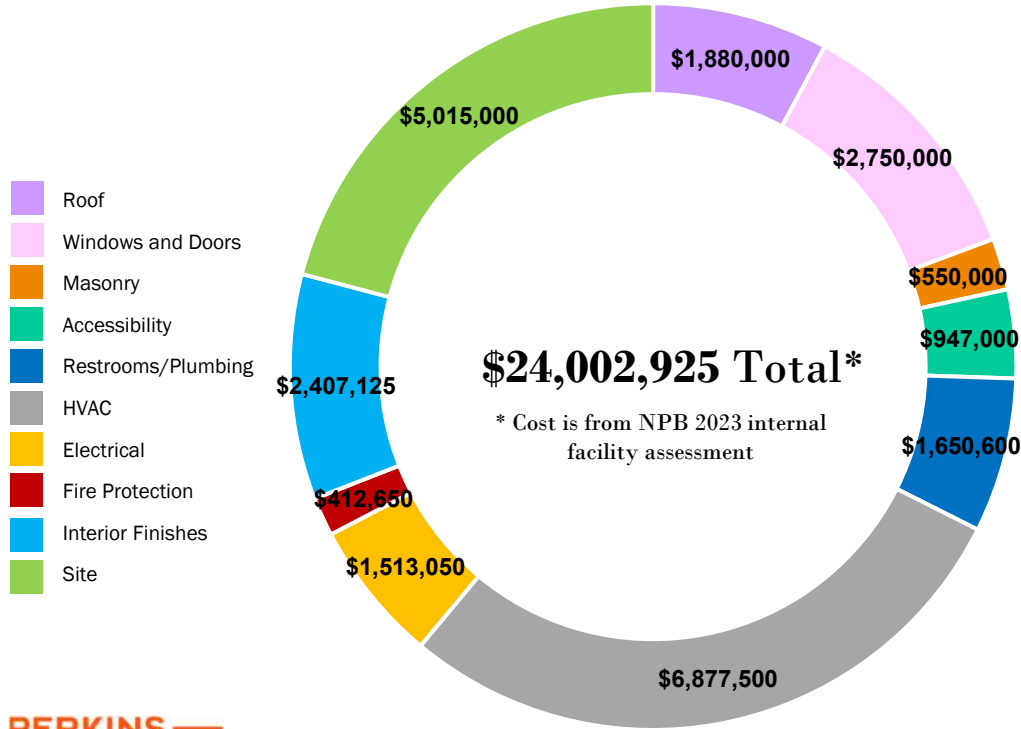

This scope of work and corresponding cost address only building systems and site improvements.

It does not address the lack of program space, appropriately sized spaces, and adjacencies that exist today and that are commonly provided in 21st schools.

Underwood Elementary

Site Context & Access

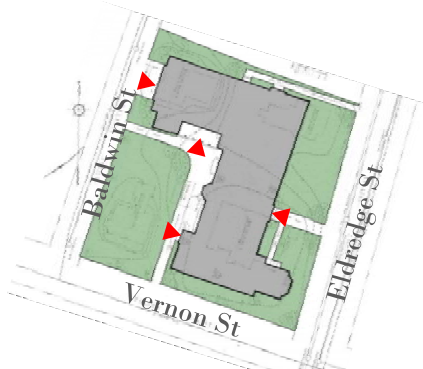

Original 1924 site plan

19
Parking Spaces

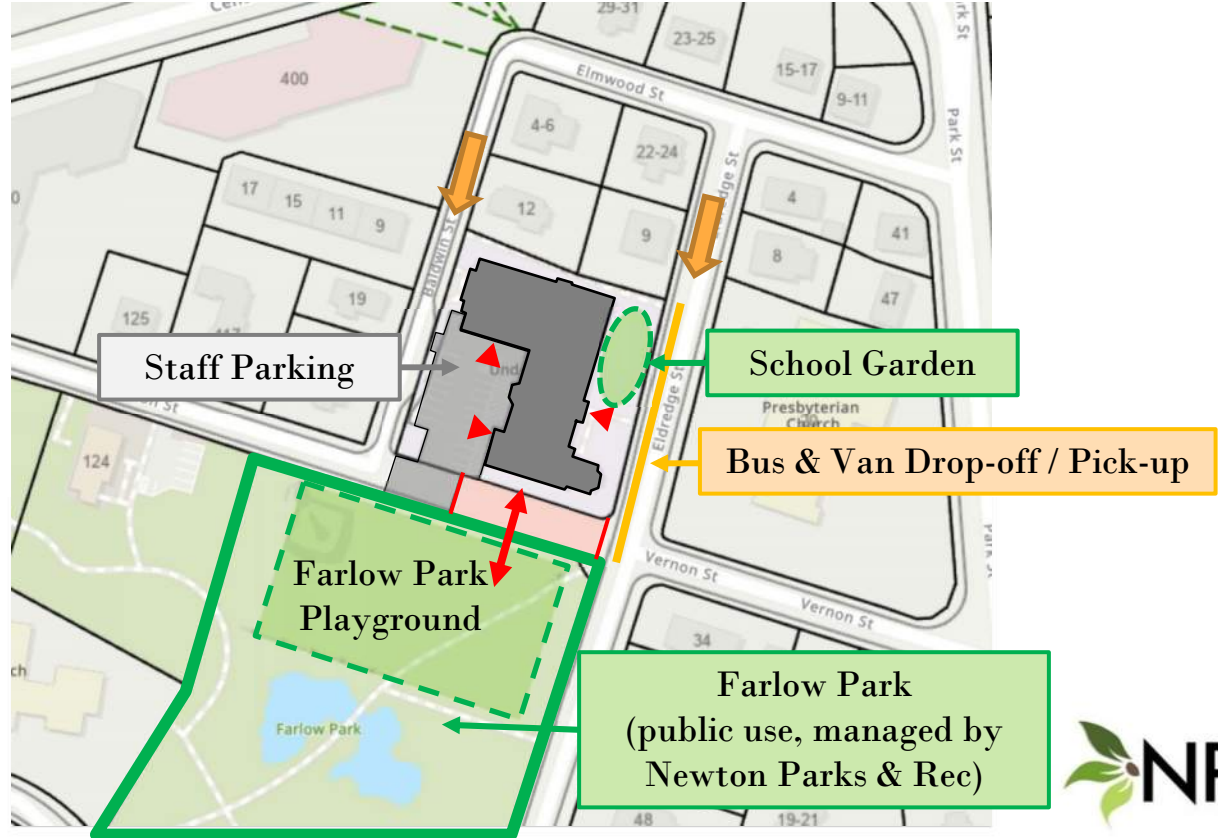

Underwood Elementary Site Conditions

- 1 acre site, building footprint is $\frac{3}{4}$ of site, parking about $\frac{1}{4}$.
- Located within NRHP* Farlow & Kenrick Park Historic District.
- School does not have dedicated play space, shares Farlow Park playground with public.
- Part of Vernon Street permanently closed for easier access, additional parking.
- Main entrance on Eldredge St, accessibility challenges at most access points to building due to half level between lower and main floors.
- Car, bus & van drop-off / pick-up are on street.

*National Register of Historic Places



Underwood Elementary Building Conditions

- Accessibility challenges at toilet rooms (both gang and single user), classroom entries, stairs, music, and multi-level library.
- Evidence of roof leaks in ceilings, esp. at gymnasium.
- Signs of rust on stair finishes and under carriages.
- HVAC systems are at end of life, steam piping has failed previously at gym.
- Main electrical is old and limited, especially for future upgrades, no sprinkler system.
- Casework original to 1978 renovation, some not accessible.
- Some lighting updated with lighting control, other ceilings are in need of replacement.
- Roof at gym needs replacement, some cracking at masonry.



Underwood Elementary

Est. Repair Cost by System/Category

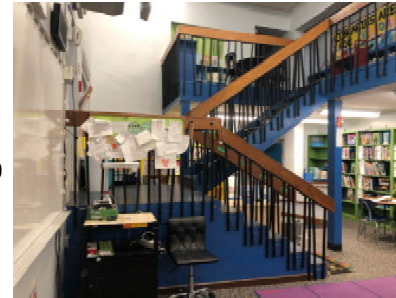
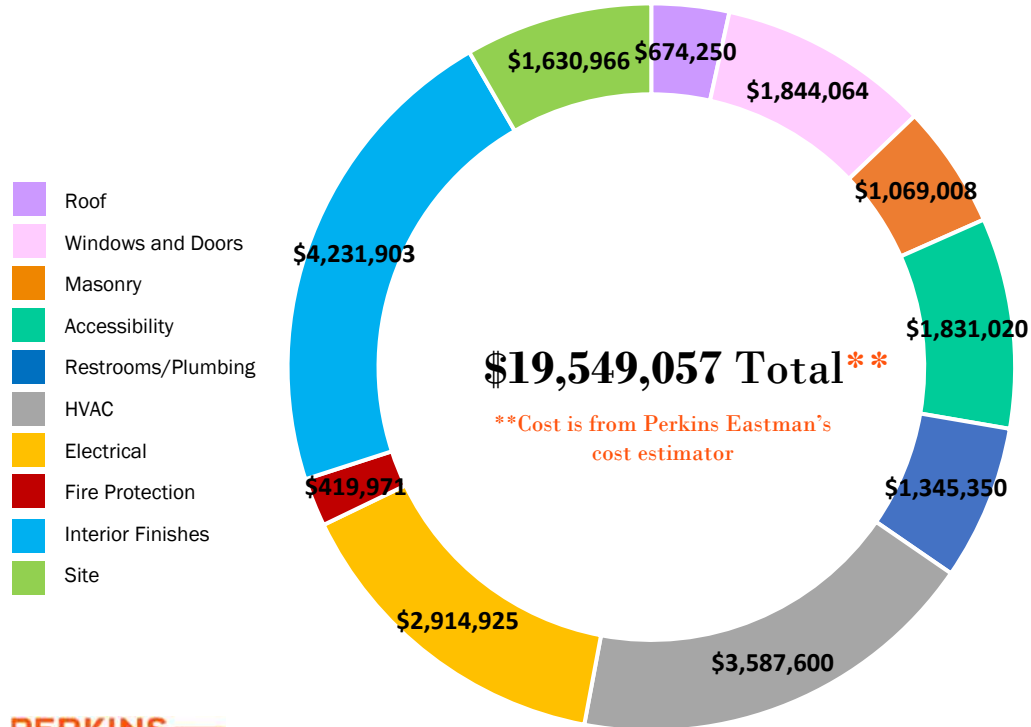

This scope of work and corresponding cost address only building systems and site improvements.

It does not address the lack of program space, appropriately sized spaces, and adjacencies that exist today and that are commonly provided in 21st schools.

Ward Elementary Site Context & Access

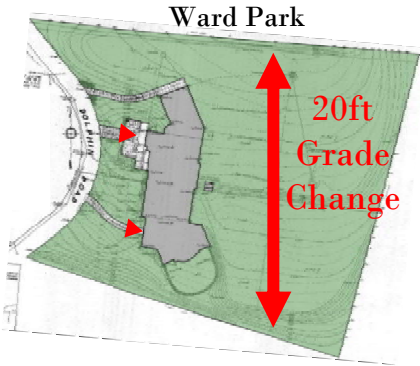

Original 1928 site plan

40
Parking Spaces

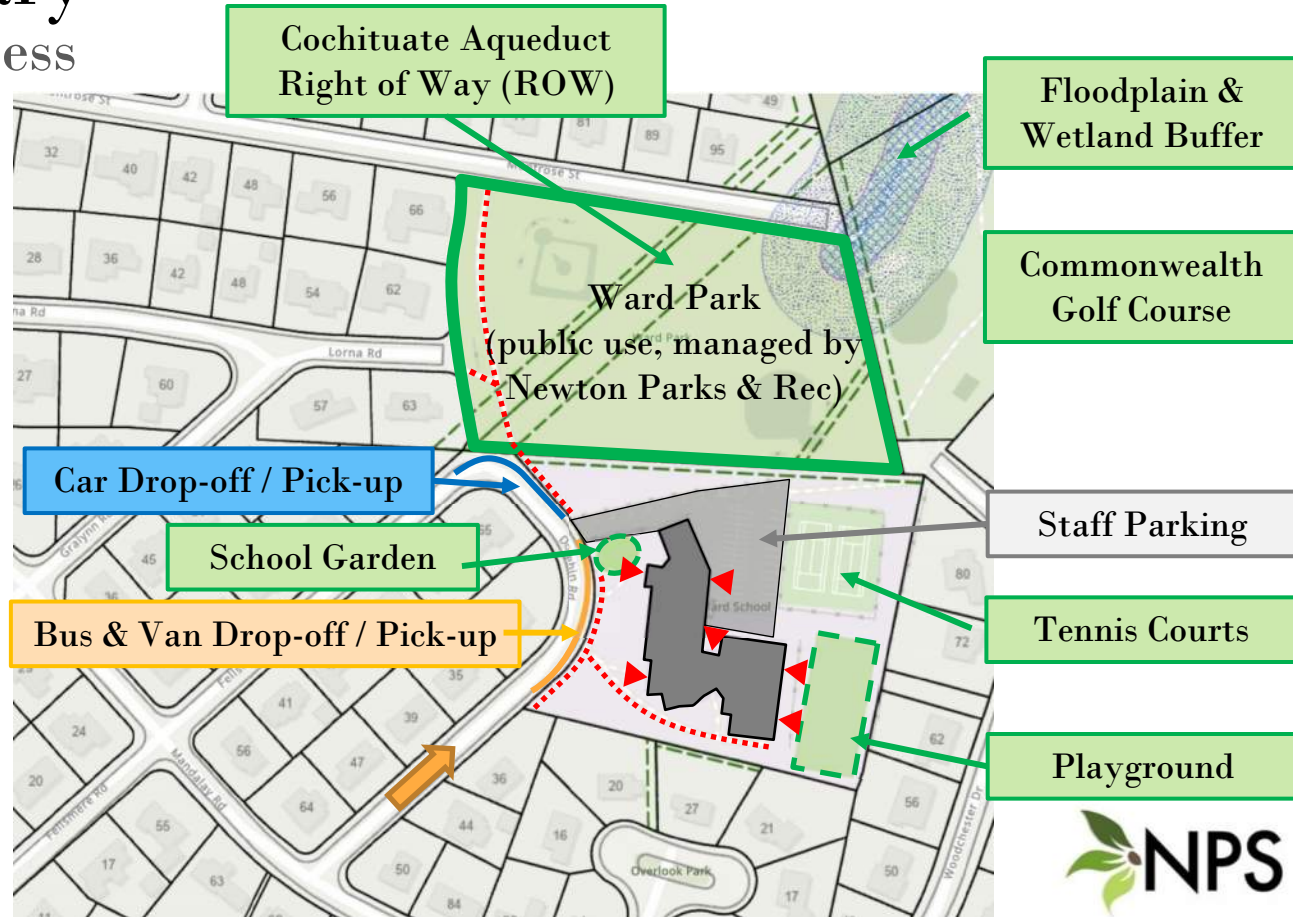
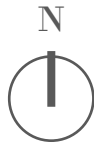

Ward Elementary Site Conditions

- 3 acre hillside site, with 3.5 acre public use Ward Park to north deed restricted, protected by Article 97.
- School has dedicated playground and tennis courts, both are maintained by Newton Parks & Rec, controlled by NPS.
- Main entrance on Dolphin Road, one way street in residential neighborhood.
- Easements at the edge of property, ROW within park.
- Parking lot has been repaved and restriped.
- Car, bus & van drop-off / pick-up are on street.



Ward Elementary Building Conditions

- There is no elevator – first, second, and library floors are inaccessible, one accessible entrance remote from main office near gym, but no direct accessible route.
- Accessibility challenges at toilet rooms, staff lunch, lower level, main entrance.
- Evidence of roof leaks in ceilings.
- Floor, wall, and ceiling finishes at end of life, but some ceilings/lighting have been replaced in the last few years.
- One of two steam boilers is non-functional.
- Main electrical is old and limited, especially for future upgrades, no sprinkler system.
- Most built in casework is original, hardware not operable.
- Slate roof shows advanced age, windows need replacement, masonry needs repointing.



Ward Elementary

Est. Repair Cost by System/Category

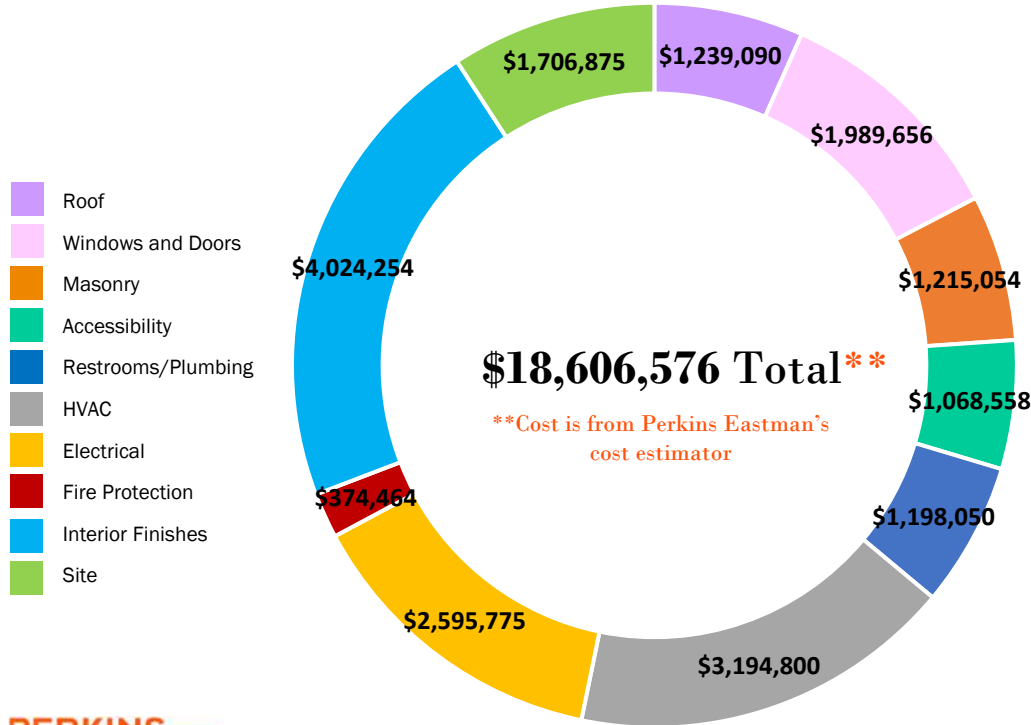

This scope of work and corresponding cost address only building systems and site improvements.

It does not address the lack of program space, appropriately sized spaces, and adjacencies that exist today and that are commonly provided in 21st schools.

Williams Elementary

Site Context & Access

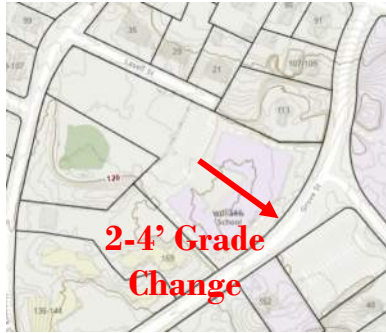

35
Parking Spaces

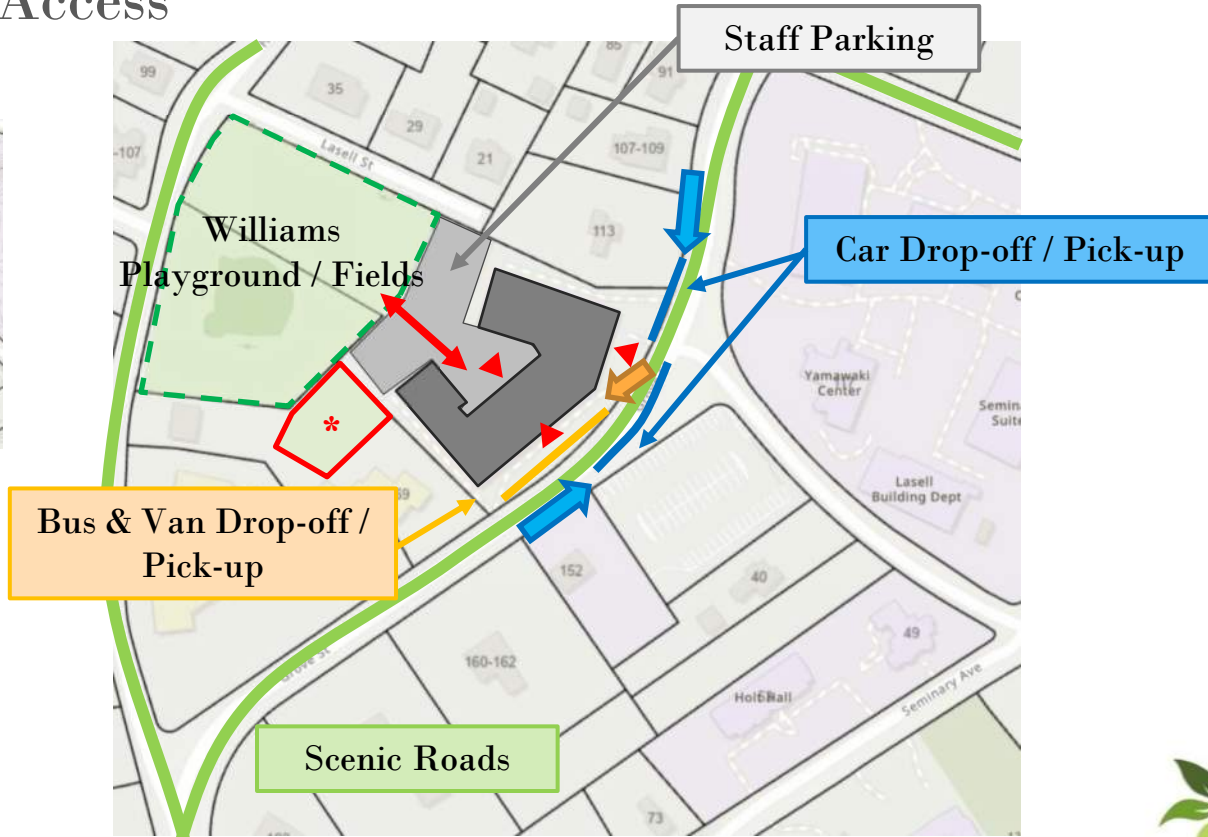

Williams Elementary

Site Conditions

- Car drop-off / pick-up is on street, bus & van at bus loop.
- Playgrounds are not accessible with raised edging.
- Parking area needs to be repaved, access to playground/fields from school is through parking.
- Basketball court is within parking area, no separation.
- Site lighting mounted to building needs replacement.
- Sidewalks need repair.
- Property has been acquired by City of Newton west of building for school use.



Williams Elementary Building Conditions

- 1993 & 2001 windows are in fair condition but nearing end of life and would not meet current energy codes.
- Cafeteria and kitchen spaces converted from classroom spaces, do not function well for current day use.
- Accessibility challenges at classroom entries.
- Roof features newer EPDM and older tar/gravel ballast, reaching end of useful life.
- Evidence of roof leaks in ceilings, esp. at auditorium.
- HVAC system at end of life.
- Insufficient power/data outlets in classrooms/support spaces.
- Masonry needs repair and cleaning.
- Boilers upgrades in 2012, but do not meet City of Newton's electrification goals.



Williams Elementary

Est. Repair Cost by System/Category

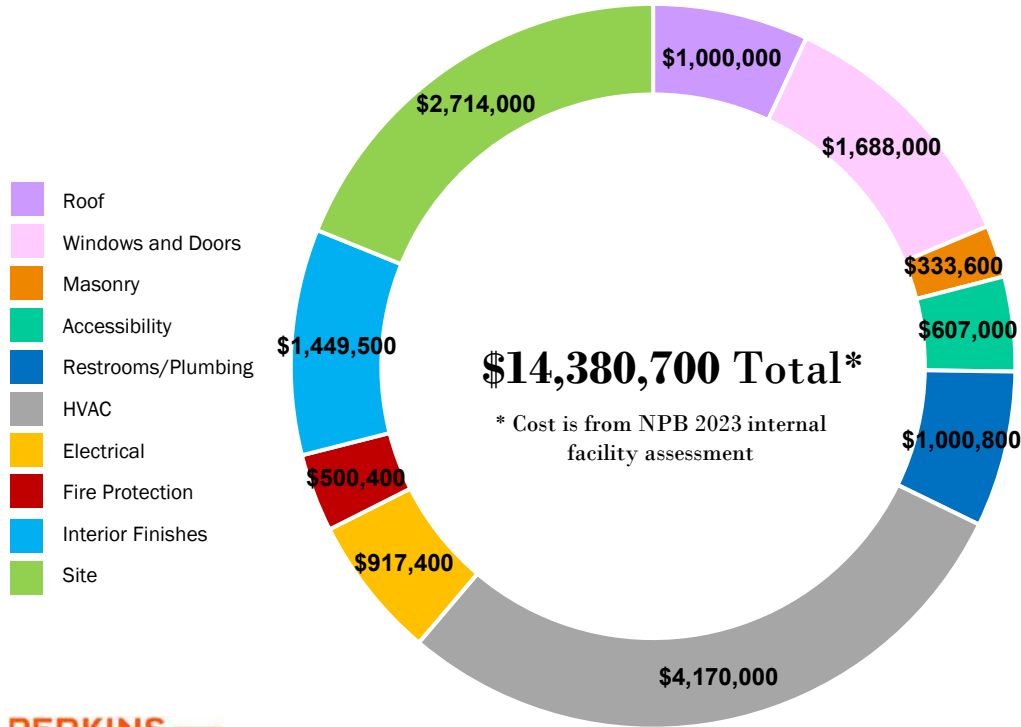

This scope of work and corresponding cost address only building systems and site improvements.

It does not address the lack of program space, appropriately sized spaces, and adjacencies that exist today and that are commonly provided in 21st schools.