

# NPS District Study

Bowen, Burr, Mason-Rice, Memorial-Spaulding, Pierce,  
& Williams, Elementary Schools

January 22, 2024



# Existing Spaces

## Bowen – Lower Floor

- General Education Classroom
- General Education Support Spaces
- Special Education
- Music, Arts & Phys Ed
- Media Center/Library
- Dining & Food Service
- Admin & Guidance
- Extended Day
- Cust, Maint, & Toilets
- Circulation, Stair, Lift

- ASP** – AFTER SCHOOL PROGRAM
- BCBA** – BEHAVIOR ANALYST
- B.O.** – BREAK-OUT / SMALL GROUP
- C / CUST** – CUSTODIAL
- CAF** – CAFETERIA
- CR** – CLASSROOM
- ELL** – ENGLISH LANGUAGE LEARNER
- K** – KINDERGARTEN
- LIT** – LITERACY
- MECH/MDF** – MECHANICAL/ELECTRICAL
- O / OFF** – OFFICE
- OT** – OCCUPATIONAL THERAPY
- PSY** – PSYCHOLOGIST
- S / STOR** – STORAGE
- SEL** – SOCIAL-EMOTIONAL LEARNING
- SET** – SPECIAL EDUCATION TEACHING
- SPCH** – SPEECH & LANGUAGE
- SW / SOC** – SOCIAL WORKER
- T** – TOILET
- TM** – TEAM SPECIALIST

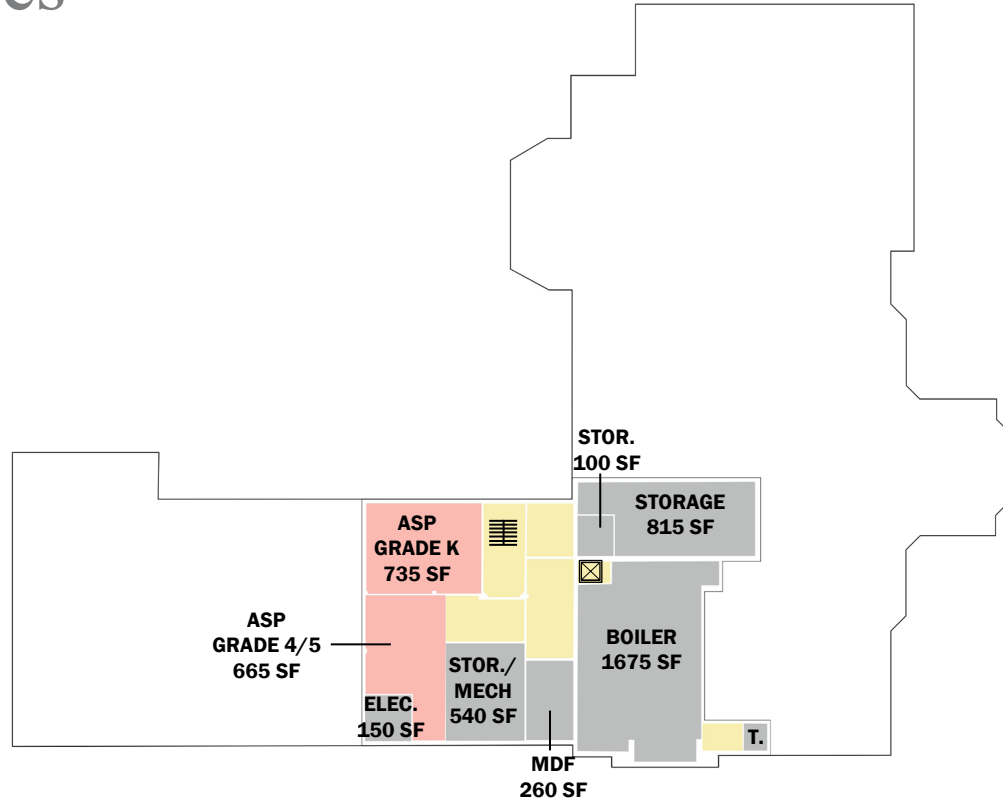

**UPPER FLOOR 20,980 GSF**  
**MAIN FLOOR 29,610 GSF**  
**MODULARS 3,870 GSF**  
**LOWER FLOOR 6,970 GSF**  
**61,430 GSF**



# Existing Spaces

## Bowen – Upper Floor

- General Education Classroom
- General Education Support Spaces
- Special Education
- Music, Arts & Phys Ed
- Media Center/Library
- Dining & Food Service
- Admin & Guidance
- Extended Day
- Cust, Maint, & Toilets
- Circulation, Stair, Lift

- ASP – AFTER SCHOOL PROGRAM
- BCBA – BEHAVIOR ANALYST
- B.O. – BREAK-OUT / SMALL GROUP
- C / CUST – CUSTODIAL
- CAF – CAFETERIA
- CR – CLASSROOM
- ELL – ENGLISH LANGUAGE LEARNER
- K – KINDERGARTEN
- LIT – LITERACY
- MECH/MDF – MECHANICAL/ELECTRICAL
- O / OFF – OFFICE
- OT – OCCUPATIONAL THERAPY
- PSY – PSYCHOLOGIST
- S / STOR – STORAGE
- SEL – SOCIAL-EMOTIONAL LEARNING
- SP.ED.TCH – SPECIAL EDUCATION TEACHING
- SPCH – SPEECH & LANGUAGE
- SW / SOC – SOCIAL WORKER
- T – TOILET
- TM – TEAM SPECIALIST

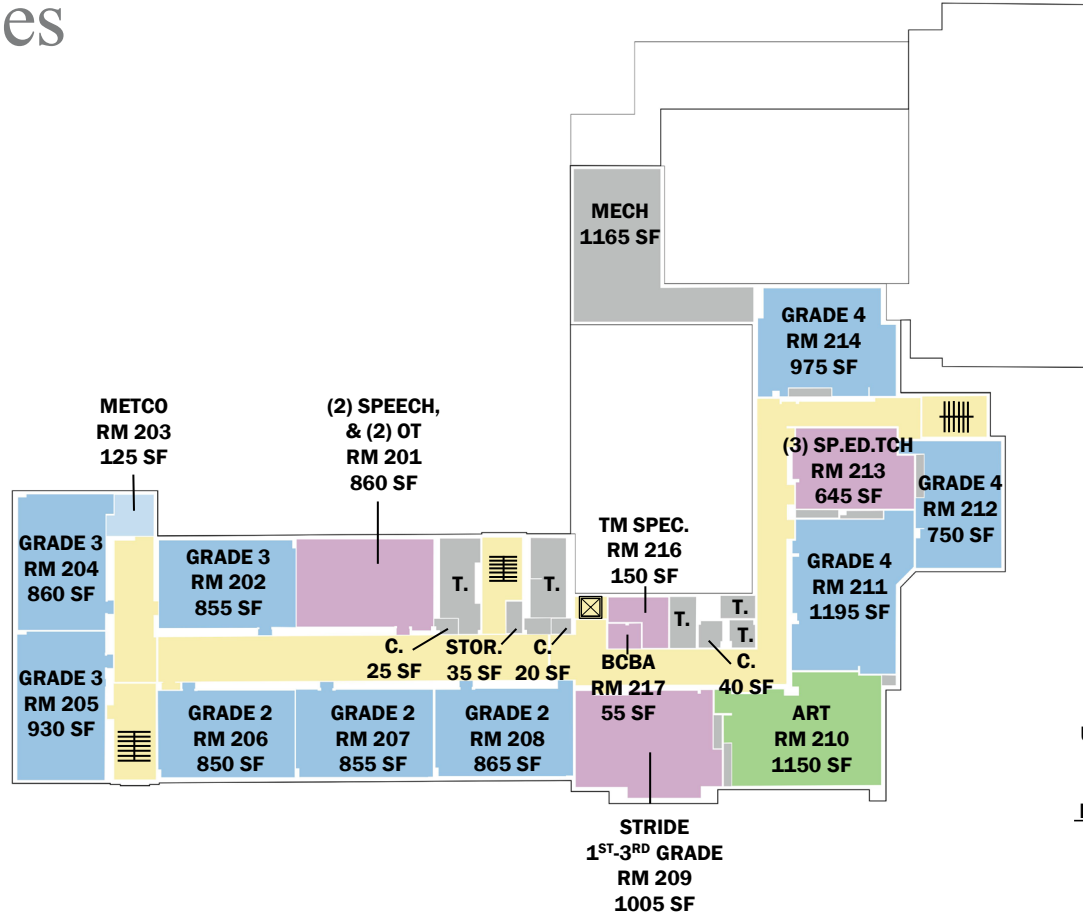

UPPER FLOOR 20,980 GSF  
 MAIN FLOOR 29,610 GSF  
 MODULARS 3,870 GSF  
 LOWER FLOOR 6,970 GSF  
**61,430 GSF**



# Educational Space Assessment

## Bowen

Core Academic Spaces	Min. Size (sf) Guidelines*	Existing Avg. (sf)	Size (sf) vs Guidelines*	Count of Spaces	FY 2024 Enrollment	Class Size Avg. (stu's)	Design Enrollment (Seats)**	CR Seat Utilization
Kindergarten	1100	850	77%	3	51	17	66	77.3%
1-2 Classrooms	900	886	98%	6	122	20	132	92.1%
3-5 Classrooms				6	182	20	216	84.4%
3-5 Modulars				3				
<b>Subtotals</b>				<b>18</b>	<b>355</b>		<b>414</b>	<b>85.7%</b>

\*Minimum room sizes per NPS Educ-Program \*\*Seats based on class size targets (22 stu/room K-2, 24 stu/room 3-5)

Related Arts Spaces	Min. Size (sf) Guidelines*	Existing Size (sf)	Size (sf) vs Guidelines*	Count of Spaces	Classes/Week	Minutes/Class	Avail. Time Slots/Wk	Functional Utilization
Art	1000	1150	115%	1	18	55	30	60.0%
Music (stage)	1200	725	60%	1	18	30	50	36.0%
Gym Stations	3000	2790	93%	1	36	30	50	72.0%
Media/Library	2533	1525	60%	1	18	35	45	40.0%

\*Media/Library size guidelines = 2020sf for enrollments up to 300 students and 4.5sf for each student over 300

Dining & Food Service	Size (sf) Guidelines*	Existing Size (sf)	Adjust (sf)* per Lunches	Count of Spaces	Lunch Periods	Design Enroll.	Enrollment Supported	Functional Utilization
Cafeteria	3105	1090	2070	1	3	414	218	162.8%
			1553	1	4		291	122.1%
			1242	1	5		363	97.7%
			1035	1	6		436	81.4%
Kitchen	1460	330	n/a	1	n/a			

\*Cafeteria size guidelines = 15sf per student enrollment divided by lunch periods. Guidelines default to 2 periods

## Classroom Size (sf) vs Guidelines

Kindergarten

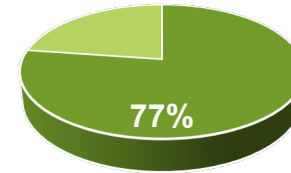

Grade 1-5 Classrooms



## Shared Spaces & Missing Spaces

vs NPS Educational Program (at 18 Classrooms)

- (6) Lit/Math in 1 Room
- (3) Sp. Educ. in 1 Room
- (2) OT/PT with Speech
- Music Uses the Stage
- Break-Out Space per Grade
- Separate OT/PT Office
- Art Workroom/Storage
- Music Practice

## Other Spaces

- + 2 District-Wide Sp.Ed CRs
- + Auditorium
- + ASP Specific Rooms

- Gym Office/Storage
- Chair/Table Storage
- Records/Storage Room
- Conference Room
- Nursing (Lactation Room)

# Educational Space Assessment

Burr

Core Academic Spaces	Min. Size (sf) Guidelines*	Existing Avg. (sf)	Size (sf) vs Guidelines*	Count of Spaces	FY 2024 Enrollment	Class Size Avg. (stu's)	Design Enrollment (Seats)**	CR Seat Utilization
Kindergarten	1100	1005	91%	1	18	18	22	81.8%
K Modulares		1148	104%	2	36	18	44	81.8%
1-2 Classrooms	900	994	110%	6	120	20	132	91.2%
3-5 Classrooms				9	181	20	216	83.6%
<b>Subtotals</b>				<b>18</b>	<b>355</b>		<b>414</b>	<b>85.7%</b>

\*Minimum room sizes per NPS Educ-Program \*\*Seats based on class size targets (22 stu/room K-2, 24 stu/room 3-5)

Related Arts Spaces	Min. Size (sf) Guidelines*	Existing Size (sf)	Size (sf) vs Guidelines*	Count of Spaces	Classes/Week	Minutes/Class	Avail. Time Slots/Wk	Functional Utilization
Art	1000	875	88%	1	18	55	30	60.0%
Music	1200	1025	85%	1	18	30	50	36.0%
Gym Stations	3000	3865	129%	1	36	30	50	72.0%
Media/Library	2533	1240	49%	1	18	35	45	40.0%

\*Media/Library size guidelines = 2020sf for enrollments up to 300 students and 4.5sf for each student over 300

Dining & Food Service	Min. Size (sf) Guidelines*	Existing Size (sf)	Adjust (sf)* per Lunches	Count of Spaces	Lunch Periods	Design Enroll.	Enrollment Supported	Functional Utilization
Cafeteria	3105	3685	2070	1	3	414	737	48.2%
			1553	1	4		983	36.1%
			1242	1	5		1228	28.9%
			1035	1	6		1474	24.1%
Kitchen	1460	310	n/a	1	n/a			

\*Cafeteria size guidelines = 15sf per student enrollment divided by lunch periods. Guidelines default to 2 periods

## Classroom Size (sf) vs Guidelines

Kindergarten

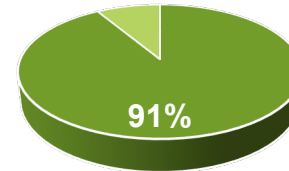

Grade 1-5 Classrooms



**110%** (994 of 900sf)  
3 K Modulares at 1148sf

## Shared Spaces & Missing Spaces

vs NPS Educational Program (at 18 Classrooms)

- (5) Lit. in 1 Room
- (5) Special Educ, (1) OT, (2) ELL, SEL & BCBA share 2 Rooms
- Break-Out Space per Grade
- Separate OT/PT Office
- Art Workroom/Storage
- Music Practice

## Other Spaces

+ District Storage

- Chair/Table Storage
- Records/Storage Room
- Nursing (Lactation Room)

# Educational Space Assessment

## Mason Rice

Core Academic Spaces	Min. Size (sf) Guidelines*	Existing Avg. (sf)	Size (sf) vs Guidelines*	Count of Spaces	FY 2024 Enrollment	Class Size Avg. (stu's)	Design Enrollment (Seats)**	CR Seat Utilization
Kindergarten	1100	882	80%	3	40	13	66	60.6%
1-2 Classrooms	900	906	101%	6	118	20	132	89.1%
3-5 Classrooms			101%	6	176	20	216	81.7%
3-5 Modulares		99%	3					
<b>Subtotals</b>				<b>18</b>	<b>334</b>		<b>414</b>	<b>80.7%</b>

\*Minimum room sizes per NPS Educ-Program \*\*Seats based on class size targets (22 stu/room K-2, 24 stu/room 3-5)

Related Arts Spaces	Min. Size (sf) Guidelines*	Existing Size (sf)	Size (sf) vs Guidelines*	Count of Spaces	Classes/Week	Minutes/Class	Avail. Time Slots/Wk	Functional Utilization
Art	1000	1195	120%	1	18	55	30	60.0%
Music	1200	980	82%	1	18	30	50	36.0%
Gym Stations	3000	2360	79%	1	36	30	50	72.0%
Media/Library	2533	1200	47%	1	18	35	45	40.0%

\*Media/Library size guidelines = 2020sf for enrollments up to 300 students and 4.5sf for each student over 300

Dining & Food Service	Min. Size (sf) Guidelines*	Existing Size (sf)	Adjust (sf)* per Lunches	Count of Spaces	Lunch Periods	Design Enroll.	Enrollment Supported	Functional Utilization
Cafeteria	3105	2260	2070	1	3	414	452	73.9%
			1553	1	4		603	55.4%
			1242	1	5		753	44.3%
			1035	1	6		904	36.9%
Kitchen	1460	425	n/a	1	n/a			

\*Cafeteria size guidelines = 15sf per student enrollment divided by lunch periods. Guidelines default to 2 periods

## Classroom Size (sf) vs Guidelines

Kindergarten

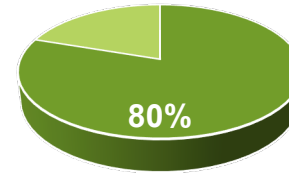

Grade 1-5 Classrooms



**101%** (906 of 900sf)  
3 Modulares at 890sf

## Shared Spaces & Missing Spaces

vs NPS Educational Program (at 18 Classrooms)

- (5) Lit. in 1 Room
- (2) Math in Small Office
- (2) ELL in Small Office
- (5) Sp. Educ & BCBA share 2 Rooms
- OT Shares a Room with Soc Work & (2) Speech
- Break-Out Space per Grade
- Separate OT/PT Office
- Art Workroom/Storage
- Music Practice
- Gym Office/Storage
- Cafeteria (uses gym)
- Chair/Table Storage
- Copy Room (in corridor)
- Conference Room

## Other Spaces

- + Auditorium
- + ASP Specific Space

# Educational Space Assessment

## Memorial-Spaulding

Core Academic Spaces	Min. Size (sf) Guidelines*	Existing Avg. (sf)	Size (sf) vs Guidelines*	Count of Spaces	FY 2024 Enrollment	Class Size Avg. (stu's)	Design Enrollment (Seats)**	CR Seat Utilization
Kindergarten	1100	1137	103%	3	46	15	66	69.7%
1-2 Classrooms	900	862	96%	7	129	18	154	83.9%
3-5 Classrooms			96%	9	194	22	216	89.7%
<b>Subtotals</b>				<b>19</b>	<b>369</b>		<b>436</b>	<b>84.6%</b>

\*Minimum room sizes per NPS Educ-Program \*\*Seats based on class size targets (22 stu/room K-2, 24 stu/room 3-5)

Related Arts Spaces	Min. Size (sf) Guidelines*	Existing Size (sf)	Size (sf) vs Guidelines*	Count of Spaces	Classes/Week	Minutes/Class	Avail. Time Slots/Wk	Functional Utilization
Art	1000	1360	136%	1	19	55	30	63.3%
Music (stage)	1200	705	59%	1	19	30	50	38.0%
Gym Stations	3000	2430	81%	1	38	30	50	76.0%
Media/Library	2632	2545	97%	1	19	35	45	42.2%

\*Media/Library size guidelines = 2020sf for enrollments up to 300 students and 4.5sf for each student over 300

Dining & Food Service	Min. Size (sf) Guidelines*	Existing Size (sf)	Adjust (sf)* per Lunches	Count of Spaces	Lunch Periods	Design Enroll.	Enrollment Supported	Functional Utilization
Cafeteria	3270	1105	2180	1	3	436	221	167.0%
			1635	1	4		295	125.2%
			1308	1	5		368	100.2%
			1090	1	6		442	83.5%
Kitchen	1460	300	n/a	1	n/a			

\*Cafeteria size guidelines = 15sf per student enrollment divided by lunch periods. Guidelines default to 2 periods

## Classroom Size (sf) vs Guidelines

Kindergarten

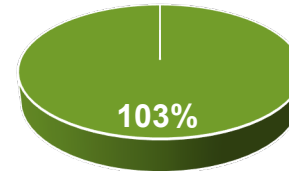

Grade 1-5 Classrooms



## Shared Spaces & Missing Spaces

vs NPS Educational Program (at 18 Classrooms)

- (9) Lit/Math & (2) ELL Share 2 Rooms
- BCBA & SEL in Sp. Ed.
- (2) OT/PT with Speech
- Music Uses the Stage
- Break-Out Space per Grade
- Separate OT/PT Office
- Chair/Table Storage
- Records/Storage Room
- Conference Room
- Nursing (Lactation Room)

## Other Spaces

- + Extra Music Room
- + Auditorium
- + ASP Specific Space

# Educational Space Assessment

## Peirce

Core Academic Spaces	Min. Size (sf) Guidelines*	Existing Avg. (sf)	Size (sf) vs Guidelines*	Count of Spaces	FY 2024 Enrollment	Class Size Avg. (stu/s)	Design Enrollment (Seats)**	CR Seat Utilization
Kindergarten	1100	1023	93%	2	36	18	44	81.8%
1-2 Classrooms	900	842	94%	4	80	20	88	90.9%
3-5 Classrooms			94%	5	120	17	168	71.4%
3-5 Modulars		830	92%	2				
<b>Subtotals</b>				<b>13</b>	<b>236</b>		<b>300</b>	<b>78.7%</b>

\*Minimum room sizes per NPS Educ-Program \*\*Seats based on class size targets (22 stu/room K-2, 24 stu/room 3-5)

Related Arts Spaces	Min. Size (sf) Guidelines*	Existing Size (sf)	Size (sf) vs Guidelines*	Count of Spaces	Classes/Week	Minutes/Class	Avail. Time Slots/Wk	Functional Utilization
Art	1000	865	87%	1	13	55	30	43.3%
Music (stage)	1200	620	52%	1	13	30	50	26.0%
Gym Stations	3000	2015	67%	1	26	30	50	52.0%
Media/Library	2020	990	49%	1	13	35	45	28.9%

\*Media/Library size guidelines = 2020sf for enrollments up to 300 students and 4.5sf for each student over 300

Dining & Food Service	Min. Size (sf) Guidelines*	Existing Size (sf)	Adjust (sf)* per Lunches	Count of Spaces	Lunch Periods	Design Enroll.	Enrollment Supported	Functional Utilization
Cafeteria	2250	648	1500	2	3	300	259	91.1%
			1125	2	4		345	68.3%
			900	2	5		432	54.7%
			750	2	6		518	45.6%
Kitchen	1460	220	n/a	1	n/a			

\*Cafeteria size guidelines = 15sf per student enrollment divided by lunch periods. Guidelines default to 2 periods

## Classroom Size (sf) vs Guidelines

Kindergarten

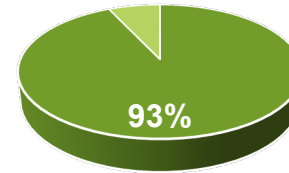

Grade 1-5 Classrooms



94% (842 of 900sf)  
2 Modulars at 830sf

## Shared Spaces & Missing Spaces

vs NPS Educational Program (at 18 Classrooms)

- (5) Special Educ, SEL, (2) ELL & (1) Math share 2 Rooms
- (2) OT with (2) Speech
- Music Uses the Stage
- Break-Out Space per Grade
- Separate OT/PT Office
- Art Workroom/Storage
- Music Practice
- Gym Office/Storage

## Other Spaces

- + District-Wide Sp.Ed Rms
- + Auditorium

- Chair/Table Storage
- Copy & Storage (in corridors)
- Conference Room
- Nursing (Lactation Room)

# Educational Space Assessment

## Williams

Core Academic Spaces	Min. Size (sf) Guidelines*	Existing Avg. (sf)	Size (sf) vs Guidelines*	Count of Spaces	FY 2024 Enrollment	Class Size Avg. (stu's)	Design Enrollment (Seats)**	CR Seat Utilization
Kindergarten	1100	1173	107%	2	26	13	44	59.1%
1-2 Classrooms	900	840	93%	4	76	19	88	85.9%
3-5 Classrooms			93%	6	113	19	144	78.8%
<b>Subtotals</b>				<b>12</b>	<b>215</b>		<b>276</b>	<b>77.9%</b>

\*Minimum room sizes per NPS Educ-Program \*\*Seats based on class size targets (22 stu/room K-2, 24 stu/room 3-5)

Related Arts Spaces	Min. Size (sf) Guidelines*	Existing Size (sf)	Size (sf) vs Guidelines*	Count of Spaces	Classes/Week	Minutes/Class	Avail. Time Slots/Wk	Functional Utilization
Art	1000	1020	102%	1	12	55	30	40.0%
Music (stage)	1200	610	51%	1	12	30	50	24.0%
Gym Stations	3000	2885	96%	1	24	30	50	48.0%
Media/Library	2020	1800	89%	1	12	35	45	26.7%

\*Media/Library size guidelines = 2020sf for enrollments up to 300 students and 4.5sf for each student over 300

Dining & Food Service	Min. Size (sf) Guidelines*	Existing Size (sf)	Adjust (sf)* per Lunches	Count of Spaces	Lunch Periods	Design Enroll.	Enrollment Supported	Functional Utilization
Cafeteria	2070	1025	1380	1	3	276	205	104.9%
			1035	1	4		273	78.7%
			828	1	5		342	62.9%
			690	1	6		410	52.4%
Kitchen	1460	355	n/a	1	n/a			

\*Cafeteria size guidelines = 15sf per student enrollment divided by lunch periods. Guidelines default to 2 periods

## Classroom Size (sf) vs Guidelines

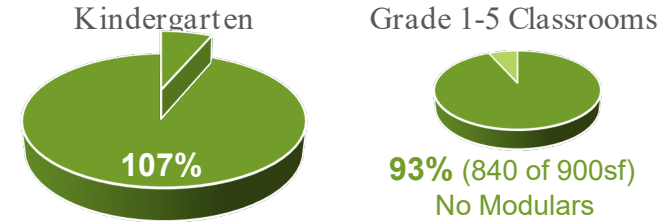

## Shared Spaces & Missing Spaces

vs NPS Educational Program (at 18 Classrooms)

- (6) Lit/Math in 1 Room
- (2) ELL in 1 Room
- 1m Specialist in Sp. Ed
- (2) OT with (3) Speech
- Metco/Soc-Work Share
- Music Uses the Stage
- Break-Out Space per Grade
- Separate OT/PT Office
- Art Workroom/Storage
- Music Practice
- Gym Office within Storage
- Chair/Table Storage
- Copy Room (in corridors)
- Conference Room
- Nursing (Lactation Room)

## Other Spaces

- + District-Wide Sp.Ed. CR
- + Auditorium
- + ASP Specific Room

# Appendix – Space Summaries & Existing Floor Plans





# Existing Spaces vs Edu Program

NEWTON PUBLIC SCHOOLS				BOWEN				BURR				MASON-RICE				MEMORIAL-SPAULDING				PEIRCE				WILLIAMS				NPS EDUCATIONAL PROGRAM (14 CRs = 306-322 Students)				NPS EDUCATIONAL PROGRAM (18 CRs = 396-414 Students)																
ROOM TYPE	ROOM NFA <sup>1</sup>	# OF ROOMS	AREA TOTALS	ROOM NFA <sup>1</sup>	# OF ROOMS	AREA TOTALS	ROOM NFA <sup>1</sup>	# OF ROOMS	AREA TOTALS	ROOM NFA <sup>1</sup>	# OF ROOMS	AREA TOTALS	ROOM NFA <sup>1</sup>	# OF ROOMS	AREA TOTALS	ROOM NFA <sup>1</sup>	# OF ROOMS	AREA TOTALS	ROOM NFA <sup>1</sup>	# OF ROOMS	AREA TOTALS	ROOM NFA <sup>1</sup>	# OF ROOMS	AREA TOTALS	ROOM NFA <sup>1</sup>	# OF ROOMS	AREA TOTALS	ROOM NFA <sup>1</sup>	# OF ROOMS	AREA TOTALS	ROOM NFA <sup>1</sup>	# OF ROOMS	AREA TOTALS															
<b>CORE ACADEMIC</b>	<b>18</b>			<b>17,600</b>			<b>18</b>			<b>18,730</b>			<b>18</b>			<b>17,470</b>			<b>19</b>			<b>18,955</b>			<b>13</b>			<b>11,555</b>			<b>12</b>			<b>11,410</b>			<b>14</b>			<b>14,725</b>			<b>18</b>			<b>18,525</b>		
Kindergarten Classroom	850	3	2,550	1,005	1	1,005	1,148	2	2,295	882	3	2,645	1,137	3	3,410	1,023	2	2,045	1,173	2	2,345	1,100	3	3,300	1,100	4	4,400	900	11	9,900	900	14	12,600	900	14	12,600	900	14	12,600									
<b>Modular Kindergarten Classrooms</b>																																																
General Classroom (Grades 1-6)	886	12	10,630	994	15	14,915	906	12	10,870	862	16	13,795	842	9	7,580	840	10	8,395	840	10	8,395	900	11	9,900	900	14	12,600	900	14	12,600	900	14	12,600	900	14	12,600	900	14	12,600									
<b>Modular General Classrooms</b>	<b>883</b>			<b>3</b>			<b>2,650</b>			<b>890</b>			<b>3</b>			<b>2,670</b>			<b>830</b>			<b>2</b>			<b>1,660</b>																							
Science/Techn/Engineering (STE) Room (Gr. 3-6)			0			0			0			0			0			0			0			0		0			0		0		0		0		0		0									
STE Storage Room (if applicable)			0			0			0			0			0			0			0			0		0			0		0		0		0		0		0									
ELL (in modular at Bowen)	890	1	890	(2) within Sp. Ed. Teaching			90	1	90	920	1	920	(2) within Sp. Ed. Teaching			295	1	295	375	1	375	300	1	300	300	1	300	300	1	300	300	1	300	300	1	300												
Literacy Center / Books	880	1	880	335	1	335	875	1	875	830	1	830	270	1	270	375	1	375	900	1	900	900	1	900	900	1	900	900	1	900	900	1	900	900	1	900												
Literacy Specialist				(1) within Literacy Center			235	1	235	(6) within Lit Ctr, (1) within ELL			(1) within Literacy Center			175	1	175	175	1	175	175	1	175	175	1	175	175	1	175	175	1	175	175	1	175												
Math Coach				180	1	180	85	1	85	(2) within ELL Room			(1) within Learning Center			150	1	150	150	1	150	150	1	150	150	1	150	150	1	150	150	1	150	150	1	150												
<b>SPECIAL EDUCATION</b>	<b>3,845</b>			<b>2,135</b>			<b>2,785</b>			<b>4,940</b>			<b>3,020</b>			<b>2,390</b>			<b>3,650</b>			<b>2,225</b>			<b>4</b>			<b>900</b>			<b>225</b>			<b>4</b>			<b>900</b>											
Special Education Teaching	645	1	645	940	1	940	925	2	1,850	1,023	2	2,045	840	1	840	590	1	590	225	4	900	225	4	900	225	4	900	225	4	900	225	4	900	225	4	900												
Break-Out/Small Group			0	315	1	315	315	1	315	340	1	340	320	1	320	190	0	0	190	0	0	190	0	0	190	0	0	190	0	0	190	0	0	190	0	0	190	0	0									
OT/PT			0	300	1	300	65	1	65	305	2	610	110	1	110	100	1	100	125	6	750	125	6	750	125	6	750	125	6	750	125	6	750	125	6	750												
OT/PT Office			0	(1) within Sp. Ed. Teaching			435	1	435	330	1	330	(3) in Corridors			100	1	100	425	1	425	425	1	425	425	1	425	425	1	425	425	1	425	425	1	425												
Quiet	65	1	65	50	1	50	120	1	120	75	1	75	50	2	100	60	1	60	175	1	175	175	1	175	175	1	175	175	1	175	175	1	175	175	1	175												
Speech and Language	860	1	860	50	2	100	(2) within OT/PT			185	1	185	(2) within OT/PT			235	1	235	100	3	300	100	3	300	100	3	300	100	3	300	100	3	300	100	3	300												
Team Specialist + IEP Conference	150	1	150	90	1	90	60	1	60	225	1	225	100	1	100	400	1	400	250	1	250	250	1	250	250	1	250	250	1	250	250	1	250															
Psychologist (incl testing/storage)	165	1	165	170	1	170	135	1	135	870	1	870	175	1	175	150	1	150	400	1	400	400	1	400	400	1	400	400	1	400	400	1	400															
Psych - Play to Learn			0	120	1	120	120	1	120	260	1	260	(1) Soc within Psych Off			150	1	150	150	1	150	150	1	150	150	1	150	150	1	150	150	1	150															
Social Worker	130	1	130	170	1	170	(1) within OT/PT			(1) within Sp. Ed. Teaching			(1) within Sp. Ed. Teaching			150	1	150	150	1	150	150	1	150	150	1	150	150	1	150	150	1	150															
Behavioral / BCBA	55	1	55	(1) within Sp. Ed. Teaching									within BRIDGE 3-5			150	1	150	150	1	150	150	1	150	150	1	150	150	1	150	150	1	150															
Bridge Program Classroom (K-2 & 3-5)			0			0			0			640	2	1,280	0		0	0	0	0	0	0	0	0	0	0	0	0	0	0	0	0	0	0	0	0												
Bridge Program Storage			0			0			0			95	1	95	0		0	0	0	0	0	0	0	0	0	0	0	0	0	0	0	0	0	0	0	0												
Reflections Program (K-2)			0			0			0					0		910	1	910	910	1	910	910	1	910	910	1	910	910	1	910	910	1	910	910	1	910												
STRIDE Program (K & 1-3)	888	2	1,775			0			0					0				0		0																												
<b>ART &amp; MUSIC</b>	<b>1,150</b>			<b>1,900</b>			<b>2,175</b>			<b>2,235</b>			<b>865</b>			<b>1,020</b>			<b>2,500</b>			<b>1,000</b>			<b>1,000</b>			<b>1,000</b>			<b>1,000</b>			<b>1,000</b>														
Art Classroom (25 seats)	1,150	1	1,150	875	1	875	1,195	1	1,195	1,360	1	1,360	865	1	865	1,020	1	1,020	1,000	1	1,000	1,000	1	1,000	1,000	1	1,000	1,000	1	1,000	1,000	1	1,000															
Art Workroom with Storage and Kiln			0			0			0			93	2	185			0		150	1	150	150	1	150	150	1	150	150	1	150	150	1	150															
Music Classroom (modular at Mason-Rice)			0	1,025	1	1,025	980	1	980	Uses Auditorium/Stage			Uses Auditorium/Stage			1,200	1	1,200	1,200	1	1,200	1,200	1	1,200	1,200	1	1,200	1,200	1	1,200	1,200	1	1,200															
Music Practice / Ensemble			0			0			0			690	1	690	Uses Auditorium/Stage			0		0																												
<b>HEALTH &amp; PHYSICAL EDUCATION</b>	<b>2,970</b>			<b>4,410</b>			<b>2,370</b>			<b>2,815</b>			<b>2,015</b>			<b>3,230</b>			<b>6,300</b>			<b>6,000</b>			<b>6,000</b>			<b>6,000</b>			<b>6,000</b>																	
Gymnasium	2,790	1	2,790	3,865	1	3,865	2,360	1	2,360	2,430	1	2,430	2,015	1	2,015	2,885	1	2,885	6,000	1	6,000	6,000	1	6,000	6,000	1	6,000	6,000	1	6,000																		
Gym Storeroom	90	1	90	375	1	375	10	1	10	325	1	325			0	345	1	345	200	1	200	200	1	200	200	1	200	200	1	200																		
Health Instructor's Office with Shower and Toilet	90	1	170	170	1	170	60	1	60	60	1	60			0	within Store Room			100	1	100	100	1	100	100	1	100	100	1	100																		
<b>MEDIA CENTER / LIBRARY</b>	<b>1,525</b>			<b>1,240</b>			<b>1,200</b>			<b>2,545</b>			<b>990</b>			<b>1,800</b>			<b>2,047</b>			<b>2,047</b>			<b>2,452</b>			<b>2,452</b>																				
Media Center / Reading Room	1,525	1	1,525	1,240	1	1,240	1,200	1	1,200	2,545	1	2,545	990	1	990	1,800	1	1,800	2,047	1	2,047	2,452	1	2,452	2,452	1	2,452	2,452	1	2,452																		



# Existing Spaces vs Educational Program

NEWTON PUBLIC SCHOOLS				BOWEN				BURR				MASON-RICE				MEMORIAL-SPAULDING				PEIRCE				WILLIAMS				NPS EDUCATIONAL PROGRAM (14 CRs = 306-322 Students)				NPS EDUCATIONAL PROGRAM (18 CRs = 396-414 Students)			
ROOM TYPE	ROOM NFA <sup>1</sup>	# OF ROOMS	AREA TOTALS	ROOM NFA <sup>1</sup>	# OF ROOMS	AREA TOTALS	ROOM NFA <sup>1</sup>	# OF ROOMS	AREA TOTALS	ROOM NFA <sup>1</sup>	# OF ROOMS	AREA TOTALS	ROOM NFA <sup>1</sup>	# OF ROOMS	AREA TOTALS	ROOM NFA <sup>1</sup>	# OF ROOMS	AREA TOTALS	ROOM NFA <sup>1</sup>	# OF ROOMS	AREA TOTALS	ROOM NFA <sup>1</sup>	# OF ROOMS	AREA TOTALS	ROOM NFA <sup>1</sup>	# OF ROOMS	AREA TOTALS	ROOM NFA <sup>1</sup>	# OF ROOMS	AREA TOTALS	ROOM NFA <sup>1</sup>	# OF ROOMS	AREA TOTALS		
<b>DINING &amp; FOOD SERVICE</b>			<b>2,020</b>			<b>4,335</b>			<b>1,035</b>			<b>1,935</b>			<b>1,775</b>			<b>1,625</b>			<b>5,257</b>			<b>5,962</b>			<b>2,295</b>			<b>2,970</b>			<b>1,000</b>		
Cafeteria / Dining	1,090	1	1,090	3,685	1	3,685				1,105	1	1,105	648	2	1,295	1,025	1	1,025	2,295	1	2,295	2,970	1	2,970	1,000	1	1,000	1,000	1	1,000	1	1,000			
Stage			0			0			0			0			0			0			0			0		0			0			0			
Chair / Table / Equipment Storage			0			0			0			0			0			0			0			0		0			0			0			
Kitchen	330	1	330	310	1	310	425	1	425	300	1	300	220	1	220	355	1	355	1,460	1	1,460	1,460	1	1,460	1,460	1	1,460	1,460	1	1,460	1,460	1	1,460		
Staff Lunch Room	600	1	600	340	1	340	610	1	610	530	1	530	260	1	260	245	1	245	200	1	200	200	1	200	200	1	200	200	1	200	200	1	200		
<b>MEDICAL</b>			<b>300</b>			<b>165</b>			<b>200</b>			<b>130</b>			<b>170</b>			<b>100</b>			<b>410</b>			<b>60</b>			<b>60</b>			<b>60</b>			<b>60</b>		
Medical Suite Toilet	40	1	40			0			0			0	25	1	25	100	1	100	60	1	60	60	1	60	60	1	60	60	1	60	60	1	60		
Nurses' Office / Waiting Room	260	1	260	165	1	165	200	1	200	130	1	130	145	1	145	250	1	250	250	1	250	250	1	250	250	1	250	250	1	250	250	1	250		
Examination Room / Resting			0			0			0			0			0	100	1	100	100	1	100	100	1	100	100	1	100	100	1	100	100	1	100		
<b>ADMINISTRATION &amp; GUIDANCE</b>			<b>1,420</b>			<b>1,370</b>			<b>1,350</b>			<b>560</b>			<b>610</b>			<b>1,725</b>			<b>2,080</b>			<b>2,080</b>			<b>650</b>			<b>650</b>			<b>650</b>		
General Office / Waiting Room with Toilet	325	1	325	510	1	510	285	1	285	260	1	260	220	1	220	310	1	310	650	1	650	650	1	650	650	1	650	650	1	650	650	1	650		
Teachers' Mail and Time Room			0			0			0			0	190	1	190			0			0		0		0										
Copy Room	190	1	190			0			0			0			0			0			0		0		0										
Records Room			0			0			0			0			0			0			0		0		0										
Principal's Office with Conference Area	400	1	400	350	1	350	150	1	150	300	1	300	200	1	200	370	1	370	80	1	80	80	1	80	80	1	80	80	1	80	80	1	80		
Principal's Secretary / Waiting			0			0			0			0			0			0			0		0		0										
Assistant Principal's Office			0			0			0			0			0			0			0		0		0										
Supervisory / Spare Office (ASP)			0			0			0			0			0			0			0		0		0										
Conference Room			0	255	2	510			0			0			0			0			0		0		0										
Guidance Office			0			0			0			0			0			0			0		0		0										
Guidance Storeroom			0			0			0			0			0			0			0		0		0										
Teachers' Work Room			0			0			0			0			0			0			0		0		0										
METCO	125	1	125			0			0			0			0			0			0		0		0										
SEL Coach / Intervention (can share space)	190	2	380			0			0			0			0			0			0		0		0										
Wellness / Nursing Room			0			0			0			0			0			0			0		0		0										
<b>CUSTODIAL &amp; MAINTENANCE</b>			<b>2,440</b>			<b>2,645</b>			<b>930</b>			<b>3,560</b>			<b>225</b>			<b>2,625</b>			<b>1,750</b>			<b>1,750</b>			<b>100</b>			<b>100</b>			<b>100</b>		
Custodian's Office	170	1	170	165	1	165	145	1	145	205	1	205	135	1	135	100	1	100	100	1	100	100	1	100	100	1	100	100	1	100	100	1	100		
Custodian's Workshop			0			0			0			0			0			0			0		0		0										
Custodian's Storage	27	6	160	80	2	60	65	2	130	57	5	285	90	1	90	55	3	165	500	1	500	500	1	500	500	1	500	500	1	500	500	1	500		
Recycling Room / Trash			0			0			0			0			0			0			0		0		0										
Receiving and General Supply			0			0			0			0			0			0			0		0		0										
Storeroom			0			0			0			0			0			0			0		0		0										
Network / Telecom Room	260	1	260			0			0			0			0			0			0		0		0										
Misc. Storage Rooms	206	9	1,850	403	6	2,420	64	4	255	598	5	2,990			0			75	1	75	250	1	250	250	1	250	250	1	250	250	1	250			
<b>OTHER</b>			<b>4,525</b>			<b>2,155</b>			<b>4,095</b>			<b>3,720</b>			<b>2,820</b>			<b>3,395</b>			<b>1,250</b>			<b>1,250</b>			<b>1,000</b>			<b>1,000</b>			<b>1,000</b>		
Auditorium	2,400	1	2,400			0			0			0			0			0			0		0		0										
Stage	725	1	725			0			0			0			0			0			0		0		0										
After School Program (ASP)/Office	700	2	1,400	105	1	105	1,480	1	1,480	705	1	705	620	1	620	610	1	610	1,000	1	1,000	1,000	1	1,000	1,000	1	1,000	1,000	1	1,000	1,000	1	1,000		
ASP Storage			0			0			0			0			0			0			0		0		0										
Assoc Dir of Elem Educ			0			0			0			0			0			0			0		0		0										
District Storage			0	1,025	2	2,050			0			0			0			0			0		0		0										
Total Building Net Floor Area (NFA)			<b>37,795</b>			<b>39,085</b>			<b>33,610</b>			<b>41,395</b>			<b>24,045</b>			<b>29,320</b>			<b>39,969</b>			<b>44,879</b>			<b>1,000</b>			<b>396</b>			<b>396</b>		
Enrollment			<b>355</b>			<b>355</b>			<b>369</b>			<b>369</b>			<b>215</b>			<b>215</b>			<b>306</b>			<b>306</b>			<b>1,000</b>			<b>1,000</b>			<b>1,000</b>		
Total Building Gross Floor Area (GFA) <sup>2</sup>			<b>61,430</b>			<b>53,060</b>			<b>50,440</b>			<b>64,475</b>			<b>38,110</b>			<b>44,880</b>			<b>59,913</b>			<b>67,318</b>			<b>1,000</b>			<b>396</b>			<b>396</b>		
Grossing Factor (GFA / NFA)			<b>1.63</b>			<b>1.36</b>			<b>1.50</b>			<b>1.56</b>			<b>1.58</b>			<b>1.53</b>			<b>1.50</b>			<b>1.50</b>			<b>1.00</b>			<b>1.00</b>			<b>1.00</b>		



# Existing Spaces

## Burr – Upper Floor

- General Education Classroom
- General Education Support Spaces
- Special Education
- Music, Arts & Phys Ed
- Media Center/Library
- Dining & Food Service
- Admin & Guidance
- Extended Day
- Cust, Maint, & Toilets
- Circulation, Stair, Lift

- ASP – AFTER SCHOOL PROGRAM
- BCBA – BEHAVIOR ANALYST
- B.O. – BREAK-OUT / SMALL GROUP
- C / CUST – CUSTODIAL
- CAF – CAFETERIA
- CR – CLASSROOM
- ELL – ENGLISH LANGUAGE LEARNER
- K – KINDERGARTEN
- LIT – LITERACY
- MECH/MDF – MECHANICAL/ELECTRICAL
- O / OFF – OFFICE
- OT – OCCUPATIONAL THERAPY
- PSY – PSYCHOLOGIST
- S / STOR – STORAGE
- SEL – SOCIAL-EMOTIONAL LEARNING
- SP.ED.TCH – SPECIAL EDUCATION TEACHING
- SPCH – SPEECH & LANGUAGE
- SW / SOC – SOCIAL WORKER
- T – TOILET
- TM – TEAM SPECIALIST

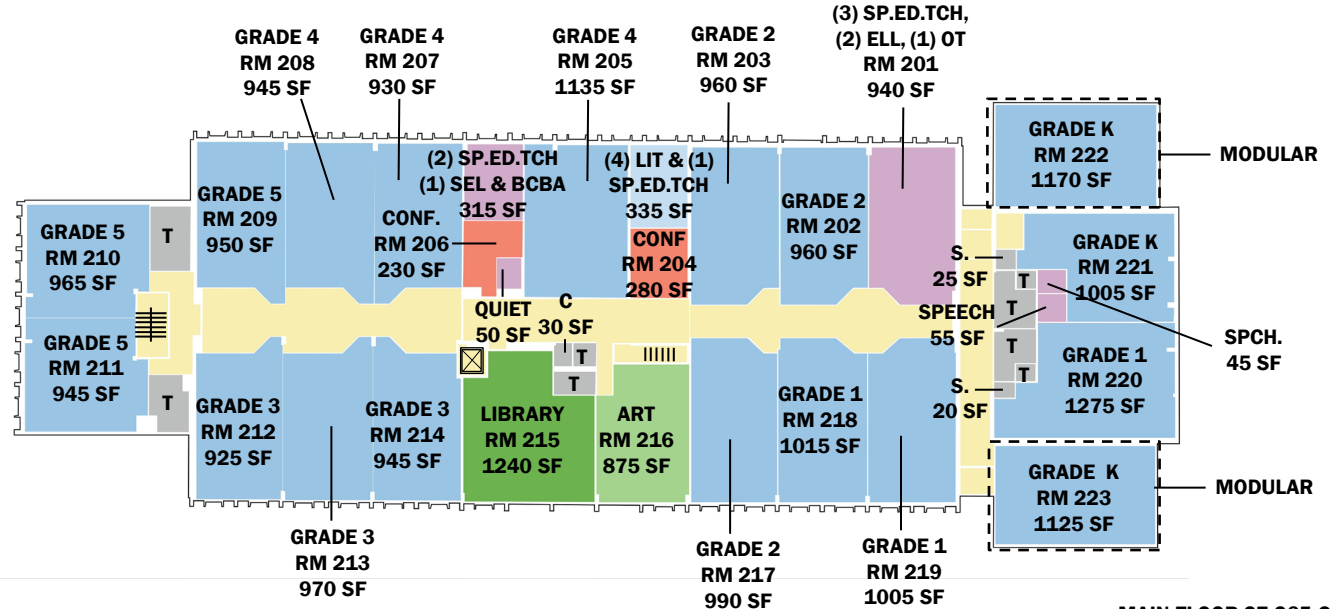

**MAIN FLOOR 27,265 GSF**  
**MODULARS 2,475 GSF**  
**UPPER FLOOR 23,320 GSF**  
**53,060 GSF**

# Existing Spaces

## Mason Rice – Lower Floor

- General Education Classroom
- General Education Support Spaces
- Special Education
- Music, Arts & Phys Ed
- Media Center/Library
- Dining & Food Service
- Admin & Guidance
- Extended Day
- Cust, Maint, & Toilets
- Circulation, Stair, Lift

- ASP – AFTER SCHOOL PROGRAM
- BCBA – BEHAVIOR ANALYST
- B.O. – BREAK-OUT / SMALL GROUP
- C / CUST – CUSTODIAL
- CAF – CAFETERIA
- CR – CLASSROOM
- ELL – ENGLISH LANGUAGE LEARNER
- K – KINDERGARTEN
- LIT – LITERACY
- MECH/MDF – MECHANICAL/ELECTRICAL
- O / OFF – OFFICE
- OT – OCCUPATIONAL THERAPY
- PSY – PSYCHOLOGIST
- S / STOR – STORAGE
- SEL – SOCIAL-EMOTIONAL LEARNING
- SP.ED.TCH – SPECIAL EDUCATION TEACHING
- SPCH – SPEECH & LANGUAGE
- SW / SOC – SOCIAL WORKER
- T – TOILET
- TM – TEAM SPECIALIST

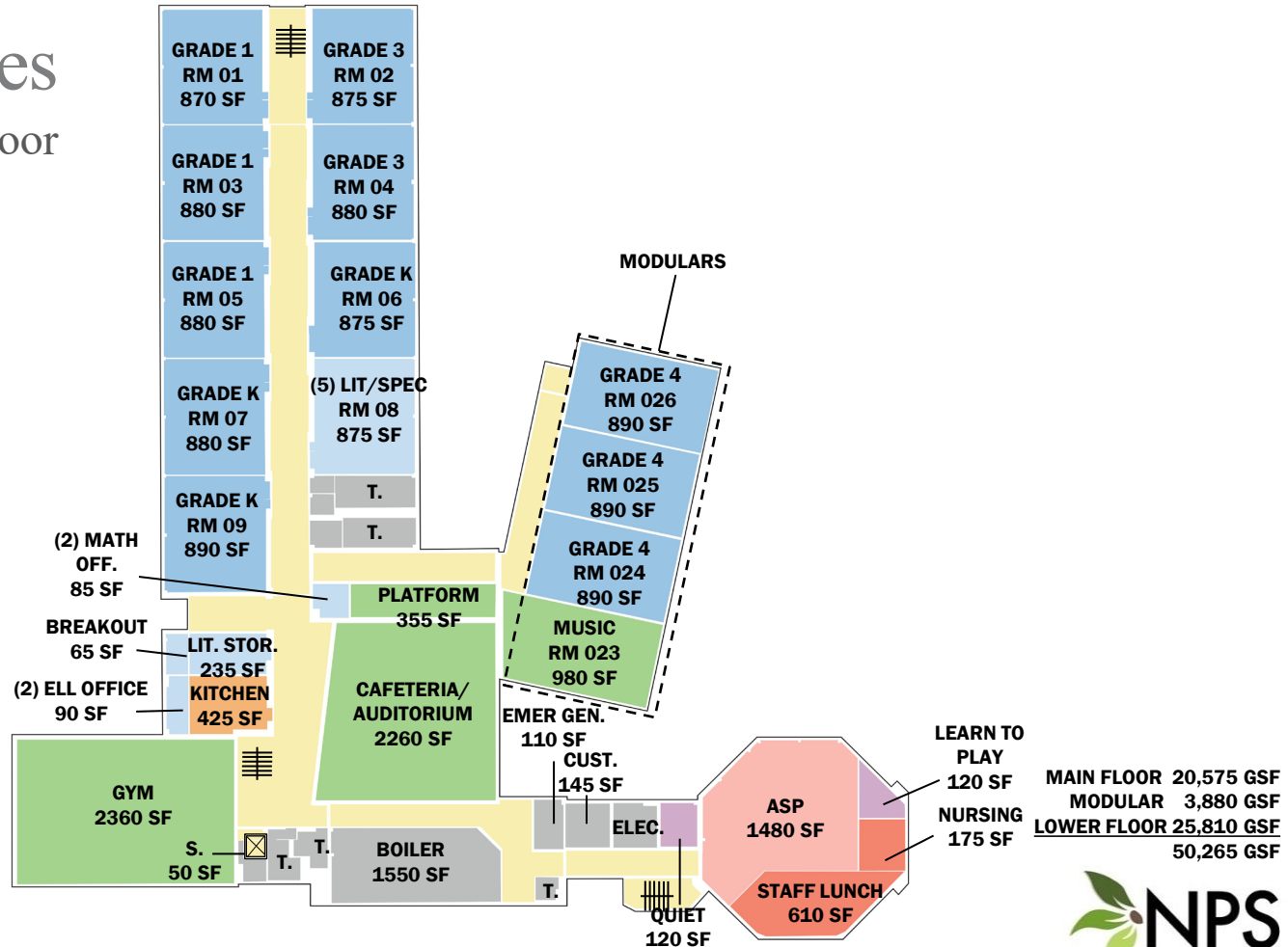

# Existing Spaces

## Mason Rice – Main Floor

- General Education Classroom
- General Education Support Spaces
- Special Education
- Music, Arts & Phys Ed
- Media Center/Library
- Dining & Food Service
- Admin & Guidance
- Extended Day
- Cust, Maint, & Toilets
- Circulation, Stair, Lift

- ASP – AFTER SCHOOL PROGRAM
- BCBA – BEHAVIOR ANALYST
- B.O. – BREAK-OUT / SMALL GROUP
- C / CUST – CUSTODIAL
- CAF – CAFETERIA
- CR – CLASSROOM
- ELL – ENGLISH LANGUAGE LEARNER
- K – KINDERGARTEN
- LIT – LITERACY
- MECH/MDF – MECHANICAL/ELECTRICAL
- O / OFF – OFFICE
- OT – OCCUPATIONAL THERAPY
- PSY – PSYCHOLOGIST
- S / STOR – STORAGE
- SEL – SOCIAL-EMOTIONAL LEARNING
- SP.ED.TCH – SPECIAL EDUCATION TEACHING
- SPCH – SPEECH & LANGUAGE
- SW / SOC – SOCIAL WORKER
- T – TOILET
- TM – TEAM SPECIALIST

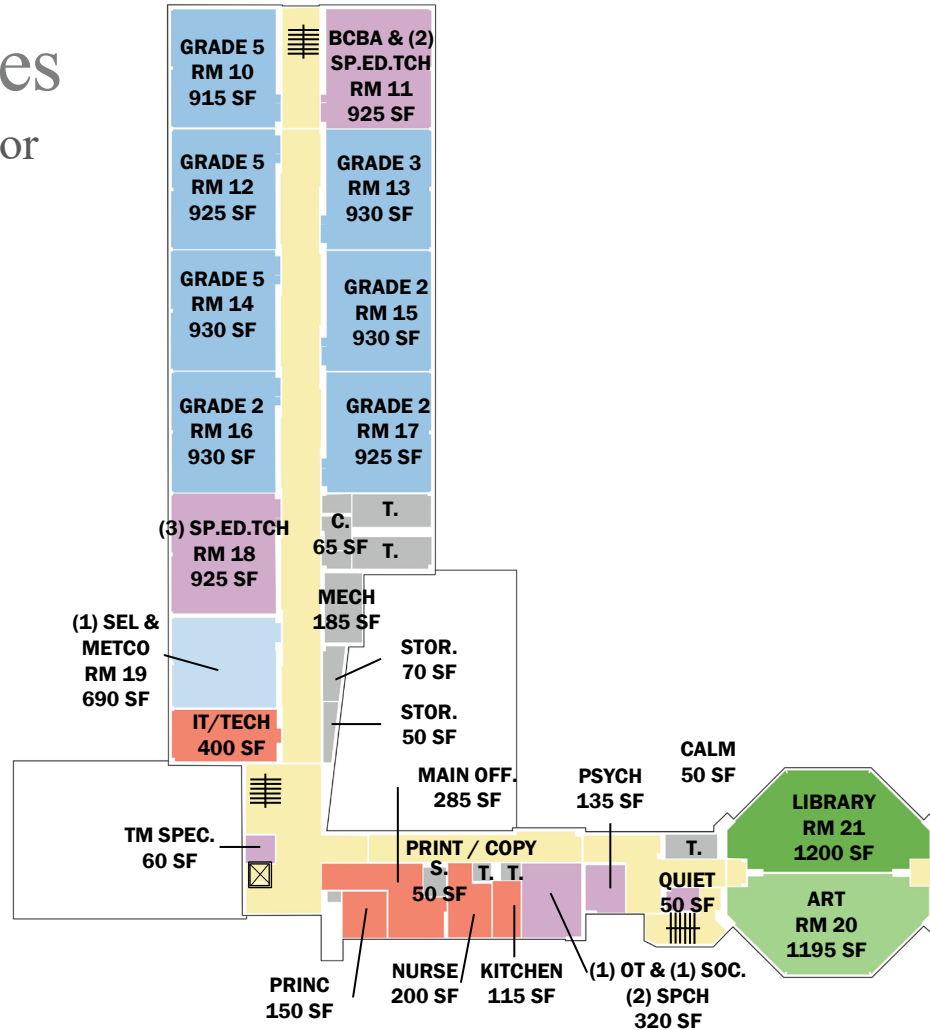

**MAIN FLOOR 20,750 GSF**  
**MODULAR 3,880 GSF**  
**LOWER FLOOR 25,810 GSF**  
**50,440 GSF**

# Existing Spaces

## Memorial-Spaulding – Lower Floor

- General Education Classroom
- General Education Support Spaces
- Special Education
- Music, Arts & Phys Ed
- Media Center/Library
- Dining & Food Service
- Admin & Guidance
- Extended Day
- Cust, Maint, & Toilets
- Circulation, Stair, Lift

- ASP – AFTER SCHOOL PROGRAM
- BCBA – BEHAVIOR ANALYST
- B.O. – BREAK-OUT / SMALL GROUP
- C / CUST – CUSTODIAL
- CAF – CAFETERIA
- CR – CLASSROOM
- ELL – ENGLISH LANGUAGE LEARNER
- K – KINDERGARTEN
- LIT – LITERACY
- MECH/MDF – MECHANICAL/ELECTRICAL
- O / OFF – OFFICE
- OT – OCCUPATIONAL THERAPY
- PSY – PSYCHOLOGIST
- S / STOR – STORAGE
- SEL – SOCIAL-EMOTIONAL LEARNING
- SP.ED.TCH – SPECIAL EDUCATION TEACHING
- SPCH – SPEECH & LANGUAGE
- SW / SOC – SOCIAL WORKER
- T – TOILET
- TM – TEAM SPECIALIST

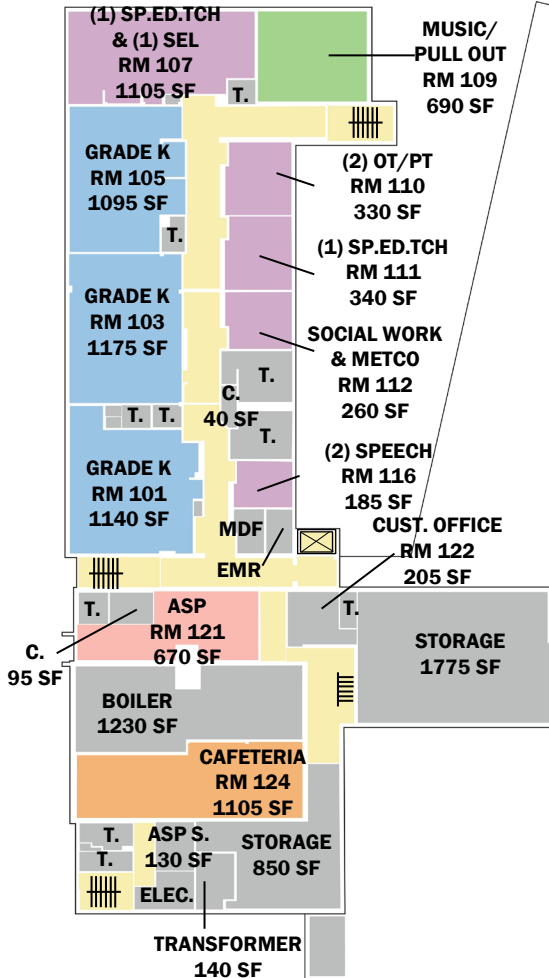

# Existing Spaces

## Memorial-Spaulding – Main Floor

- General Education Classroom
- General Education Support Spaces
- Special Education
- Music, Arts & Phys Ed
- Media Center/Library
- Dining & Food Service
- Admin & Guidance
- Extended Day
- Cust, Maint, & Toilets
- Circulation, Stair, Lift

- ASP – AFTER SCHOOL PROGRAM
- BCBA – BEHAVIOR ANALYST
- B.O. – BREAK-OUT / SMALL GROUP
- C / CUST – CUSTODIAL
- CAF – CAFETERIA
- CR – CLASSROOM
- ELL – ENGLISH LANGUAGE LEARNER
- K – KINDERGARTEN
- LIT – LITERACY
- MECH/MDF – MECHANICAL/ELECTRICAL
- O / OFF – OFFICE
- OT – OCCUPATIONAL THERAPY
- PSY – PSYCHOLOGIST
- S / STOR – STORAGE
- SEL – SOCIAL-EMOTIONAL LEARNING
- SP.ED.TCH – SPECIAL EDUCATION TEACHING
- SPCH – SPEECH & LANGUAGE
- SW / SOC – SOCIAL WORKER
- T – TOILET
- TM – TEAM SPECIALIST

**MAIN FLOOR 45,525 GSF**  
**LOWER FLOOR 18,950 GSF**  
**64,475 GSF**

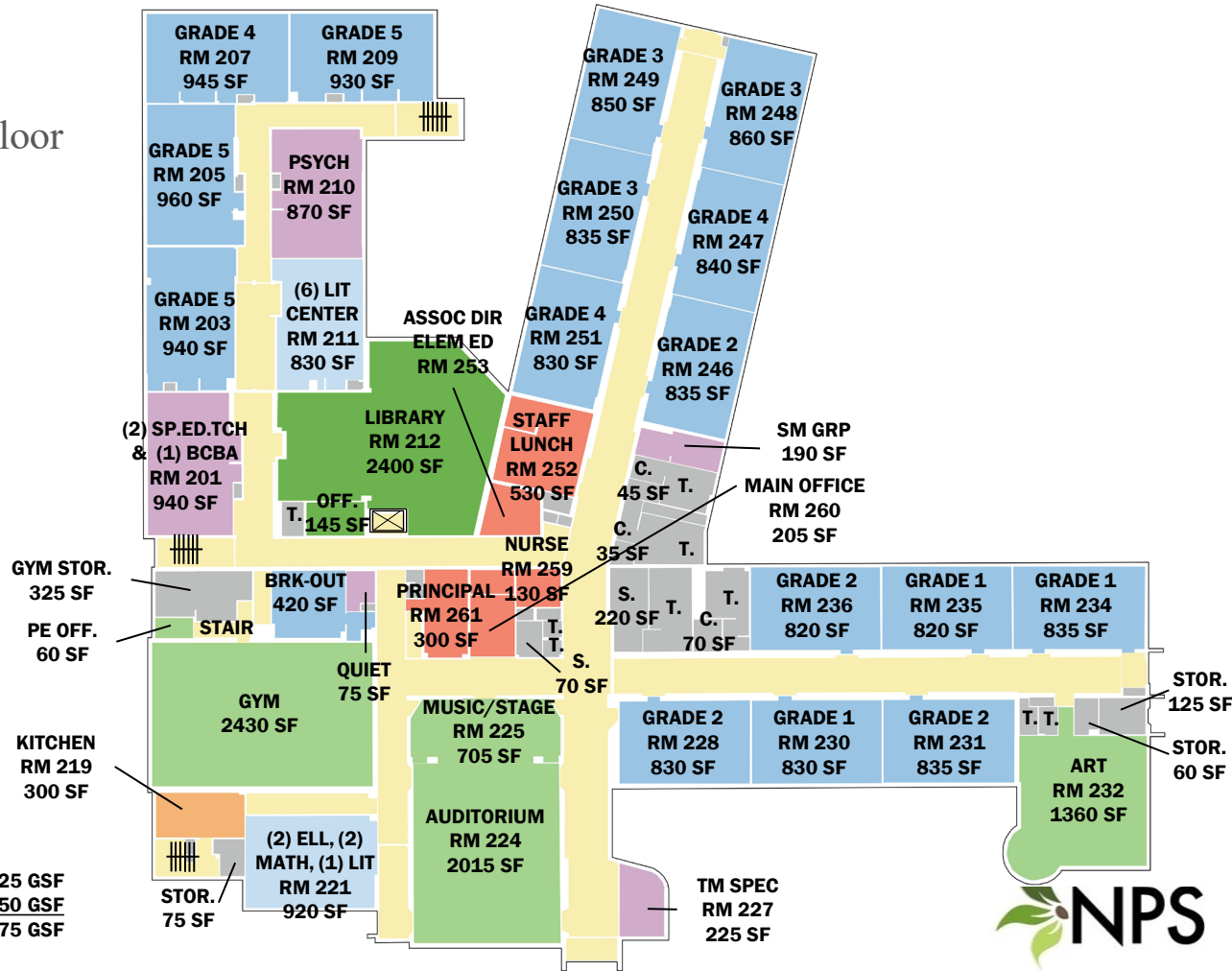

# Existing Spaces

## Peirce – Lower Floor

- General Education Classroom
- General Education Support Spaces
- Special Education
- Music, Arts & Phys Ed
- Media Center/Library
- Dining & Food Service
- Admin & Guidance
- Extended Day
- Cust, Maint, & Toilets
- Circulation, Stair, Lift

- ASP** – AFTER SCHOOL PROGRAM
- BCBA** – BEHAVIOR ANALYST
- B.O.** – BREAK-OUT / SMALL GROUP
- C / CUST** – CUSTODIAL
- CAF** – CAFETERIA
- CR** – CLASSROOM
- ELL** – ENGLISH LANGUAGE LEARNER
- K** – KINDERGARTEN
- LIT** – LITERACY
- MECH/MDF** – MECHANICAL/ELECTRICAL
- O / OFF** – OFFICE
- OT** – OCCUPATIONAL THERAPY
- PSY** – PSYCHOLOGIST
- S / STOR** – STORAGE
- SEL** – SOCIAL-EMOTIONAL LEARNING
- SP.ED.TCH** – SPECIAL EDUCATION TEACHING
- SPCH** – SPEECH & LANGUAGE
- SW / SOC** – SOCIAL WORKER
- T** – TOILET
- TM** – TEAM SPECIALIST

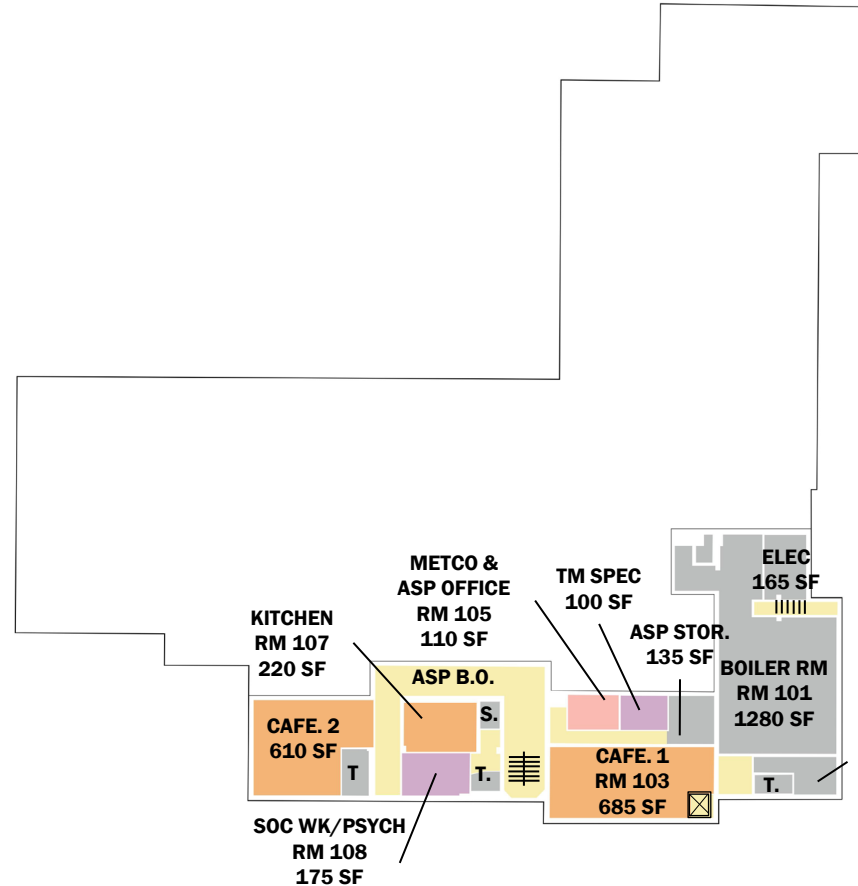

**MAIN FLOOR 30,290 GSF**  
**MODULARS 1,860 GSF**  
**LOWER FLOOR 5,960 GSF**  
**38,110 GSF**



# Existing Spaces

## Peirce – Main Floor

- General Education Classroom
- General Education Support Spaces
- Special Education
- Music, Arts & Phys Ed
- Media Center/Library
- Dining & Food Service
- Admin & Guidance
- Extended Day
- Cust, Maint, & Toilets
- Circulation, Stair, Lift

- ASP – AFTER SCHOOL PROGRAM
- BCBA – BEHAVIOR ANALYST
- B.O. – BREAK-OUT / SMALL GROUP
- C / CUST – CUSTODIAL
- CAF – CAFETERIA
- CR – CLASSROOM
- ELL – ENGLISH LANGUAGE LEARNER
- K – KINDERGARTEN
- LIT – LITERACY
- MECH/MDF – MECHANICAL/ELECTRICAL
- O / OFF – OFFICE
- OT – OCCUPATIONAL THERAPY
- PSY – PSYCHOLOGIST
- S / STOR – STORAGE
- SEL – SOCIAL-EMOTIONAL LEARNING
- SP.ED.TCH – SPECIAL EDUCATION TEACHING
- SPCH – SPEECH & LANGUAGE
- SW / SOC – SOCIAL WORKER
- T – TOILET
- TM – TEAM SPECIALIST

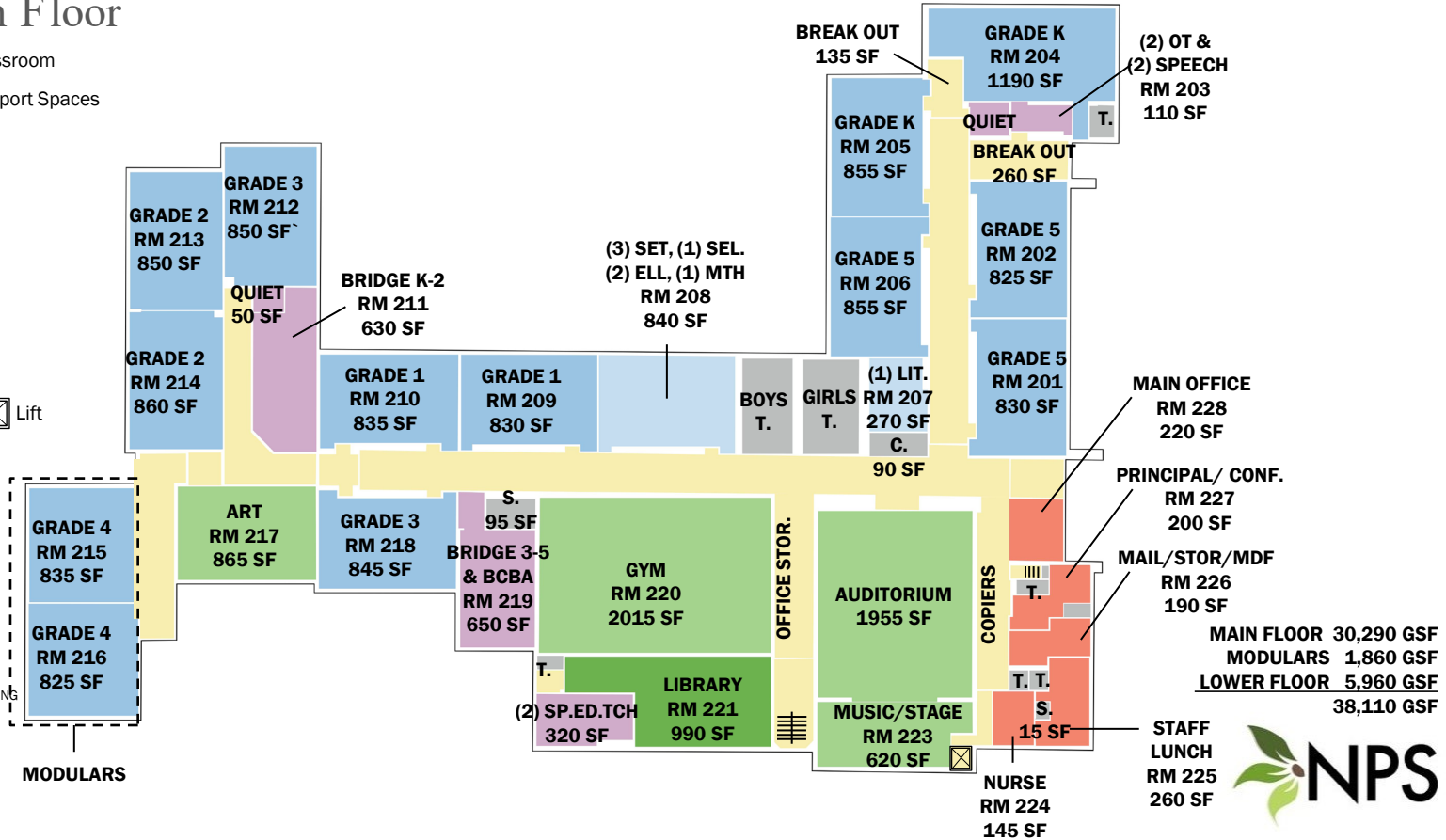

# Existing Spaces

## Williams – Lower Floor

- General Education Classroom
- General Education Support Spaces
- Special Education
- Music, Arts & Phys Ed
- Media Center/Library
- Dining & Food Service
- Admin & Guidance
- Extended Day
- Cust, Maint, & Toilets
- Circulation, Stair, Lift

- ASP** – AFTER SCHOOL PROGRAM
- BCBA** – BEHAVIOR ANALYST
- B.O.** – BREAK-OUT / SMALL GROUP
- C / CUST** – CUSTODIAL
- CAF** – CAFETERIA
- CR** – CLASSROOM
- ELL** – ENGLISH LANGUAGE LEARNER
- K** – KINDERGARTEN
- LIT** – LITERACY
- MECH/MDF** – MECHANICAL/ELECTRICAL
- O / OFF** – OFFICE
- OT** – OCCUPATIONAL THERAPY
- PSY** – PSYCHOLOGIST
- S / STOR** – STORAGE
- SEL** – SOCIAL-EMOTIONAL LEARNING
- SP.ED.TCH** – SPECIAL EDUCATION TEACHING
- SPCH** – SPEECH & LANGUAGE
- SW / SOC** – SOCIAL WORKER
- T** – TOILET
- TM** – TEAM SPECIALIST

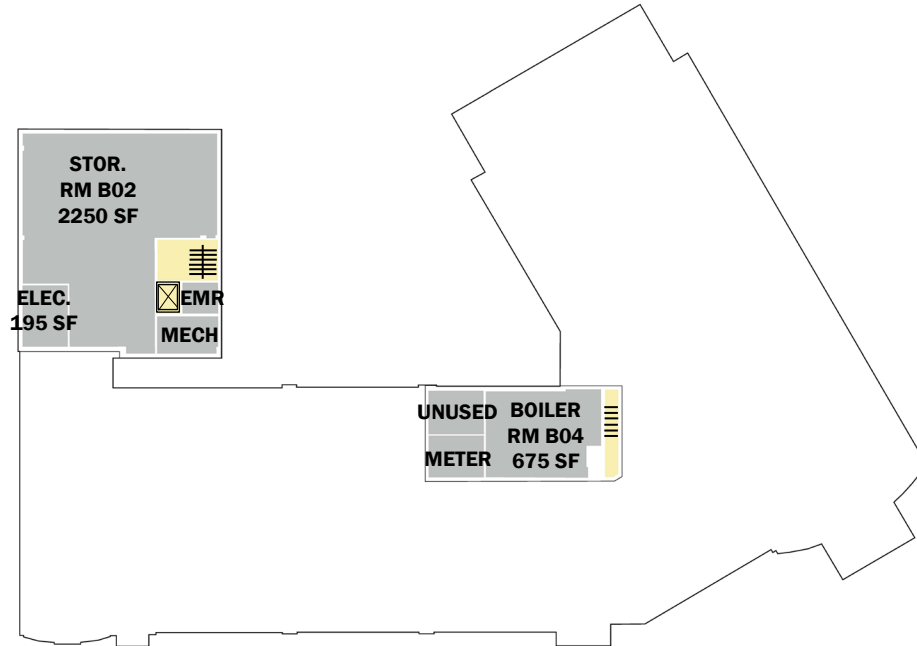

**UPPER FLOOR 16,250 GSF**  
**MAIN FLOOR 24,120 GSF**  
**LOWER FLOOR 4,610 GSF**  
**44,980 GSF**

# Existing Spaces

## Williams – Main Floor

- General Education Classroom
- General Education Support Spaces
- Special Education
- Music, Arts & Phys Ed
- Media Center/Library
- Dining & Food Service
- Admin & Guidance
- Extended Day
- Cust, Maint, & Toilets
- Circulation, Stair, Lift

- ASP – AFTER SCHOOL PROGRAM
- BCBA – BEHAVIOR ANALYST
- B.O. – BREAK-OUT / SMALL GROUP
- C / CUST – CUSTODIAL
- CAF – CAFETERIA
- CR – CLASSROOM
- ELL – ENGLISH LANGUAGE LEARNER
- K – KINDERGARTEN
- LIT – LITERACY
- MECH/MDF – MECHANICAL/ELECTRICAL
- O / OFF – OFFICE
- OT – OCCUPATIONAL THERAPY
- PSY – PSYCHOLOGIST
- S / STOR – STORAGE
- SEL – SOCIAL-EMOTIONAL LEARNING
- SP.ED.TCH – SPECIAL EDUCATION TEACHING
- SPCH – SPEECH & LANGUAGE
- SW / SOC – SOCIAL WORKER
- T – TOILET
- TM – TEAM SPECIALIST

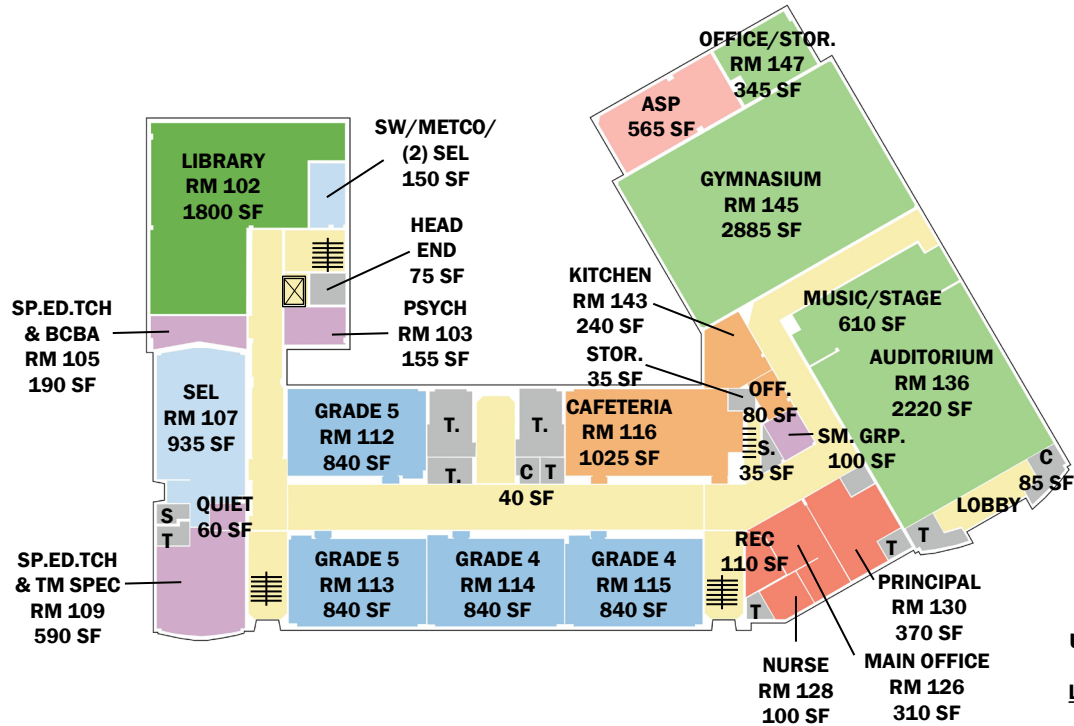

UPPER FLOOR 16,250 GSF  
 MAIN FLOOR 24,120 GSF  
 LOWER FLOOR 4,610 GSF  
**44,980 GSF**

# Existing Spaces

## Williams – Upper Floor

- General Education Classroom
- General Education Support Spaces
- Special Education
- Music, Arts & Phys Ed
- Media Center/Library
- Dining & Food Service
- Admin & Guidance
- Extended Day
- Cust, Maint, & Toilets
- Circulation, Stair, Lift

- ASP – AFTER SCHOOL PROGRAM
- BCBA – BEHAVIOR ANALYST
- B.O. – BREAK-OUT / SMALL GROUP
- C / CUST – CUSTODIAL
- CAF – CAFETERIA
- CR – CLASSROOM
- ELL – ENGLISH LANGUAGE LEARNER
- K – KINDERGARTEN
- LIT – LITERACY
- MECH/MDF – MECHANICAL/ELECTRICAL
- O / OFF – OFFICE
- OT – OCCUPATIONAL THERAPY
- PSY – PSYCHOLOGIST
- S / STOR – STORAGE
- SEL – SOCIAL-EMOTIONAL LEARNING
- SP.ED.TCH – SPECIAL EDUCATION TEACHING
- SPCH – SPEECH & LANGUAGE
- SW / SOC – SOCIAL WORKER
- T – TOILET
- TM – TEAM SPECIALIST

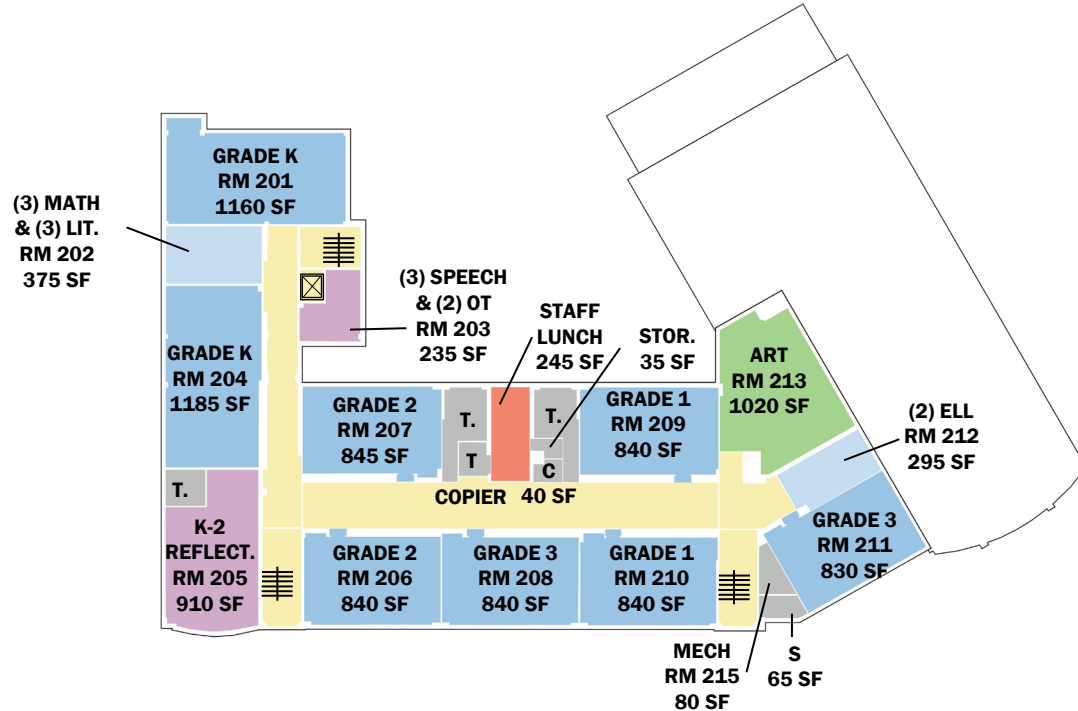

**UPPER FLOOR 16,250 GSF**  
**MAIN FLOOR 24,120 GSF**  
**LOWER FLOOR 4,610 GSF**  
**44,980 GSF**